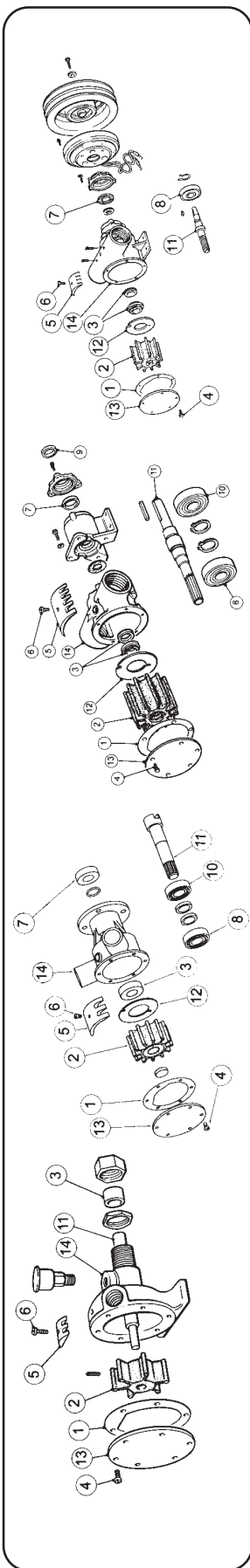

JABSCO PUMP DETAILS				SERVICE KIT DETAILS				GENERAL PARTS LISTING											
Pump Number	Original Pump Size	Port Type	Mount Type	Alternate Part No	Kit Number	Gasket/O Ring	Impeller	Water Seal	End Cover Screws	Cam	Cam Screw	Pump End Oil Seal	Pump End Bearing	Drive End Oil Seal	Drive End Bearing	Shaft	Wearplate	Endcover	Body
					Key	1	2	3	4	5	6	7	8	9	10	11	12	13	14

US

- Key No**
- Gasket
 - Impeller
 - Water seal
 - End cover screw
 - Cam
 - Cam screw
 - Pump end oil seal
 - Pump end bearing
 - Drive end oil seal
 - Drive end bearing
 - Shaft
 - Wearplate
 - Endcover
 - Body

FR

- Key No**
- Joint
 - Impulseur
 - Garniture
 - Vis de couvercle
 - Came
 - Vis de came
 - Joint a levre
 - Roulement interieur
 - Joint exterieur
 - Roulement exterieur
 - Arbre
 - Plaque d'usure
 - Couvercle
 - Corps de pompe

DE

- Key No**
- Deckeldichtung
 - Impeller
 - Wellendichtung
 - Deckel schraube
 - Exzenter
 - Exzentrerschraube
 - Lagerdichtung innen
 - Kugellager innen
 - Lagererdichtung aussen
 - Kugellager aussen
 - Welle
 - Verschleissplatte
 - Deckschraube
 - Pumpengehäuse

IT

- Key No**
- Junta
 - Impulsor
 - Sello
 - Tornillo
 - Leva
 - Tornillo de la leva
 - Sello interno cojine
 - Cojinete interno
 - Sello cojinete esterno
 - Cojinete esterno
 - Eje
 - Disco de degaste
 - Apa
 - Cuerpo de la bomba

NL

- Key No**
- Papier
 - Waaier
 - Asdichting
 - Deksel schroeven
 - Kam
 - Kam Schroef
 - Simmer ring
 - Kogellager
 - Simmer Ring
 - Kogellager
 - As
 - Slijpplaat
 - Einddeksel
 - Pomp Huis

SE

- Key No**
- Pakning
 - Impeller
 - Tätning
 - Skruv
 - Kam
 - Kamskruv
 - Lapptätning
 - Inre lager
 - Yttre lagetätning
 - Yttre lager
 - Axel
 - Slitbricka
 - Lock
 - Pumphus

ES

- Key No**
- Guarnizone
 - Girante
 - Tenuta
 - Vill coperchio
 - Camme
 - Vite camme
 - Tenuta intereno cuscine
 - Cuscinetto interno
 - Tunuta cuscinetto esterno
 - Cuscinetto esterno
 - Albero
 - Piastra d'usura
 - Coperchio
 - Corpo pomp

Service Parts - Multilingual Spares Dictionary

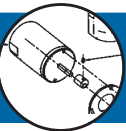

10

www.jabasco.com

JABSCO

Service Parts - Flexible Impeller Pumps Spares by Pump Model AL1/2"-200 to 2620-237

JABSCO PUMP DETAILS				SERVICE KIT DETAILS				GENERAL PARTS LISTING														
Pump Number	Origin	Pump Size	Port Type	Mount Type	Alternate Part No	Kit Number	Key	Gasket/O Ring	Impeller	Water Seal	End Cover Screws	Cam	Cam Screw	Pump End Oil Seal	Pump End Bearing	Drive End Oil Seal	Drive End Bearing	Shaft	Wearplate	Endcover	Body	
									*Data supply only													*Data supply only
AL1/2"-200	UK	010	1/4" BSP	Foot		SK1		1126	4528-0001	AL22	SP1002-01	AL8	SP1002-02	---	---	---	---	AL10	---	AL6-200	AL4-200A120	
AL1/2"-204	UK	010	1/4" BSP	Foot	x	SK1		1126	4528-0001	AL22	SP1002-01	AL8-01	SP1002-09	---	---	---	---	AL10	---	AL6-200	AL4-200	
AL1/2"-237	UK	010	1/4" BSP	Foot	x	SK1-37		1126	4528-0003	AL22	SP1002-01	AL8	SP1002-02	---	---	---	---	AL10	---	AL6-200	AL4-200	
BH/8"-200	UK	020	H/8" BSP	Foot	x	SK2		2995-0030	4527-0001	B22	SP1002-01	2907-0001	SP1002-02	---	---	---	---	B10	---	3992	B8-200	
JDH/4"-200	UK	040	H/4" BSP	Foot	x	SK220		706-01	4598-0001	C20	SP1003-02	934	SP1004-01	---	---	---	---	D10-01	---	D6-01-200	JD4-200	
JDH/4"-201	UK	040	H/4" BSP	Foot	x	SK220		706-01	4598-0001	3791	SP1003-02	934	SP1004-01	---	---	---	---	D10-01	---	D6-01-200	JD4-200	
JDH/4"-205	UK	040	H/4" BSP	Foot	x	SK220		706-01	4598-0001	2431	SP1003-02	2431	SP1004-09	---	---	---	---	D10-01	---	D6-01-200	JD4-200	
JDH/4"-208	UK	040	H/4" BSP	Foot	x	SK220		706-01	4598-0001	C20	SP1003-02	934	SP1004-01	---	---	---	---	D10-01	---	D6-01-200	JD4-200	
JDH/4"-237	USA	080	1" BSP	Foot	x	SK220-37		706-01	4598-0003	C20	SP1003-02	934	SP1004-01	---	---	---	---	D10-01	---	D6-01-200	JD4-200	
777-0003	USA	080	1" NPT	Foot		90010-0001		890-0000	17937-0001	92700-0060	91003-0010	934-0000	91004-0090	913-0000	92600-0540	914-0000	---	6718-0000	---	11831-0000	798-0020	
777-9001	USA	080	1" NPT	Foot		90118-0001		890-0000	17937-0001	96080-0080	91003-0010	934-0000	91004-0090	913-0000	92600-0540	914-0000	---	6718-0000	---	11831-0000	798-0020	
777-9003	USA	080	1" NPT	Foot		90118-0003		890-0000	17937-0001	96080-0080	91003-0010	934-0000	91004-0090	913-0000	92600-0540	914-0000	---	6718-0000	---	11831-0000	798-0020	
777-9004	USA	080	1" NPT	Foot		90118-0003		890-0000	17937-0001	96080-0080	91003-0010	934-0000	91004-0090	913-0000	92600-0540	914-0000	---	6718-0000	---	11831-0000	798-0020	
777-9005	USA	080	1" NPT	Foot		90118-0003		890-0000	17937-0001	96080-0080	91003-0010	934-0000	91004-0090	913-0000	92600-0540	914-0000	---	6718-0000	---	11831-0000	798-0020	
777-9011	USA	080	1" NPT	Foot		90118-0001		890-0000	17937-0001	96080-0080	91003-0010	934-0000	91004-0090	913-0000	92600-0540	914-0000	---	6718-0000	---	11831-0000	798-0020	
777-9051	USA	080	1" NPT	Foot		90118-0001		2432-0000	17937-0001	96080-0080	91003-0010	2431-0000	91004-0100	913-0000	92600-0540	914-0000	---	6718-0000	---	11831-0000	798-0020	
823-200	USA	200	1 1/4" BSP	Foot	x	SK11		816	836-0001	1814	SP1005-04			---	---	---	---		---	---	---	
823-205	USA	200	1 1/4" BSP	Foot	x	SK11		816	836-0001	1814	SP1005-04			---	---	---	---		---	---	---	
1673-0001	USA	040	1/2" NPT	Foot		90015-0001		1835-0000	1210-0001	92700-0060	91003-0010	490-0001	91003-0010	1554-0000	92600-0330	---	---	1737-0410	---	11836-0000	9094-0000	
1673-0003	USA	040	1/2" NPT	Foot		90015-0003		1835-0000	1210-0001	92700-0060	91003-0010	490-0001	91003-0010	1554-0000	92600-0330	---	---	1737-0410	---	11836-0000	9094-0000	
1673-1001	USA	040	1/2" NPT	Foot		90015-0003		18755-0133	1210-0001	92700-0060	91003-0010	490-0000	91003-0010	---	18753-0130	---	---	18753-0129	---	11836-0000	18753-0128	
1673-1003	USA	040	1/2" NPT	Foot		90015-0003		18755-0133	1210-0001	92700-0060	91003-0010	490-0000	91003-0010	---	18753-0130	---	---	18753-0129	---	11836-0000	18753-0128	
1673-2001	USA	040	1/2" NPT	Foot		90119-0001		890-0000	17937-0001	96080-0080	91003-0010	934-0000	91003-0010	---	18753-0130	---	---	18753-0129	---	11836-0000	18753-0128	
2300-9001	USA	080	1" NPT	Foot		90118-0001		890-0000	17937-0001	96080-0080	91003-0010	934-0000	91004-0090	913-1000	92600-0660	---	---	6718-0001	4156-0000	11831-0000	798-0030	
2300-9003	USA	080	1" NPT	Foot		90118-0003		890-0000	17937-0001	96080-0080	91003-0010	934-0000	91004-0090	913-0000	92600-0660	---	---	6718-0001	4156-0000	11831-0000	798-0030	
2300-9004	USA	080	1" NPT	Foot		90118-0003		890-0000	17937-0001	96080-0080	91003-0010	934-0000	91004-0090	913-0000	92600-0660	---	---	6718-0001	4156-0000	11831-0000	798-0030	
2300-9005	USA	080	1" NPT	Foot		90118-0003		890-0000	17937-0001	96080-0080	91003-0010	934-0000	91004-0090	913-0000	92600-0660	---	---	6718-0001	4156-0000	11831-0000	798-0030	
2570-0001	USA	200	1 1/4" Flanged	Flange		90019-0001		816-0000	17935-0001	6408-0000	91095-0060	834-0001	91005-0040	817-0000	92600-0040	---	---	2567-0000	2574-0000	12062-0000	---	
2570-0011	USA	200	1 1/4" Flanged	Flange		90019-0001		816-0000	17935-0001	6408-0000	91095-0060	834-0001	91005-0040	817-0000	92600-0040	---	---	2567-0000	2574-0000	12062-0000	---	
2570-0011	UK	200	1 1/4" Flanged	Flange		SK19		816	17935-0001	21849	SP1005-04	834	SP1005-04	---	SP2700-50	---	---	2567-0000	2574	9336	---	
2570-0021	USA	200	1 1/4" Flanged	Flange		90019-0001		816-0000	17935-0001	6408-0000	91095-0060	834-0001	91005-0040	817-0000	92600-0040	---	---	2567-0000	2574-0000	12062-0000	---	
2570-0051	USA	200	1 1/4" Flanged	Flange		90019-0001		816-0000	17935-0001	6408-0000	91095-0060	2551-0000	91005-0040	817-0000	92600-0040	---	---	2567-0000	2574-0000	12062-0000	---	
2570-0151	USA	200	1 1/4" Flanged	Flange		90019-0001		816-0000	17935-0001	6408-0000	91095-0060	2551-0000	91005-0040	817-0000	92600-0040	---	---	2567-0000	2574-0000	12062-0000	---	
2570-0211	USA	200	1 1/4" Flanged	Flange		90019-0001		816-0000	17935-0001	6408-0000	91095-0060	834-0001	91005-0040	817-0000	92600-0040	---	---	2567-0000	2574-0000	12062-0000	---	
2570-3000	USA	200	1 1/4" Flanged	Flange		90019-0001		816-0000	17935-0001	6408-0000	91095-0060	834-0001	91005-0040	817-0000	92600-0040	---	---	2567-0000	2574-0000	12062-0000	---	
2620-200	UK	020	H/8" BSP	Foot	x	SK20		2995-0030	673-0001	SP2700-05	SP1002-02	2907-0001	SP1002-09	---	---	---	---	688-21-24	---	3992	2438-200	
2620-211	UK	020	H/8" BSP	Foot	x	SK20		2995-0030	673-0001	SP2700-05	SP1002-02	2907-0001	SP1002-09	---	---	---	---	688-21-24	---	3992	2438-200	
2620-221	UK	020	H/8" BSP	Foot	x	SK20		2995-0030	673-0001	SP2700-05	SP1002-02	2907-0001	SP1002-09	---	---	---	---	688-21-24	---	3992	2438-200	
2620-237	UK	020	H/8" BSP	Foot	x	SK20-37		2995-0030	673-0003	SP2700-05	SP1002-02	2907-0001	SP1002-09	---	---	---	---	688-21	---	3992	2438-200	

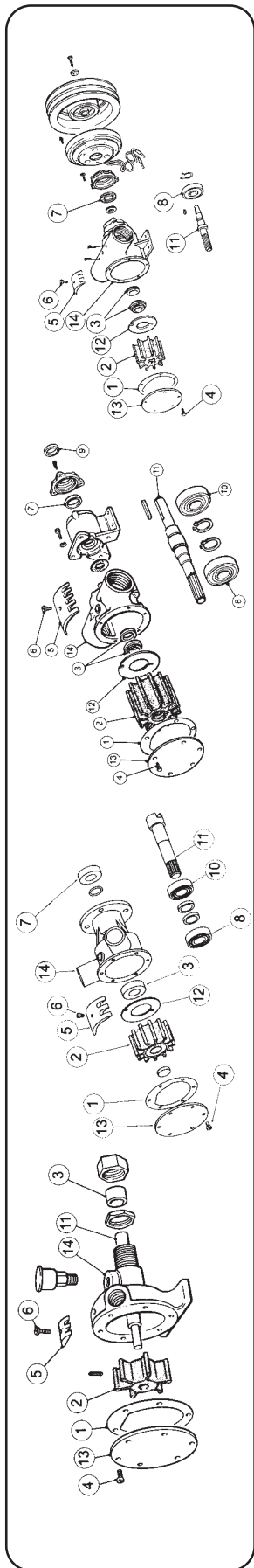

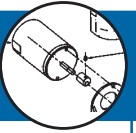

JABSCO PUMP DETAILS				SERVICE KIT DETAILS				GENERAL PARTS LISTING														
Pump Number	Origin	Pump Size	Port Type	Mount Type	Obsolete	Alternate Part No	Kit Number	Gasket/O Ring	Impeller	Water Seal	End Cover Screws	Cam	Cam Screw	Pump End Oil Seal	Pump End Bearing	Drive End Oil Seal	Drive End Bearing	Shaft	Wearplate	Endcover	Body	
							Key															* OEM supply only
2620-252	UK	020	H/8" BSP	Foot	x		SK20	2995-0030	673-0001	SP2700-05	SP1002-02	2907-0001	SP1002-09	---	---	---	---	---	---	---	---	---
2620-253	UK	020	H/8" BSP	Foot	x		SK20	2995-0030	673-0001	SP2700-05	SP1002-02	2907-0001	SP1002-09	---	---	---	---	---	---	---	---	---
2620-254	UK	020	H/8" BSP	Foot	x	2620-252	SK20-05	2442	673-0001	SP2700-05	SP1002-02	2441	SP1002-01	---	---	---	---	---	---	---	---	---
2620-255	UK	020	H/8" BSP	Foot	x		SK20-05	2995-0030	673-0001	SP2700-05	SP1002-02	2441	SP1010-06	---	---	---	---	---	---	---	---	---
2620-271	UK	020	H/8" BSP	Foot	x		SK20	2995-0030	673-0001	SP2700-05	SP1002-02	2907-0001	SP1002-09	---	---	---	---	---	---	---	---	---
2620-281	UK	020	H/8" BSP	Foot	x		SK20	2995-0030	673-0001	SP2700-05	SP1002-02	2907-0001	SP1002-09	---	---	---	---	---	---	---	---	---
2620-001	USA	020	H/8" NPT	Foot	x	2620-252	90020-0001	2995-0000	18673-0001	92700-0050	91002-0020	2907-0000	91002-0090	---	---	---	---	---	---	---	---	---
2620-003	USA	020	H/8" NPT	Foot	x		90020-0003	2995-0000	18673-0003	92700-0050	91002-0020	2907-0000	91002-0090	---	---	---	---	---	---	---	---	---
2620-0051	USA	020	H/8" NPT	Foot	x		90020-0001	2995-0000	18673-0001	92700-0050	91002-0020	2907-0000	91002-0090	---	---	---	---	---	---	---	---	---
2620-0053	USA	020	H/8" NPT	Foot	x		90020-0003	2995-0000	18673-0003	92700-0050	91002-0020	2907-0000	91002-0090	---	---	---	---	---	---	---	---	---
2620-1001	USA	020	H/8" NPT	Foot	x		90020-0001	18753-0125	18673-0001	92700-0050	91002-0020	2907-0001	91002-0090	---	---	---	---	---	---	---	---	---
2620-1003	USA	020	H/8" NPT	Foot	x		90020-0003	18753-0125	18673-0003	92700-0050	91002-0020	2907-0001	91002-0090	---	---	---	---	---	---	---	---	---
2760-0001	USA	010	1/4" NPT	Foot	x		90020-0003	1189-0000	4528-0001	92700-0110	91002-0010	4271-0000	91002-0030	---	---	---	---	---	---	---	---	---
2760-0003	USA	020	1/4" NPT	Foot	x		90023-0001	1189-0000	4528-0003	92700-0110	91002-0010	4271-0000	91002-0030	---	---	---	---	---	---	---	---	---
3110-0001	USA	200	2" Flanged	Flange	x		90019-0001	816-0000	17935-0001	6408-0000	91006-0090	834-0001	91005-0040	---	---	---	---	---	---	---	---	---
3110-0011	USA	200	2" Flanged	Flange	x		90019-0001	816-0000	17935-0001	6408-0000	91006-0090	834-0001	91005-0040	---	---	---	---	---	---	---	---	---
3190-0001	USA	080					90029-0001	890-0000	17937-0001	92700-0070	91003-0010	7873-0000	91003-0010	---	---	---	---	---	---	---	---	---
3200-0011	USA	500	2" NPT	Foot	x		90029-0001	3209-0000	2999-0001	3222-0000	91006-0050	3210-0000	91006-0030	---	---	---	---	---	---	---	---	---
3200-01	USA	500	2" NPT	Foot	x	9440-200	SK29	3209	2999-0001	9309	SP1006-05	3210	SP1006-03	---	---	---	---	---	---	---	---	---
3200-0011	USA	500	2" NPT	Foot	x		90029-0001	3209-0000	2999-0001	3222-0000	91006-0050	3210-0000	91006-0030	---	---	---	---	---	---	---	---	---
3240-0011	UK	200	2" Flanged	Flange	x		90019-0001	816-0000	17935-0001	6408-0000	91005-0060	834-0001	91005-0040	---	---	---	---	---	---	---	---	---
3240-1001	UK	200	2" Flanged	Flange	x		90019-0001	816-0000	17935-0001	6408-0000	91005-0060	834-0001	91005-0040	---	---	---	---	---	---	---	---	---
3270-0000	UK	040	H/4" BSP	Flange	x		SK33	3298	1210-0001	SP2701-21	SP1002-02	7876	SP1003-01	---	---	---	---	---	---	---	---	---
3270-0001	USA	040	H/4" BSP	Flange	x		90033-0001	3298-0000	1210-0001	92700-0060	91002-0020	7884-0000	91003-0010	---	---	---	---	---	---	---	---	---
3270-1951	UK	040	H/4" BSP	Flange	x		SK33	3298	1210-0001	SP2701-21	SP1002-02	10538	SP1003-09	---	---	---	---	---	---	---	---	---
3270-20	UK	040	H/4" BSP	Flange	x		SK33	3298	1210-0001	SP2701-21	SP1002-02	7876	SP1003-01	---	---	---	---	---	---	---	---	---
3270-200	UK	040	H/4" BSP	Flange	x	29500-1001	SK271	3298	1210-0001	SP2701-21	SP1002-02	7876	SP1003-01	---	---	---	---	---	---	---	---	---
3270-205	UK	040	H/4" BSP	Flange	x		SK33	3298	1210-0001	SP2701-21	SP1002-02	10538	SP1003-09	---	---	---	---	---	---	---	---	---
3270-2101	UK	040	H/4" BSP	Flange	x		SK271	3298	1210-0001	SP2701-21	SP1002-02	7876	SP1003-01	---	---	---	---	---	---	---	---	---
3270-2301	UK	040	H/4" BSP	Flange	x		SK33	3298	1210-0001	SP2701-21	SP1002-02	7876	SP1003-01	---	---	---	---	---	---	---	---	---
3270-2401	UK	040	H/4" BSP	Flange	x		SK33	3298	1210-0001	SP2701-21	SP1002-02	7876	SP1003-01	---	---	---	---	---	---	---	---	---
3270-241	UK	040	H/4" BSP	Flange	x		SK271	3298	1210-0001	SP2701-21	SP1002-02	7876	SP1003-01	---	---	---	---	---	---	---	---	---
3270-251	UK	040	H/4" BSP	Flange	x		SK33	3298	1210-0001	SP2701-21	SP1002-02	7876	SP1003-01	---	---	---	---	---	---	---	---	---
3270-261	UK	040	H/4" BSP	Flange	x		SK33	3298	1210-0001	SP2701-21	SP1002-02	7876	SP1003-01	---	---	---	---	---	---	---	---	---
3270-271	UK	040	H/4" BSP	Flange	x		SK271	3298	1210-0001	SP2701-21	SP1002-02	7876	SP1003-01	---	---	---	---	---	---	---	---	---
3270-2801	UK	040	H/4" BSP	Flange	x		SK271	3298	1210-0001	SP2701-21	SP1002-02	7876	SP1003-01	---	---	---	---	---	---	---	---	---
3280-200	UK	040	H/4" BSP	Flange	x		SK33	3298	1210-0001	SP2701-21	SP1002-02	10538	SP1003-09	---	---	---	---	---	---	---	---	---
3370-200	UK	040	H/4" BSP	Flange	x	9970-200	SK33	3298	1210-0001	SP2701-21	SP1002-02	7876	SP1003-01	---	---	---	---	---	---	---	---	---
3370-201	UK	040	H/4" BSP	Flange	x		SK33	3298	1210-0001	SP2701-21	SP1002-02	10538	SP1003-09	---	---	---	---	---	---	---	---	---
3370-221	UK	040	H/4" BSP	Flange	x		SK33	3298	1210-0001	SP2701-21	SP1002-02	7876	SP1003-01	---	---	---	---	---	---	---	---	---

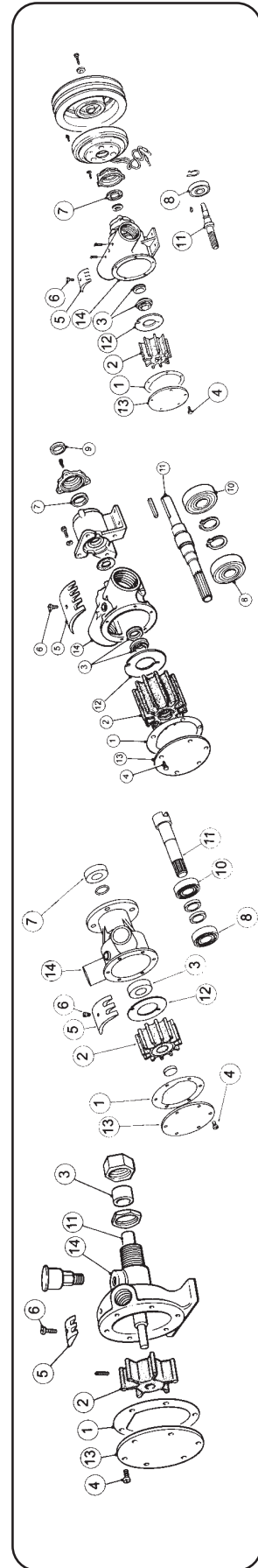

Service Parts - Flexible Impeller Pumps Spares by Pump Model 2620-252 to 3370-221

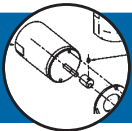

10

www.jabasco.com

JABSCO

Service Parts - Flexible Impeller Pumps Spares by Pump Model 3370-241 to 400-111

JABSCO PUMP DETAILS				SERVICE KIT DETAILS				GENERAL PARTS LISTING														
Pump Number	Origin	Pump Size	Port Type	Mount Type	Obsolete	Alternate Part No	Kit Number	Gasket/O Ring	Impeller	Water Seal	End Cover Screws	Cam	Cam Screw	Pump End Oil Seal	Pump End Bearing	Drive End Oil Seal	Drive End Bearing	Shaft	Wearplate	Endcover	Body	
							Key															
3370-241	UK	040	H/4" BSP	Flange	x		SK33	3298	1210-0001	SP2701-21	SP1002-02	10538	SP1003-09	SP2701-21	SP2600-13	SP2600-13	5857	7883	3992	3274-200		
3370-251	UK	040	H/4" BSP	Flange	x	9970-261	SK33	3298	1210-0001	SP2701-21	SP1002-02	Assy 7884	SP1003-01	SP2701-21	SP2600-13	SP2600-13	9647	Assy 7884	3992	3274-251		
3370-271	UK	040	H/4" BSP	Flange	x		SK33	3298	1210-0001	SP2701-21	SP1002-02	Assy 7884	SP1003-01	SP2701-21	SP2600-13	SP2600-13	5857	Assy 7884	3992	3274-200		
3380-001	USA	040	1/2" NPT	Flange	x		90033-0001	5212-0000	1210-0001	92700-0060	91002-0020	5211-0000	91003-0090	92700-0060	92600-0130	92600-0130	5857-0000	---	11830-0000	3384-0000		
3380-021	UK	040	H/4" BSP	Flange	x	9970-200	SK33	3298	1210-0001	SP2701-21	SP1002-02	Assy 5211	SP1003-07	SP2701-21	SP2600-13	SP2600-13	5857	Assy 5211	3992	3384		
3380-221	UK	040	H/4" BSP	Flange	x	9970-200	SK33	3298	1210-0001	SP2701-21	SP1002-02	Assy 5211	SP1003-07	SP2701-21	SP2600-13	SP2600-13	5857	Assy 5211	3992	3384		
3570	UK	200	1 1/4" Flanged	Flange	x		SK375-0101	816	17935-0001	21849	SP1005-04	Assy 7257	SP1005-04	SP2700-51	---	SP2700-49	3577-0020	Assy 7257	9336	3574		
3570-001	UK	200	1 1/4" Flanged	Flange	x		90019-0001	816-0000	6408-0000	6408-0000	91005-0060	7256-0000	91005-0040	818-0000	92600-0040	92600-0040	818-0000	2574-0000	12062-0000	Obsolote		
3590-901	UK	080	1 1/4" Flanged	Flange	x		90118-0001	2432-0000	96080-0080	96080-0080	91003-0010	7957-0000	91004-0090	92700-0200	92600-0060	92600-0060	92700-0200	Obsolote	7957-0000	Obsolote		
3890-9011	UK	040	H/4" NPT	Foot	x		90111-0011	3298-0000	1210-0001	96080-0080	91000-0020	7884-0000	91003-0010	92700-0180	92600-0070	92600-0070	3897-9000	7884-0000	11831-0000	3894-0010		
4160	UK	080	Ø 3.2 Hose	Flange	x																	
4330-01	UK	080	32 Hs./Fl.	Flange	x																	
4360	UK	200	1 1/2" Flanged	Flange	x																	
4410	UK	040	H/4" BSP	Flange	x		SK230	816	836-0001	21849	SP1005-04	834	SP1005-04	SP2704-01	SP2600-20	SP2704-02	4367	2574	9336	4364		
4530-0001	USA	010	1/4" NPT	Foot	x		SK242	4908	4568-0001	SP2701-01	SP6060-02	6396	SP1003-01	---	---	---	4417	5097	4905	4414		
4530-0003	USA	010	1/4" NPT	Foot	x		90001-0001	1126-0000	4528-0001	4539-0000	91002-0010	4538-0000	91002-0020	---	---	---	4537-0000	---	11835-0000	4534-0000		
4540-0001	USA	010	1/4" NPT	Foot	x		90001-0003	1126-0000	4528-0003	4539-0000	91002-0010	4538-0000	91002-0020	---	---	---	4537-0000	---	11835-0000	4534-0000		
4540-0003	USA	020	H/8" NPT	Foot	x		90002-0001	2995-0000	4529-0001	4549-0000	91002-0010	2907-0000	91002-0020	---	---	---	4547-0000	---	11830-0000	4544-0000		
4540-0003	USA	020	H/8" NPT	Foot	x		90002-0003	2995-0000	4527-0003	4549-0000	91002-0010	2907-0000	91002-0020	---	---	---	4547-0000	---	11830-0000	4544-0000		
4560-0001	USA	040	1/2" NPT	Foot	x		90003-0001	7083-0000	4568-0001	3791-0000	91002-0020	490-0001	91003-0070	---	---	---	4567-0000	---	4565-0000	4564-0000		
4560-0003	USA	040	1/2" NPT	Foot	x		90003-0003	7083-0000	4568-0003	3791-0000	91002-0020	490-0001	91003-0070	---	---	---	4567-0000	---	4565-0000	4564-0000		
4590-0001	USA	080	H/4" NPT	Foot	x		90004-0001	706-0010	4598-0001	3791-0000	91003-0010	17612-0000	91004-0010	---	---	---	4597-0000	---	4595-0000	4594-0000		
4590-0003	USA	080	H/4" NPT	Foot	x		90004-0003	706-0010	4598-0003	3791-0000	91003-0010	17612-0000	91004-0010	---	---	---	4597-0000	---	4595-0000	4594-0000		
4620-0001	USA	080	1" NPT	Foot	x		90004-0003	706-0010	4598-0001	3791-0000	91003-0010	17612-0000	91004-0010	---	---	---	4597-0000	---	4595-0000	4594-0000		
4620-0003	USA	080	1" NPT	Foot	x		90004-0003	706-0010	4598-0003	3791-0000	91003-0010	17612-0000	91004-0010	---	---	---	4597-0000	---	4595-0000	4594-0000		
4760-01	UK	020	H/4" BSP	Flange	x		SK228	2995-0030	673-0001	SP2701-04	SP1002-01	4454	SP1002-09	---	---	---	4766	4466	3992	4764		
4760-101	UK	020	H/4" BSP	Flange	x		SK228	2995-0030	673-0001	SP2701-04	SP1002-01	4454	SP1002-09	---	---	---	4766	4466	3992	4764		
4760-111	UK	020	H/4" BSP	Flange	x		SK228	2995-0030	673-0001	SP2701-04	SP1002-01	4454	SP1002-09	---	---	---	4766	4466	3992	4764		
4760-141	UK	020	H/4" BSP	Flange	x		SK228	2995-0030	673-0001	SP2701-04	SP1002-01	4454	SP1002-09	---	---	---	4766	4466	3992	4764		
4760-151	UK	020	H/4" BSP	Flange	x		SK228	2995-0030	673-0001	SP2701-04	SP1002-01	4454	SP1002-09	---	---	---	4766	4466	3992	4764		
4760-41	UK	020	H/4" BSP	Flange	x		SK228	2995-0030	673-0001	SP2701-04	SP1002-01	4454	SP1002-09	---	---	---	4766	4466	3992	4764		
4760-51	UK	020	H/4" BSP	Flange	x		SK228	2995-0030	673-0001	SP2701-04	SP1002-01	4454	SP1002-09	---	---	---	4766	4466	3992	4764		
4760-61	UK	020	H/4" BSP	Flange	x		SK228	2995-0030	673-0001	SP2701-04	SP1002-01	4454	SP1002-09	---	---	---	4766	4466	3992	4764		
4760-71	UK	020	H/4" BSP	Flange	x		SK228	2995-0030	673-0001	SP2701-04	SP1002-01	4454	SP1002-09	---	---	---	4766	4466	3992	4764		
4760-81	UK	020	H/4" BSP	Flange	x		SK228	2995-0030	673-0001	SP2701-04	SP1002-01	4454	SP1002-09	---	---	---	4766	4466	3992	4764		
4760-91	UK	020	H/4" BSP	Flange	x		SK228	2995-0030	673-0001	SP2701-04	SP1002-01	4454	SP1002-09	---	---	---	4766	4466	3992	4764		
4800-101	UK	200	1 1/2" Flanged	Flange	x		SK230	816	836-0001	21849	SP1005-04	AL8-01	SP1002-01	---	---	---	4338-07	2574	AL6-200	4804-01		
4800-111	UK	200	1 1/2" Flanged	Flange	x	11790	SK230	816	836-0001	21849	SP1005-04	834	SP1005-04	SP2700-51	---	---	4338-07	2574	9336	4804-01		

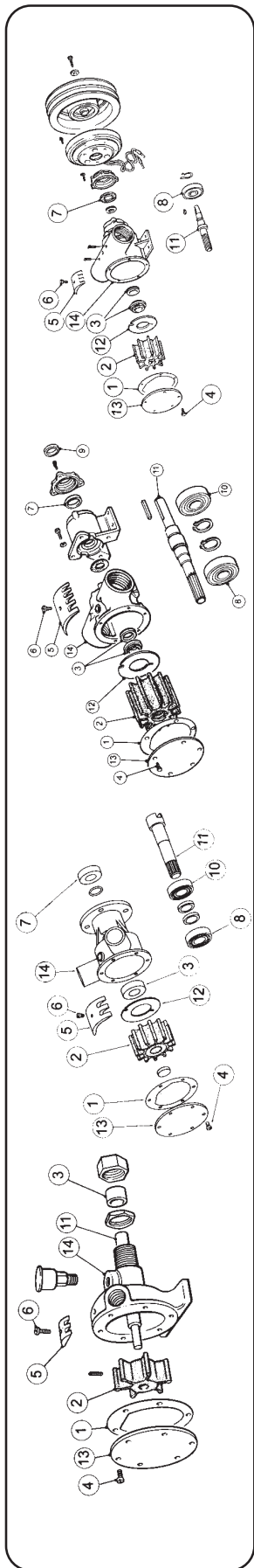

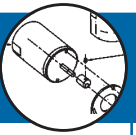

JABSCO PUMP DETAILS				SERVICE KIT DETAILS				GENERAL PARTS LISTING													
Pump Number	Origin	Pump Size	Port Type	Mount Type	Alternate Part No	Obsol	Kit Number	Gasket/O Ring	Impeller	Water Seal	End Cover Screws	Cam	Cam Screw	Pump End Oil Seal	Pump End Bearing	Drive End Oil Seal	Drive End Bearing	Shaft	Wearplate	Endcover	Body
							Key	1	2	3	4	5	6	7	8	9	10	11	12	13	14
4800-161	UK	200	1/2" Flanged	Flange		x	SK230	816	836-0001	21849	SP1005-04	834	SP1005-04	SP2700-51	---	---	SP2600-03	4388	2574	4807-161	4804-01
4800-171	UK	200	1/2" Flanged	Flange		x	SK230	816	836-0001	21849	SP1005-04	2551	SP1005-05	SP2700-51	---	---	SP2600-03	4388	2574	4807-181	4804
4800-21	UK	200	1/2" BSP	Flange	4800-21-01	x	SK230	816	836-0001	21849	SP1005-04	2551	SP1005-05	SP2700-51	---	---	SP2600-18	4388-07	2574	9336	4804
4800-21-01	UK	200	1/2" Flanged	Flange		x	SK230	816	836-0001	21849	SP1005-04	2551	SP1005-05	SP2700-51	---	---	SP2600-18	4388-07	2574	9336	4804
4800-41	UK	200	1/2" Flanged	Flange		x	SK230	816	836-0001	21849	SP1005-04	834	SP1005-05	SP2700-51	---	---	SP2600-18	4388-07	2574	9336	4804
4800-51	UK	200	1/2" Flanged	Flange		x	SK230	816	836-0001	21849	SP1005-04	2551	SP1005-05	SP2700-51	---	---	SP2600-18	4388	2574	4807-51	4804-01
4800-53	UK	200	1/2" Flanged	Flange		x	SK230	816	836-0001	21849	SP1005-04	834	SP1005-05	SP2700-51	---	---	SP2600-03	4388-53	2574	9336	4804-01
4800-54	UK	200	1/2" Flanged	Flange		x	SK230	816	836-0001	21849	SP1005-04	834	SP1005-05	SP2700-51	---	---	SP2600-18	4388-07	2574	9336	4804-01
4800-71	UK	200	1/2" Flanged	Flange		x	SK230	816	836-0001	21849	SP1005-04	834	SP1005-05	SP2700-51	---	---	SP2600-18	4388-07	2574	9336	4804-01
4850	UK	080	Ø 32 Hose	Flange	9750	x	3101	920-08	SP2700-06	SP1003-09	5418	SP1003-09	SP2601-19	---	---	SP2601-04	4857	5419	4855	4854	
4850	UK	080	Ø 32 Hose	Flange	9760	x	3101	920-08	SP2700-06	SP1003-09	5418	SP1003-09	SP2601-19	---	---	SP2601-04	4857	5419	4855	4854	
4900-01	UK	040	1/2" BSP	Foot		x	SK234	4908	4568-0001	3791	SP1003-09	4908	SP1003-07	---	---	SP2600-01	C10	---	4905	4904	
4900-200	UK	040	1/2" BSP	Foot		x	SK234	4908	4568-0001	3791	SP1003-09	490	SP1003-07	---	---	SP2600-01	C10-01	---	4905	4904-200	
4900-201	UK	040	1/2" BSP	Foot		x	SK234	4908	4568-0001	3791	SP1003-09	490	SP1003-07	---	---	SP2600-01	C10-01	---	4905	4904-200	
4900-205	UK	040	1/2" BSP	Foot		x	SK234	4908	4568-0001	3791	SP1003-09	10336	SP1003-10	---	---	SP2600-01	C10-01	---	4905	4904-200	
4900-237	UK	040	1/2" BSP	Foot		x	SK234-37	4908	4568-0003	3791	SP1003-09	490	SP1003-07	---	---	SP2600-01	C10-01	---	4905	4904-200	
5320-0011	USA	020	H/8NPT	Foot		x	90044-0001	2995-0000	5616-0001	92700-0420	91002-0020	7895-0000	91002-0090	---	---	---	---	---	---	11830-0000	4484-0000
5330-9001	USA	080	1" NPT	Foot		x	90118-0001	3101-0000	17937-0001	96080-0080	91003-0010	7867-0000	91003-0010	913-0000	92600-0060	---	---	5337-0000	7868-0000	11831-0000	3784-9000
5330-9101	USA	080	1" NPT	Foot		x	90118-0001	890-0000	17937-0001	96080-0080	91003-0010	17612-0001	91004-0090	913-0000	92600-0060	---	---	5337-0000	7868-0000	11831-0000	3784-9000
5400-205	UK	080	1 1/4" BSP	Foot	52200-2051	x	SK406-0001	890	17937-0001	---	---	---	---	---	---	---	---	---	---	---	---
5460	UK	020	H/8" BSP	Flange		x	90051-0001	3298-0000	672-0001	SP2701-04	SP1011-01	2907-0001	91002-0010	913-0000	92600-0060	---	---	5467	4466	5465	5464
5560-0001	USA	040	1" NPT	Flange		x	90051-0001	3298-0000	672-0001	SP2701-04	SP1011-01	2907-0001	91002-0010	913-0000	92600-0060	---	---	5467	4466	5465	5464
5640	UK	020	1" NPT	Flange		x	SK228	2995-0030	1210-0001	SP2701-04	SP1003-01	4454	SP1002-01	913-0000	92600-0060	---	---	5647	4466	---	5644
5840-0000	UK	080	1/2" NPT	Flange		x	90051-0001	3298-0000	1210-0001	92700-0060	91002-0020	7607-0000	91003-0010	913-0000	92600-0060	---	---	5947-0000	4156-0000	11831-0000	Obsolete
5850-0001	UK	040	1/2" NPT	Flange		x	SK33	3298	12104-0001	SP2701-21	SP1002-02	Assy 7884	SP1003-01	SP2701-21	---	---	SP2600-13	5857	7884	3992	5854
5850-0001	UK	040	1/2" NPT	Flange		x	90033-0001	3298-0000	12104-0001	92700-0060	91002-0020	7884-0000	91003-0010	92700-0060	92600-0130	---	---	5877	5876	11830-0000	5854-0000
5870	UK	005	1/2" BSP	Flange		x	SK236	890	17937-0001	SP2701-09	SP1002-09	8568	SP1002-01	SP2701-09	---	---	92600-0130	5877	5876	5875	5874
6030-21	UK	080	1" Flanged	Flange		x	SK236	890	17937-0001	SP2701-21	SP1003-09	934	SP1004-09	SP2701-48	---	---	SP2600-06	6037	4156	3993	6034
6030-41	UK	080	1" Flanged	Flange		x	SK236	890	17937-0001	SP2701-21	SP1003-09	2431	SP1004-10	SP2701-48	---	---	SP2600-06	6037	4156	3993	6034
6030-61	UK	080	1" Flanged	Flange		x	SK236	890	17937-0001	SP2701-21	SP1003-09	3255	SP1004-11	SP2701-48	---	---	SP2600-06	6037	4156	3993	6034
6030-71	UK	080	1" Flanged	Flange		x	SK237	890	17937-0001	SP2701-21	SP1003-09	934	SP1004-09	SP2700-48	---	---	SP2600-31	6037	4156	3993	6034
6330	UK	080	32 Hs./fl.	Flange		x	SK237	890	4325-0480	SP2701-06	SP1003-11	4329	SP1004-09	SP2701-06	---	---	SP2600-13	4337	3196-01 ext	6335	6334
6400-0001	USA	200	1 1/4" NPT	Foot		x	90062-0001	816-0000	17935-0001	6407-0010	91005-0040	834-0001	91005-0040	817-0000	92600-0040	818-0000	12062-0000	824-0020	2574-0000	12062-0000	6404-0000
6400-0004	USA	200	1 1/4" NPT	Foot		x	90062-0001	816-0000	17935-0001	6407-0010	91005-0040	834-0001	91005-0040	817-0000	92600-0040	818-0000	12062-0000	824-0020	2574-0000	12062-0000	6404-0000
6400-0051	USA	200	1 1/4" NPT	Foot		x	90062-0001	816-0000	17935-0001	6407-0010	91005-0040	2551-0000	91005-0050	817-0000	92600-0040	818-0000	12062-0000	824-0020	2574-0000	12062-0000	6404-0000
6400-1051	USA	200	1 1/4" NPT	Foot		x	90062-0001	816-0000	17935-0001	6407-0010	91005-0040	2551-0000	91005-0050	817-0000	92600-0040	818-0000	12062-0000	824-0020	2574-0000	12062-0000	6404-0000
6400-200	UK	200	1 1/4" BSP	Foot	52200-2001	x	SK230	816	836-0001	21849	SP1005-04	834	SP1005-04	SP2700-50	---	---	SP2600-04	9527	2574	9336	6404-200
6400-205	UK	200	1 1/4" BSP	Foot	52200-2051	x	SK230	816	836-0001	21849	SP1005-04	2551	SP1005-05	SP2700-50	---	---	SP2600-04	9527	2574	9336	6404-200
6400-207	UK	200	1 1/4" BSP	Foot	52200-2001	x	SK230	816	836-0001	21849	SP1005-04	834	SP1005-04	SP2700-50	---	---	SP2600-04	9527	2574	9336	6404-200

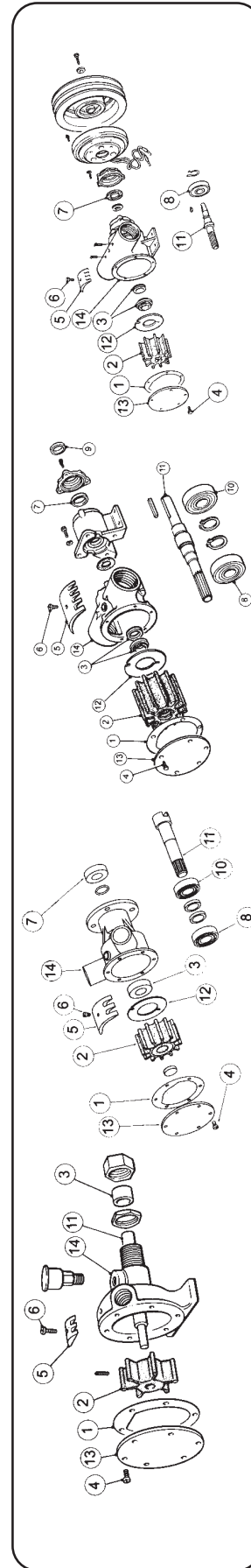

Service Parts - Flexible Impeller Pumps Spares by Pump Model 400-161 to 6400-207

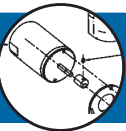

Service Parts - Flexible Impeller Pumps Spares by Pump Model 6420-0101 to 66590-0005

JABSCO PUMP DETAILS				SERVICE KIT DETAILS				GENERAL PARTS LISTING														
Pump Number	Origin	Pump Size	Port Type	Mount Type	Alternate Part No	Kit Number	Key	Gasket/O-ring	Impeller	Water Seal	End Cover Screws	Cam	Cam Screw	Pump End Oil Seal	Pump End Bearing	Drive End Oil Seal	Drive End Bearing	Shaft	Wearplate	Endcover	Body	
									<small>*Data supply only</small>													<small>*Data supply only</small>
6420-0101	USA	080	1"NPT	Foot	x	52220-0011	SK236	890	17937-0001	SP2701-21	SP1003-09	934	SP1004-09	SP2700-46	SP2700-47	SP2600-06	6718-21	4156	3993	6424		
6420-200	UK	080	1"BSP	Foot	x	52080-2001	SK236	890	17937-0001	SP2701-21	SP1003-09	934	SP1004-09	SP2700-48	SP2700-47	SP2600-06	6718-21	4156	3993	6424		
6420-2001	UK	080	1"BSP	Foot	x	52080-2001	SK385-0201	890	17937-0001	SP2700-1027	SP1003-09	934	SP1004-09	SP2700-48	SP2700-47	SP2600-06	6718-21	4156	3993	6424-2200		
6420-204	UK	080	1"BSP	Foot	x	52080-2041	SK236	890	17937-0001	SP2701-21	SP1003-09	3255	SP1004-10	SP2700-48	SP2700-47	SP2600-06	6718-21	4156	3993	6424-2200		
6420-2041	UK	080	1"BSP	Foot	x	52080-2041	SK385-0201	3101	17937-0001	SP2700-1027	SP1003-09	3255	SP1004-10	SP2700-48	SP2700-47	SP2600-06	6718-21	4156	3993	6424-2200		
6420-205	UK	080	1"BSP	Foot	x	52080-2051	SK236	890	17937-0001	SP2701-21	SP1003-09	2431	SP1004-10	SP2700-48	SP2700-47	SP2600-06	6718-21	4156	3993	6424-2200		
6420-2051	UK	080	1"BSP	Foot	x	52080-2051	SK385-0201	2432	17937-0001	SP2700-1027	SP1003-09	2431	SP1004-10	SP2700-48	SP2700-47	SP2600-06	6718-21	4156	3993	6424-2200		
6490-112	UK	040	1/2"BSP	Foot	x	SK225-01	SK225-01	6496	1210-0001	SP2701-21	SP1003-09	490	SP1003-01	---	---	---	1737-207	---	---	3993	21634	
6490-123	UK	040	1/2"BSP	Foot	x	SK225-01	SK225-01	6496	1210-0001	SP2701-21	SP1003-09	490	SP1003-01	---	---	---	1737-207	---	---	3993	21634	
6490-132	UK	040	1/2"BSP	Foot	x	6490-132	SK225-01	6496	1210-0001	SP2701-21	SP1003-09	490	SP1003-01	---	---	---	1737-207	---	---	3993	21634	
6490-152	UK	040	1/2"BSP	Foot	x	SK225-01	SK225-01	6496	1210-0001	SP2701-21	SP1003-09	490	SP1003-01	---	---	---	1737-207	---	---	3993	21634	
6490-153	UK	040	1/2"BSP	Foot	x	SK225-01	SK225-01	6496	1210-0001	SP2701-21	SP1003-09	490	SP1003-01	---	---	---	1737-207	---	---	3993	21634	
6490-200	UK	040	1/2"BSP	Foot	x	6490-200	SK225-01	6496	1210-0001	SP2701-21	SP1003-09	490	SP1003-01	---	---	---	1737-207	---	---	3993	6494-200	
6490-210	UK	040	1/2"BSP	Foot	x	SK225-01	SK225-01	6496	1210-0001	SP2701-21	SP1003-09	490	SP1003-01	---	---	---	1737-207	---	---	3993	6494-200	
6490-222	UK	040	1/2"BSP	Foot	x	SK225-01	SK225-01	6496	1210-0001	SP2701-21	SP1003-09	490	SP1003-01	---	---	---	1737-207	---	---	3993	6494-200	
6490-223	UK	040	1/2"BSP	Foot	x	SK225-01	SK225-01	6496	1210-0001	SP2701-21	SP1003-09	490	SP1003-01	---	---	---	1737-207	---	---	3993	6494-200	
6490-224	UK	040	1/2"BSP	Foot	x	SK225-01	SK225-01	6496	1210-0001	SP2701-21	SP1003-09	10336	SP1003-09	---	---	---	1737-207	---	---	3993	6494-200	
6490-225	UK	040	1/2"BSP	Foot	x	SK225-01	SK225-01	6496	1210-0001	SP2701-21	SP1003-09	10336	SP1003-09	---	---	---	1737-207	---	---	3993	6494-200	
6490-231	UK	040	1/2"BSP	Foot	x	SK225-01	SK119	6496	1210-0001	SP2701-21	SP1003-09	10336	SP1003-09	---	---	---	1737-207	---	---	3993	6494-200	
6490-232F	UK	040	1/2"BSP	Foot	x	SK225-01	SK119	6496	1210-0001	SP2701-21	SP1003-09	10336	SP1003-09	---	---	---	1737-207	---	---	3993	6494-200	
6490-241	UK	040	1/2"BSP	Foot	x	6490-241	SK225-01	6496	1210-0001	SP2701-21	SP1003-09	490	SP1003-01	---	---	---	1737-207	---	---	3993	6494-200	
6490-246	UK	040	1/2"BSP	Foot	x	6490-246	SK225-01	6496	1210-0001	SP2701-21	SP1003-09	490	SP1003-01	---	---	---	1737-207	---	---	3993	6494-200	
6490-252	UK	040	1/2"BSP	Foot	x	6490-252	SK225-01	6496	1210-0001	SP2701-21	SP1003-09	490	SP1003-01	---	---	---	1737-207	---	---	3993	6494-200	
6490-253	UK	040	1/2"BSP	Foot	x	6490-253	SK225-01	6496	1210-0001	SP2701-21	SP1003-09	490	SP1003-01	---	---	---	1737-207	---	---	3993	6494-200	
6490-254	UK	040	1/2"BSP	Foot	x	6490-254	SK225-01	6496	1210-0001	SP2701-21	SP1003-09	490	SP1003-01	---	---	---	1737-207	---	---	3993	6494-200	
6490-255	UK	040	1/2"BSP	Foot	x	6490-255	SK225-01	6496	1210-0001	SP2701-21	SP1003-09	490	SP1003-01	---	---	---	1737-207	---	---	3993	6494-200	
6490-2901	UK	040	1/2"BSP	Foot	x	6490-2901	SK225-01	6496	1210-0001	SP2701-21	SP1003-09	490	SP1003-01	---	---	---	1737-207	---	---	3993	6494-200	
6520-200	UK	080	1"BSP	Foot	x	51080-2001	SK236	890	17937-0001	SP2701-21	SP1003-09	934	SP1004-09	SP2700-48	SP2600-06	6718-201	4156	3993	6424-2200			
6520-2003	UK	080	1"BSP	Foot	x	51080-2003	SK385-0403	890	17937-0003	SP2700-1027	SP1003-09	934	SP1004-09	SP2700-48	SP2600-06	6718-201	4156	3993	6424-2200			
6520-205	UK	080	1"BSP	Foot	x	SK236	SK236	890	17937-0001	SP2701-21	SP1003-09	2431	SP1004-10	SP2700-48	SP2600-06	6718-201	4156	3993	6424-2200			
6520-237	UK	080	1"BSP	Foot	x	51080-2001	SK235-37	890	17937-0003	SP2701-21	SP1003-09	2431	SP1004-10	SP2700-48	SP2600-06	6718-201	4156	3993	6424-2200			
6520-251	UK	080	1"BSP	Foot	x	51080-2001	SK236	890	17937-0001	SP2701-21	SP1003-09	2431	SP1004-10	SP2700-48	SP2600-06	6718-201	4156	3993	6424-2200			
6520-51	UK	080	1"BSP	Foot	x	SK236	SK236	890	17937-0001	SP2701-21	SP1003-09	934	SP1004-09	SP2700-48	SP2600-06	6718-201	4156	3993	6424-2200			
6540-200	UK	020	H/BSP	Foot	x	SK205	SK205	2995-0030	673-0001	822	SP8019-01	2907-0001	SP1002-02	---	---	---	6547	---	---	3992	6544-200	
6540-201	UK	020	H/BSP	Foot	x	SK205-01	SK205-01	2995-0030	673-0001	822	SP8019-01	2907-0001	SP1002-02	---	---	---	6547	---	---	3992	6544-200	
6540-211	UK	020	H/BSP	Foot	x	SK205-01	SK205-01	2995-0030	673-0001	822	SP8019-01	2907-0001	SP1002-02	---	---	---	6547	---	---	3992	6544-200	
6590-0001	USA	200	1 1/2"NPT	Foot	x	90062-0001	90062-0001	816-0000	17935-0001	6407-0010	91005-0040	834-0001	91005-0040	817-0000	92600-0040	---	---	824-0000	2574-0000	12062-0000	6594-0000	
6590-0003	USA	200	1 1/2"NPT	Foot	x	90062-0001	90062-0001	816-0000	17935-0001	6407-0010	91005-0040	834-0001	91005-0040	817-0000	92600-0040	---	---	824-0000	2574-0000	12062-0000	6594-0000	
6590-0004	USA	200	1 1/2"NPT	Foot	x	90062-0001	90062-0001	816-0000	17935-0001	6407-0010	91005-0040	834-0001	91005-0040	817-0000	92600-0040	---	---	824-0000	2574-0000	12062-0000	6594-0000	
6590-0005	USA	200	1 1/2"NPT	Foot	x	90062-0003	90062-0003	816-0000	836-0003	6407-0010	91005-0040	834-0001	91005-0040	817-0000	92600-0040	---	---	824-0000	2574-0000	12062-0000	6594-0000	

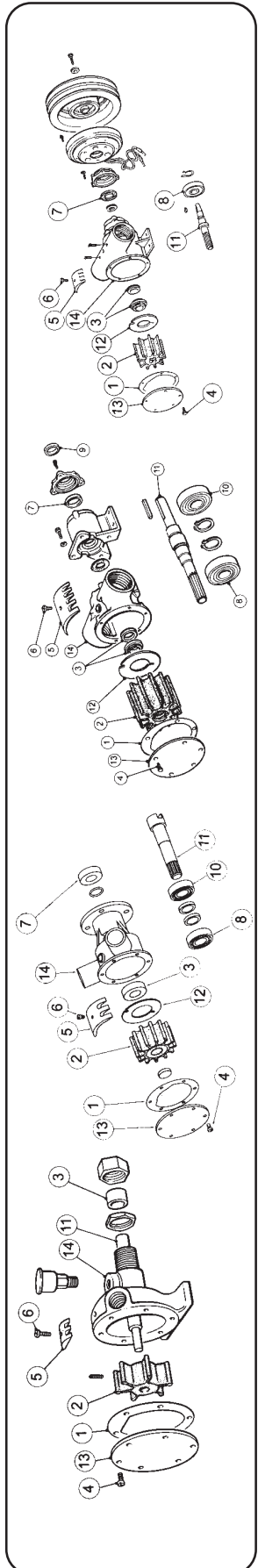

JABSCO PUMP DETAILS				SERVICE KIT DETAILS				GENERAL PARTS LISTING													
Pump Number	Origin	Pump Size	Port Type	Mount Type	Alternate Part No	Kit Number	Gasket/O Ring	Impeller	Water Seal	End Cover Screws	Cam	Cam Screw	Pump End Oil Seal	Pump End Bearing	Drive End Oil Seal	Drive End Bearing	Shaft	Wearplate	Endcover	Body	
						Key		* OEM supply only													* OEM supply only
6590-200	UK	200	1/4" BSP	Foot	x 51200-2011	SK230	816	836-0001	21849	SP1005-04	834	SP1005-04	SP2700-50	SP2600-04	SP2600-09	9527-0001	2574	9336	6594-200		
6590-237	UK	200	1/4" BSP	Foot	x 51200-2003	SK230-37	816	836-0003	21849	SP1005-04	834	SP1005-04	SP2700-50	SP2600-04	SP2600-09	9527-0001	2574	9336	6594-200		
6640-200	UK	010	1/4" BSP	Foot	x 52010-2001	SK23	1189	4528-0001	SP2701-14	SP1002-01	2763	SP1002-03	SP2700-63	SP2700-62	SP2600-08	1053	2765	9566	6644-200		
6640-205	UK	010	1/4" BSP	Foot	x 52010-2001	SK23	1189	4528-0001	SP2701-14	SP1002-01	21233	SP1002-0234	SP2700-63	SP2700-62	SP2600-08	1053	2765	6645-105	6644-200		
6710	UK	020	1/2" BSP	Flange	x	SK241	2995-0030	673-0001	SP2701-04	SP1002-09	4454	SP1002-02	---	---	---	6717	4466	3992	4764-41		
6980-0001	USA	270	2" Flanged	Flange		90065-0001	816-0000	17936-0001	6408-0000	91005-0040	6988-0000	91005-0040	91005-0040	92600-0320	---	---	6987-0000	12062-0000	12062-0000	12062-0000	Proprietary
6980-0002	USA	270	2" Flanged	Flange		90065-0001	816-0000	17936-0001	6408-0000	91005-0040	6988-0000	91005-0040	91005-0040	92600-0320	---	---	6987-0000	12062-0000	12062-0000	12062-0000	Proprietary
6980-0003	USA	270	2" Flanged	Flange		90065-0001	816-0000	17936-0001	6408-0000	91005-0040	6988-0000	91005-0040	91005-0040	92600-0320	---	---	6987-0000	12062-0000	12062-0000	12062-0000	Proprietary
6980-0004	USA	270	2" Flanged	Flange		90065-0001	816-0000	17936-0001	6408-0000	91005-0040	6988-0000	91005-0040	91005-0040	92600-0320	---	---	6987-0000	12062-0000	12062-0000	12062-0000	Proprietary
6980-0005	USA	270	2" Flanged	Flange		90065-0001	816-0000	17936-0001	6408-0000	91005-0040	6988-0000	91005-0040	91005-0040	92600-0320	---	---	6987-0000	12062-0000	12062-0000	12062-0000	Proprietary
6980-0006	USA	270	2" Flanged	Flange		90065-0001	816-0000	17936-0001	6408-0000	91005-0040	6988-0000	91005-0040	91005-0040	92600-0320	---	---	6987-0000	12062-0000	12062-0000	12062-0000	Proprietary
6980-0411	USA	270	2" Flanged	Flange		90065-0001	816-0000	17936-0001	6408-0000	91005-0040	6988-0000	91005-0040	91005-0040	92600-0320	---	---	6987-0000	12062-0000	12062-0000	12062-0000	Proprietary
6980-3000	USA	270	2" Flanged	Flange		90065-0001	816-0000	17936-0001	6408-0000	91005-0040	6988-0000	91005-0040	91005-0040	92600-0320	---	---	6987-0000	12062-0000	12062-0000	12062-0000	Proprietary
7120-9001	USA	040	1/4" / 1/2" Hose	Flange		90111-0001	3298-0000	1210-0001	96080-0080	91002-0020	7607-0000	91003-0010	913-0000	92600-0060	---	---	7127-0000	7607-0000	11830-0000	11830-0000	Obsolète
7260-0001	USA	080	1/2" Flanged	Flange		90111-0001	3101-0000	17937-0001	92700-0060	91003-0010	7874-0000	91003-0020	913-0000	92600-0060	---	---	7267-0000	7874-0000000	11831-0000	11831-0000	Obsolète
7320-9001	USA	040	1/4" / 1/2" Hose	Flange		90062-0001	816-0000	17935-0001	6407-0010	91005-0040	834-0001	91005-0040	913-0000	92600-0060	---	---	7127-0000	7607-0000	11830-0000	11830-0000	Obsolète
7420-0001	USA	200	1/4" NPT	Foot	x	SK230	816	836-0001	21849	SP1005-04	834	SP1005-04	SP2700-50	SP2600-04	SP2600-09	9527-0001	2574	9336	6594-200	7424-0000	
7420-0004	UK	200	1/4" NPT	Foot	x	SK230	816	836-0001	21849	SP1005-04	834	SP1005-04	SP2700-50	SP2600-04	SP2600-09	9527-0001	2574	9336	6594-200	7424-0000	
7420-0001	USA	200	1/4" NPT	Foot	x	SK230	816	836-0001	21849	SP1005-04	834	SP1005-04	SP2700-50	SP2600-04	SP2600-09	9527-0001	2574	9336	6594-200	7424-0000	
7420-0101	USA	200	1/4" NPT	Foot	x	SK230	816	836-0001	21849	SP1005-04	834	SP1005-04	SP2700-50	SP2600-04	SP2600-09	9527-0001	2574	9336	6594-200	7424-0000	
7420-1001	USA	200	1/4" NPT	Foot	x	SK230	816	836-0001	21849	SP1005-04	834	SP1005-04	SP2700-50	SP2600-04	SP2600-09	9527-0001	2574	9336	6594-200	7424-0000	
7870-201	UK	200	1/2" BSP	Foot	x	SK230	816	836-0001	21849	SP1005-04	834	SP1005-04	SP2700-50	SP2600-04	SP2600-09	9527-0001	2574	9336	6594-200	7424-0000	
7870-221	UK	200	1/2" BSP	Foot	x	SK230	816	836-0001	21849	SP1005-04	834	SP1005-04	SP2700-50	SP2600-04	SP2600-09	9527-0001	2574	9336	6594-200	7424-0000	
7870-231	UK	200	1/2" BSP	Foot	x	SK230	816	836-0001	21849	SP1005-04	834	SP1005-04	SP2700-50	SP2600-04	SP2600-09	9527-0001	2574	9336	6594-200	7424-0000	
7870-251	UK	200	1/2" BSP	Foot	x	SK230	816	836-0001	21849	SP1005-04	834	SP1005-04	SP2700-50	SP2600-04	SP2600-09	9527-0001	2574	9336	6594-200	7424-0000	
8150-0211	USA	080	2" / Flanged	Flange		90118-0001	7478-6000	17935-0001	6408-0000	91045-0420	7486-0010	91012-0020	917-0000	92600-0040	92700-0740	92600-0040	7476-0000	12073-0010	12073-0010	12073-0010	Proprietary
8170-9001	USA	080	1" / NPT	Flange		90177-0001	3101-0000	17937-0001	96080-0080	91003-0010	3255-0000	91004-0110	913-0000	92600-0060	---	---	Obsolète	4156-0000	11831-0000	11831-0000	Obsolète
8470-0711	USA	080	1/2" Hose	Flange		90177-0001	8509-0001	3085-0001	96080-0080	91003-0010	8528-0000	91003-0010	93000-0090	92600-0350	---	---	Obsolète	8493-0000	12065-0000	12065-0000	Obsolète
8470-0911	USA	080	1/2" Hose	Flange		90177-0001	8509-0001	3085-0001	96080-0080	91003-0010	8528-0000	91003-0010	93000-0090	92600-0350	---	---	Obsolète	8493-0000	12065-0000	12065-0000	Obsolète
8740F	USA	040	Dual 1/2" Hose	Flange		8444-0001(2)		8444-0001(2)		SP1002-01	6148	SP1002-01	---	---	---	---	---	---	---	---	Obsolète
8830-0701	USA	080	1" Hose	Flange		90177-0121	8641-0000	3085-0001	92700-0060	91026-0010	8528-0000	91030-0110	93000-0070	92600-0070	---	---	Obsolète	8493-0000	12062-0000	12062-0000	Obsolète
8830-0711	USA	080	1" Hose	Flange		90177-0121	8641-0000	3085-0001	92700-0060	91026-0010	8528-0000	91030-0110	93000-0070	92600-0070	---	---	Obsolète	8493-0000	12062-0000	12062-0000	Obsolète
8850-0001	USA	005		Flange		90092-0007	7828-0000	14750-0001	93000-0100	91026-0010	8528-0000	91030-0110	93000-0070	92600-0070	---	---	Obsolète	8493-0000	12062-0000	12062-0000	Obsolète
8950-0001	USA	200	1/2" Flanged	Flange		SK92-11	816-0000	17935-0001	6408-0000	91005-0060	834-0001	91005-0040	694-0000	92600-0040	---	---	8957-0000	2574-0000	12062-0000	12062-0000	8954-0000
9040-0511	UK	005	1/2" Hose	Flange		SK92-11	7828-01	14609-0001	SP3000-10	SP1002-09	8089	SP1002-01	---	---	---	---	---	---	---	---	9044
9360	UK	010	1/4" BSP	Foot	x	SK223	1126	4528-0001	AL22	SP8019-01	AL8-01	SP1002-02	---	---	---	---	---	---	---	---	AL4-200
9380	UK	040	1/4" BSP	Flange	x	SK33	3298	1210-0001	SP2701-21	SP1002-02	3269	SP1003-01	SP2700-13	SP2600-13	SP2600-13	5857	3266	3991	3374-200	3374-200	

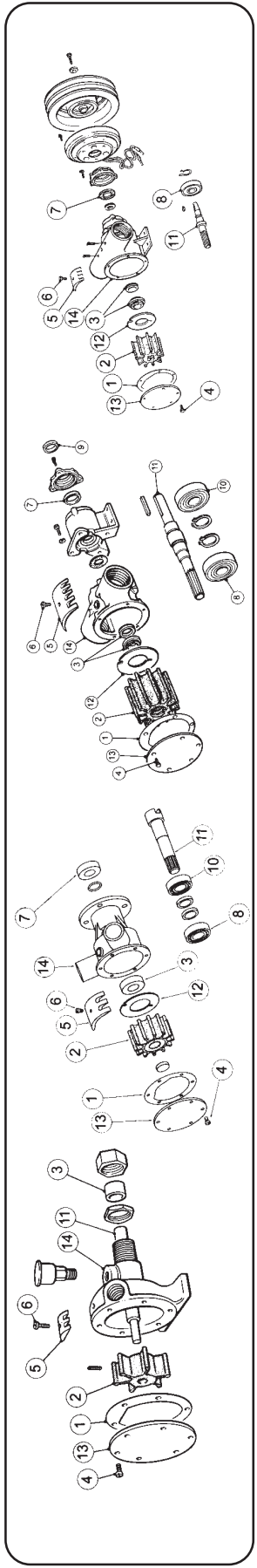

Service Parts - Flexible Impeller Pumps Spares by Pump Model 6590-200 to 9380

Service Parts -

Flexible Impeller Pumps Spares by Pump Model 9400 to 9900

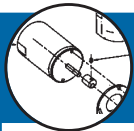

JABSCO PUMP DETAILS				SERVICE KIT DETAILS				GENERAL PARTS LISTING														
Pump Number	Origin	Pump Size	Port Type	Mount Type	Alternate Part No	Kit Number	Key	Gasket/O-ring	Impeller	Water Seal	End Cover Screws	Cam	Cam Screw	Pump End Oil Seal	Pump End Bearing	Drive End Oil Seal	Drive End Bearing	Shaft	Wearplate	Endcover	Body	
									*Data supply only													*Data supply only
9400	UK	020	Ø 16 Hose	Flange	X	SK211	10817	673-0001	SP2701-04	SP1002-09	2907-0001	SP1002-09	SP1002-09	---	---	---	---	9407	---	9406	9404	
9400-01	UK	020	Ø 16 Hose	Flange	X	SK211	10817	673-0001	SP2701-04	SP2701-04	2907-0001	SP1002-09	SP1002-09	---	---	---	---	9407	---	9406-01	9404-01	
9400-200	UK	020	2" BSP	Foot	X	SK211	10817	673-0001	SP2701-04	SP2701-04	2907-0001	SP1002-09	SP1002-09	---	---	---	---	9407	---	9406-01	9404-01	
9430	UK	010	1/4" BSP	Flange	X	SK221	1126	4528-0001	SP2701-09	SP2701-09	AL8	SP1002-09	SP1002-09	---	---	---	---	9436	---	AL6-200	4784	
9430-01	UK	010	1/4" BSP	Flange	X	SK221	1126	4528-0001	SP2701-09	SP2701-09	AL8	SP1002-09	SP1002-09	---	---	---	---	10303	---	AL6-200	10302	
9430-21	UK	010	1/4" BSP	Flange	X	SK221	1126	4528-0001	SP2701-09	SP2701-09	AL8	SP1002-09	SP1002-09	---	---	---	---	10467	---	AL6-200	4784	
9430-211	UK	010	1/4" BSP	Flange	X	SK221	1126	4528-0001	SP2701-09	SP2701-09	AL8	SP1002-09	SP1002-09	---	---	---	---	22287	---	AL6-200	4784	
9430-51	UK	010	1/4" BSP	Flange	X	SK221	1126	4528-0001	SP2701-09	SP2701-09	AL8-01	SP1002-09	SP1002-09	---	---	---	---	9436	---	9435-51	4784	
9440-200	UK	500	2" BSP	Foot	X	SK207	3209	2999-0001	9309	SP1006-05	9446	SP1006-03	SP2700-58	SP2600-16	SP2600-15	SP2600-15	SP2600-15	3207	9316	9448	9444	
9480-01	UK	500	2" BSP	Foot	X	SK29	3209	2999-0001	3222	SP1006-05	9446	SP1006-03	SP2700-58	SP2600-16	SP2600-15	SP2600-15	SP2600-15	3207	9316	9448	9444	
9560	UK	010	1/4" BSP	Flange	U	SK23	1189	4528-0001	SP2701-14	SP1003-01	2763	SP1002-03	---	---	---	---	---	Contact Man.	2765	9566	9564	
9700	UK	080	1" Flanged	Flange	X	SK238	890	17937-0001	22645-0000	SP1003-01	3255	SP1004-11	SP2700-48	---	---	---	---	9707	---	3993	9704	
9700-01	UK	080	1" Flanged	Flange	X	SK238	890	17937-0001	22645-0000	SP1003-01	3255	SP1004-11	SP2700-48	---	---	---	---	9707	---	3993	9704-01	
9700-04	UK	080	1" Flanged	Flange	X	SK238-01	3101	17937-0001	22645-0000	SP1003-01	934	SP1004-09	SP2700-48	---	---	---	---	9707	---	3993	9704-01	
9700-05	UK	080	1" Flanged	Flange	X	SK238-21	2432	17937-0001	22645-0000	SP1003-01	2431	SP1004-10	SP2700-48	---	---	---	---	9707	---	3993	9704-01	
9700-101	UK	080	1" BSP	Flange	X	SK238	890	17937-0001	22645-0000	SP1003-01	2431	SP1004-10	SP2700-48	---	---	---	---	9707	---	3993	9704-01	
9700-151	UK	080	1" Flanged	Flange	X	SK238	890	17937-0001	22645-0000	SP1003-01	934	SP1004-09	SP2700-48	---	---	---	---	9707	---	3993	9704-01	
9700-131	UK	080	1" Flanged	Flange	X	SK238	890	17937-0001	22645-0000	SP1003-01	934	SP1004-09	SP2700-48	---	---	---	---	9707	---	3993	9704-01	
9700-141	UK	080	1" Flanged	Flange	X	SK238	890	17937-0001	22645-0000	SP1003-01	934	SP1004-09	SP2700-48	---	---	---	---	9707	---	3993	9704-01	
9700-151	UK	080	1" Flanged	Flange	X	SK238-01	3101	17937-0001	22645-0000	SP1003-01	3255	SP1004-11	SP2700-48	---	---	---	---	9707	---	3993	9704-01	
9700-162	UK	080	1" Flanged	Flange	X	SK238	890	17937-0001	22645-0000	SP1003-01	934	SP1004-09	SP2700-48	---	---	---	---	9707	---	3993	9704-01	
9700-171	UK	080	1" Flanged	Flange	X	SK238	890	17937-0001	22645-0000	SP1003-01	3255	SP1004-11	SP2700-48	---	---	---	---	9707	---	3993	9704-01	
9700-181	UK	080	1" Flanged	Flange	X	SK238	890	17937-0001	22645-0000	SP1003-01	934	SP1004-09	SP2700-48	---	---	---	---	9707	---	3993	9704-01	
9700-201	UK	080	1" Flanged	Flange	X	SK238	890	17937-0001	22645-0000	SP1003-01	934	SP1004-09	SP2700-48	---	---	---	---	9707	---	3993	9704-01	
9700-21	UK	080	1" Flanged	Flange	X	SK238	890	17937-0001	22645-0000	SP1003-01	934	SP1004-09	SP2700-48	---	---	---	---	9707	---	3993	9704-01	
9700-241	UK	080	1/2" BSP	Flange	X	SK238-21	2432	17937-0001	22645-0000	SP1003-01	934	SP1004-09	SP2700-48	---	---	---	---	9707	---	3993	9704-01	
9700-41	UK	080	1" Flanged	Flange	X	SK238-21	2432	17937-0001	22645-0000	SP1003-01	2431	SP1004-10	SP2700-48	---	---	---	---	9707	---	3993	9704-01	
9700-51	UK	080	1" Flanged	Flange	X	SK238	890	17937-0001	22645-0000	SP1003-01	934	SP1004-09	SP2700-48	---	---	---	---	9707	---	3993	9704-01	
9700-61	UK	080	1" Flanged	Flange	X	SK238	890	17937-0001	22645-0000	SP1003-01	3255	SP1004-11	SP2700-48	---	---	---	---	9707	---	3993	9704-01	
9700-71	UK	080	1" Flanged	Flange	X	SK238	890	17937-0001	22645-0000	SP1003-01	934	SP1004-09	SP2700-48	---	---	---	---	9707	---	3993	9704-01	
9710	UK	080	1" NPT	Foot	X	SK229	890	17937-0001	22617-0010	SP1003-09	934	SP1004-09	SP2701-21	SP2600-38	SP2700-47	SP2600-38	SP2700-47	9717	---	3993	10329	
9710-200	UK	080	1" BSP	Foot	X	SK229	890	17937-0001	22617-0010	SP1003-09	934	SP1004-09	SP2701-21	SP2600-38	SP2700-47	SP2600-38	SP2700-47	9717	---	3993	10329-200	
9710-201	UK	080	1" BSP	Foot	X	SK229	890	17937-0001	22617-0010	SP1003-09	934	SP1004-09	SP2701-21	SP2600-38	SP2700-47	SP2600-38	SP2700-47	9717	---	3993	10329-200	
9710-204	UK	080	1" BSP	Foot	X	SK229	890	17937-0001	22617-0010	SP1003-09	3255	SP1004-11	SP2701-21	SP2600-38	SP2700-47	SP2600-38	SP2700-47	9717	---	3993	10329-200	
9710-205	UK	080	1" BSP	Foot	X	SK229-01	2432	17937-0001	22617-0010	SP1003-09	2431	SP1004-10	SP2701-21	SP2600-38	SP2700-47	SP2600-38	SP2700-47	9717	---	3993	10329-200	
9710-210	UK	080	1" BSP	Foot	X	SK229	890	17937-0001	22617-0010	SP1003-09	3255	SP1004-11	SP2701-21	SP2600-38	SP2700-47	SP2600-38	SP2700-47	9717	---	3993	10329-200	
9720	UK	080	Ø 32 Hose	Flange	X	SK269	890-01	17937-0001	22626-0000	SP1003-09	890	SP1004-09	SP2700-07	SP2600-01	SP2600-01	SP2600-01	SP2600-01	9737	---	3993	9734	
9750	UK	080	Ø 32 Hose	Flange	X	SK269	3101-01	17937-0001	22626-0000	SP1003-09	3255	SP1004-11	SP2700-07	SP2600-01	SP2600-01	SP2600-01	SP2600-01	9757	---	3993	9754	
9760	UK	080	Ø 32 Hose	Flange	X	SK269	890-01	17937-0001	22626-0000	SP1003-09	890	SP1004-11	SP2700-07	SP2600-01	SP2600-01	SP2600-01	SP2600-01	9767	---	3993	9754	
9770-200	UK	080	1/2" BSP	Barrel	X	SK229	890	17937-0001	22626-0000	SP1003-09	934	SP1004-09	SP2701-21	SP2600-38	SP2700-47	SP2600-38	SP2700-47	9777	---	3993	9774	
9770-205	UK	080	1/2" BSP	Barrel	X	SK229	890	17937-0001	22626-0000	SP1003-09	2431	SP1004-10	SP2701-21	SP2600-38	SP2700-47	SP2600-38	SP2700-47	9777	---	3993	9774	
9900	UK	020	Ø 16 Hose	Foot	X	SK211	10817	673-0001	SP2701-04	SP1002-09	10818	SP1002-02	---	---	---	---	9907	---	9905	9904		

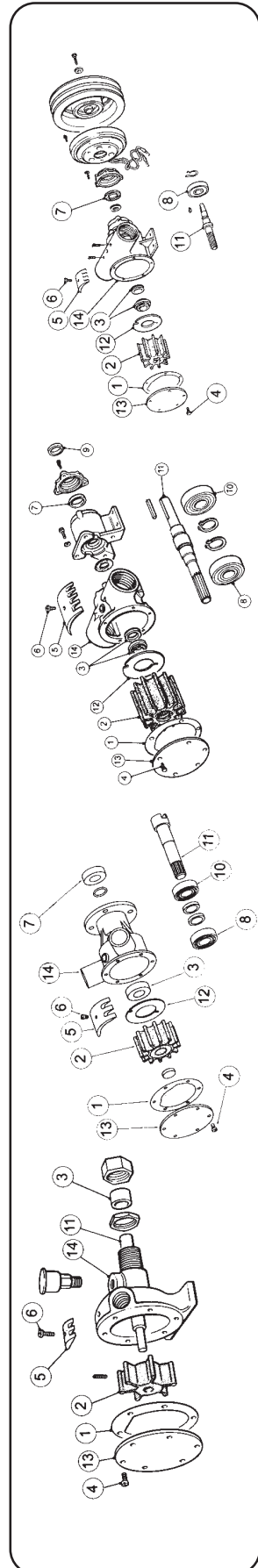

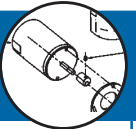

JABSCO PUMP DETAILS			SERVICE KIT DETAILS				GENERAL PARTS LISTING														
Pump Number	Origin	Pump Size	Port Type	Mount Type	Alternate Part No	Kit Number	Gasket/O-ring	Impeller	Water Seal	End Cover Screws	Cam	Cam Screw	Pump End Oil Seal	Pump End Bearing	Drive End Oil Seal	Drive End Bearing	Shaft	Wearplate	Endcover	Body	
						Key															* OEM supply only
9900-0001	USA	020	1/2" Hose	Flange		90211-0001	10187-0000	18673-0001	92701-0040	91002-0090	10818-0000	91002-0020	SP2701-21	SP2600-13	---	---	9907-0000	---	9905-0000	9904-0000	
9970-200	UK	040	1/2" BSP	Flange		SK229	3298	1210-0001	22617-0010	SP1002-02	490	SP1003-01	SP2701-21	SP2600-13	---	---	9977	7883	3992	9974-200	
9970-204	UK	040	1/2" BSP	Flange		SK239	3298	1210-0001	22617-0010	SP1002-02	10336	SP1003-09	SP2701-21	SP2600-13	---	---	9977	7883	3992	9974-200	
9970-241	UK	040	1/2" BSP	Flange	Direct Cooling	SK241	3298	1210-0001	22617-0010	SP1002-02	490	SP1003-01	SP2701-21	SP2600-13	---	---	10374	7883	3992	9974-200	
9970-241-37	UK	040	1/2" BSP	Flange		SK239-37	3298	1210-0003	22617-0010	SP1002-02	490	SP1003-01	SP2701-21	SP2600-13	---	---	10374	7883	3992	9974-200	
9970-251	UK	040	1/2" BSP	Flange		SK239	3298	1210-0001	22617-0010	SP1002-02	10336	SP1003-09	SP2701-21	SP2600-13	---	---	10374	7883	3992	9974-200	
9970-261	UK	040	1/2" BSP	Flange		SK239	3298	1210-0001	22617-0010	SP1002-02	490	SP1003-01	SP2701-21	SP2600-13	---	---	9977-21	7883	3992	9974-201	
9970-271	UK	040	1/2" BSP	Flange		SK239	3298	1210-0001	22617-0010	SP1002-02	10336	SP1003-09	SP2701-21	SP2600-13	---	---	9977-21	7883	3992	9974-223	
9970-281	UK	040	1/2" BSP	Flange		SK239	3298	1210-0001	22617-0010	SP1002-02	490	SP1003-01	SP2701-21	SP2600-13	---	---	9977	7883	3992	9974-223	
9990-200	UK	040	1/2" NPT	Barrel		SK239	3298	1210-0001	22617-0010	SP1002-02	490	SP1003-01	SP2701-15	SP2601-39	---	---	10417	7883	3992	9974-200	
9990-201	UK	040	1/2" NPT	Barrel		SK239	3298	1210-0001	22617-0010	SP1002-02	490	SP1003-01	SP2701-21	SP2601-39	---	---	9997	7883	3992	9974-200	
9990-21	UK	040	1/2" NPT	Barrel		SK268	3298	1210-0001	22617-0010	SP1002-02	490	SP1003-01	SP2701-15	SP2601-39	---	---	9997	9996	3992	9994-21	
9990-41	UK	040	1/2" NPT	Barrel		SK268	3298	1210-0001	22617-0010	SP1002-02	490	SP1003-01	SP2701-15	SP2601-39	---	---	9997-01	7883	3992	9994-21	
10170-0011	USA	040	1" Hose	Flange		90133-0001	10183-0000	1210-0001	96080-0080	91003-0020	490-0000	91003-0070	92700-0480	92600-0060	---	---	---	Obsolete	Obsolete	Obsolete	
10170-0011	USA	080	1-1/4" Hose	Flange			10184-0000	11979-0001	---	---	10182-0000	91004-0090	---	---	---	---	---	---	---	---	
Dual 10190-0011	USA	040	1" Hose	Flange			10183-0000	1210-0001	96080-0080	91003-0020	490-0000	91003-0070	92700-0480	92600-0060	---	---	10197-0000	10179-0000	22907-0000	10195-0010	
Dual 10420	UK	040	1" Hose	Flange			---	3085-0001	---	---	---	---	---	---	---	---	---	---	---	---	
10490	UK	020	Ø 16 Hose	Flange	29490-2001C	SK211	10817	672-0001	SP2701-04	SP1002-09	2907-0001	SP1002-09	---	---	---	10427	---	---	9905	10424	
10490-0201	UK	020	2" Flanged	Foot		SK254	816	21676-0001	21849	SP1005-04	6988	SP1005-04	SP2700-49	SP2601-37	---	---	11254-01	2574	9936	10494	
10490-07	UK	020	2" Flanged	Foot		SK254	816	21676-0001	21849	SP1005-04	6988	SP1005-04	SP2700-49	SP2601-37	---	---	11254-01	2574	9936	10494-03	
10490-207	UK	020	2" Flanged	Foot		SK254	816	21676-0001	21849	SP1005-04	6988	SP1005-04	SP2700-49	SP2601-37	---	---	11254-01	2574	9936	10494	
10550-01	UK	040	1/2" NPT	Foot		SK239	3298	1210-0001	22626-0000	SP1002-02	10336	SP1003-09	SP2701-21	SP2601-39	---	---	10417	7883	3992	10554	
10550-200	UK	040	1/2" BSP	Foot		SK239	3298	1210-0001	22626-0000	SP1002-02	490	SP1003-01	SP2701-21	SP2601-39	---	---	10417	7883	3992	10554	
10550-205	UK	040	1/2" BSP	Foot		SK239	3298	1210-0001	22626-0000	SP1002-02	10336	SP1003-09	SP2701-15	SP2601-39	---	---	10417	7883	3992	10554	
10550-2103	UK	040	1/2" BSP	Foot		SK239-0003	3298	1210-0003	22626-0000	X3001-095F	490	SP1003-01	SP2701-15	SP2601-39	---	---	10417-2100	22906-0000	22907-0000	10554-2100	
10550-2701	UK	040	1/2" BSP	Foot		SK239	3298	1210-0001	22626-0000	SP1002-02	490	SP1003-01	SP2701-15	SP2601-39	---	---	10417	7883	3992	10974	
10590	UK	020	2" Flanged	Flange		SK254	816	21676-0001	21849	SP1005-04	6988	SP1005-04	SP2701-54	SP2601-37	---	---	11258-01	2574	9336	10494	
10590-0031	UK	020	2" Flanged	Flange		SK254	816	21676-0001	21849	SP1005-04	22039	SP1005-05	SP2701-54	SP2601-37	---	---	11258-01	2574	9336	10494	
10590-0041	UK	020	2" Flanged	Flange		SK254	816	21676-0001	21849	SP1005-04	22268	SP1005-05	SP2701-54	SP2601-37	---	---	11258-01	2574	9336	10494	
10590-01	UK	020	2" Flanged	Flange		SK254	816	21676-0001	21849	SP1005-04	6988	SP1003-09	SP2701-21	SP2601-39	---	---	10417	7883	3992	10494	
10590-0111	UK	020	2" Flanged	Flange		SK254	816	17936-0001	21849	SP1095-0640	6988	SP1005-04	SP2701-54	SP2601-37	---	---	11256-01	2574	9336	10494	
10590-0141	UK	020	2" Flanged	Flange		SK254	816	21676-0001	21849	SP1005-04	22268	SP1005-05	SP2701-54	SP2601-37	---	---	11258-01	2574	9336	10494	
10590-0201	UK	020	2" Flanged	Flange		SK254	816	21676-0001	21849	SP1005-04	6988	SP1003-09	SP2701-21	SP2601-37	---	---	11256-01	2574	9336	10494	
10590-0231	UK	020	2" Flanged	Flange		SK254	816	17936-0001	96080-0373	SP1095-0640	22039	SP1005-04	SP2700-49	SP2601-37	---	---	11256-01	2574	9336	10494	
10590-0341	UK	020	2" Flanged	Flange		SK254	816	17936-0001	96080-0373	SP1095-0640	6988	SP1005-04	SP2701-54	SP2601-37	---	---	11256-01	2574	10773	10494	
10590-21	UK	020	2" Flanged	Flange		SK254	816	21676-0001	21849	SP1005-04	6988	SP1005-04	SP2701-54	SP2601-37	---	---	11258-01	2574	9336	10494	

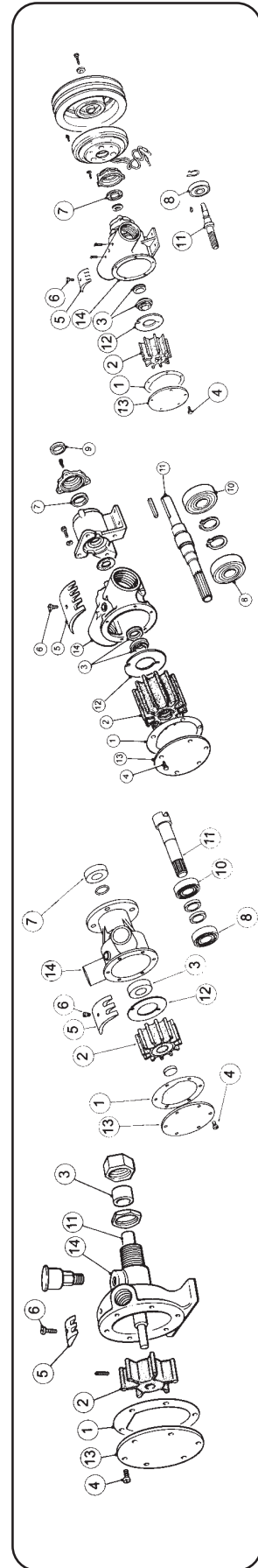

Service Parts - Flexible Impeller Pumps Spares by Pump Model 9900-0001 to 10590-21

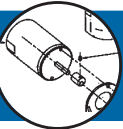

10

www.jabasco.com



Service Parts - Flexible Impeller Pumps Spares by Pump Model 10590-22 to 10770-62

JABSCO PUMP DETAILS				SERVICE KIT DETAILS				GENERAL PARTS LISTING														
Pump Number	Origin	Pump Size	Port Type	Mount Type	Alternate Part No	Kit Number	Key	Gasket/O-ring	Impeller	Water Seal	End Cover Screws	Cam	Cam Screw	Pump End Oil Seal	Pump End Bearing	Drive End Oil Seal	Drive End Bearing	Shaft	Wearplate	Endcover	Body	
																						* OEM supply only
10590-22	UK	270	2/Flanged	Flange	2 Pumps/Eng.	SK254	816	21676-0001	21849	SP1005-04	6988	SP1005-04	SP2701-54	SP2601-37	SP2601-41	11258-01	2574	9336	10494	10494		
10590-61	UK	270	2/Flanged	Flange	x 10590-62	SK254	816	21676-0001	21849	SP1005-04	6988	SP1005-04	SP2701-54	SP2601-37	SP2601-41	11258-01	2574	9336	10494	10494		
10590-62	UK	270	2/Flanged	Flange		SK254	816	21676-0001	21849	SP1005-04	6988	SP1005-04	SP2701-54	SP2601-37	SP2601-41	11258-01	2574	9336	10494	10494		
10590-63	UK	270	2/Flanged	Flange		SK254	816	21676-0001	21849	SP1005-04	6988	SP1005-04	SP2701-54	SP2601-37	SP2601-41	11258-01	2574	9336	10494	10494		
10630	UK	200	1/1/2 Flanged	Foot	x 52220-0011	SK230	816	836-0001	21849	SP1005-04	834	SP1005-04	SP2701-54	SP2700-49	SP2601-37	11254	2574	9336	10634	10634		
10630-01	UK	200	1/1/2 Flanged	Foot	x 52220-0011	SK230	816	836-0001	21849	SP1005-04	834	SP1005-04	SP2701-54	SP2700-49	SP2601-37	11254	2574	9336	10634	10634		
10630-07	UK	200	1/1/2 Flanged	Foot	x 52220-0011	SK230	816	836-0001	21849	SP1005-04	834	SP1005-04	SP2701-54	SP2700-49	SP2601-37	11254	2574	9336	10634	10634		
10630-200	UK	200	1/1/2 Flanged	Foot	x 52220-0011	SK230	816	836-0001	21849	SP1005-04	834	SP1005-04	SP2701-54	SP2700-49	SP2601-37	11254	2574	9336	10634	10634		
10630-207	UK	200	1/1/2 Flanged	Foot	x 52220-0011	SK230	816	836-0001	21849	SP1005-04	834	SP1005-04	SP2701-54	SP2700-49	SP2601-37	11254	2574	9336	10634	10634		
10630-57	UK	200	1/1/2 Flanged	Flange	x 52220-0011	SK230	816	836-0001	21849	SP1005-04	2551	SP1005-05	SP2701-54	SP2700-49	SP2601-37	11254	2574	9336	10634	10634		
10650	UK	200	1/1/2 Flanged	Foot	x 51220-0011	SK230	816	836-0001	21849	SP1005-04	834	SP1005-04	SP2701-54	SP2601-37	SP2601-37	10657-0020	2574	9336	10634	10634		
10650-200	UK	200	1/1/2 Flanged	Foot	x 51200-2011	SK230	816	836-0001	21849	SP1005-04	834	SP1005-04	SP2701-54	SP2601-37	SP2601-37	10657-0020	2574	9336	10634	10634		
10660	UK	270	2/Flanged	Foot	x 51270-0011	SK254	816	17936-0001	21849	SP1005-04	6988	SP1005-04	SP2701-54	SP2601-37	SP2601-37	10657-0030	2574	9336	10494	10494		
10660-200	UK	270	2/Flanged	Foot	x 51270-2011	SK254	816	17936-0001	21849	SP1005-04	6988	SP1005-04	SP2701-54	SP2601-37	SP2601-37	10657-0030	2574	9336	10494	10494		
10670	UK	200	1/1/2 Flanged	Foot	x 50220-0011	SK230-01	816	836-0001	21849	SP1005-04	834	SP1005-04	SP2701-54	SP2601-37	SP2601-37	10667-0020	2574	9336	10634-02	10634-02		
10670-01	UK	200	1/1/2 Flanged	Foot	x 50220-0111	SK230-01	816	836-0001	21849	SP1005-04	834	SP1005-04	SP2701-54	SP2601-37	SP2601-37	10667-0020	2574	9336	10634-02	10634-02		
10670-10	UK	200	1/1/2 Flanged	Foot	x 50220-0211	SK230-01	816	836-0001	21849	SP1005-04	834	SP1005-04	SP2701-54	SP2601-37	SP2601-37	10667-0020	2574	9336	10634-02	10634-02		
10670-11	UK	200	1/1/2 Flanged	Foot	x 50220-0311	SK230-01	816	836-0001	21849	SP1005-04	834	SP1005-04	SP2701-54	SP2601-37	SP2601-37	10667-0020	2574	9336	10634-02	10634-02		
10670-200	UK	200	1/1/2 Flanged	Foot	x 50200-2011	SK230-01	816	836-0001	21849	SP1005-04	834	SP1005-04	SP2701-54	SP2601-37	SP2601-37	10667-0020	2574	9336	10634-02	10634-02		
10670-201	UK	200	1/1/2 Flanged	Foot	x 50200-2111	SK230-01	816	836-0001	21849	SP1005-04	834	SP1005-04	SP2701-54	SP2601-37	SP2601-37	10667-0020	2574	9336	10634-02	10634-02		
10670-210	UK	200	1/1/2 Flanged	Foot	x 50200-2211	SK230-01	816	836-0001	21849	SP1005-04	834	SP1005-04	SP2701-54	SP2601-37	SP2601-37	10667-0020	2574	9336	10634-02	10634-02		
10670-211	UK	200	1/1/2 Flanged	Foot	x 50200-2311	SK230-01	816	836-0001	21849	SP1005-04	834	SP1005-04	SP2701-54	SP2601-37	SP2601-37	10667-0020	2574	9336	10494-01	10494-01		
10680	UK	270	2/Flanged	Foot	x 50270-0011	SK254	816	21676-0001	21849	SP1005-04	6988	SP1005-04	SP2701-54	SP2601-37	SP2601-37	10667-0030	2574	9336	10494-01	10494-01		
10680-01	UK	270	2/Flanged	Foot	x 50270-0111	SK254	816	21676-0001	21849	SP1005-04	6988	SP1005-04	SP2701-54	SP2601-37	SP2601-37	10667-0030	2574	9336	10494-01	10494-01		
10680-10	UK	270	2/Flanged	Foot	x 50270-0211	SK254	816	21676-0001	21849	SP1005-04	6988	SP1005-04	SP2701-54	SP2601-37	SP2601-37	10667-0030	2574	9336	10494-01	10494-01		
10680-11	UK	270	2/Flanged	Foot	x 50270-0311	SK254	816	21676-0001	21849	SP1005-04	6988	SP1005-04	SP2701-54	SP2601-37	SP2601-37	10667-0030	2574	9336	10494-01	10494-01		
10680-200	UK	270	2/Flanged	Foot	x 50270-2011	SK254	816	21676-0001	21849	SP1005-04	6988	SP1005-04	SP2701-54	SP2601-37	SP2601-37	10667-0030	2574	9336	10494-01	10494-01		
10680-201	UK	270	2/Flanged	Foot	x 50270-2111	SK254	816	21676-0001	21849	SP1005-04	6988	SP1005-04	SP2701-54	SP2601-37	SP2601-37	10667-0030	2574	9336	10494-01	10494-01		
10680-210	UK	270	2/Flanged	Foot	x 50270-2211	SK254	816	21676-0001	21849	SP1005-04	6988	SP1005-04	SP2701-54	SP2601-37	SP2601-37	10667-0030	2574	9336	10494-01	10494-01		
10680-211	UK	270	2/Flanged	Foot	x 50270-2311	SK254	816	21676-0001	21849	SP1005-04	6988	SP1005-04	SP2701-54	SP2601-37	SP2601-37	10667-0030	2574	9336	10494-01	10494-01		
10770-0051	UK	200	1/1/2 Flanged	Flange		SK369-0001	816	836-0001	21849	SP1095-0640	2551	SP1095-0640	SP2701-54	SP2601-37	SP2601-37	11258	2574	9336	10634	10634		
10770-0151	UK	200	1/1/2 Flanged	Flange	x	SK369-0001	816	836-0001	21849	SP1095-0640	2551	SP1095-0640	SP2701-54	SP2601-37	SP2601-37	11258	2574	9336	23704-0000	23704-0000		
10770-0331	UK	200	1/1/2 Flanged	Flange		SK369-0001	816	836-0001	21849	SP1095-0640	29772-0000	SP2701-54	SP2601-37	SP2601-37	SP2601-37	11258	2574	9336	10584-03	10584-03		
10770-0351	UK	200	1/1/2 Flanged	Flange		SK369-0001	816	836-0001	21849	SP1095-0640	2551	SP1095-0640	SP2701-54	SP2601-37	SP2601-37	11258	2574	9336	23704-0000	23704-0000		
10770-0531	UK	200	1/1/2 Flanged	Flange		SK369-0001	816	836-0001	96080-0373	SP1095-0640	29772-0000	SP1095-0640	SP2701-54	SP2601-37	SP2601-37	11258	2574	9336	23704-0000	23704-0000		
10770-07	UK	200	1/1/2 Flanged	Flange		SK230-01	816	836-0001	96080-0373	SP1095-0640	2551	SP1095-0640	SP2701-54	SP2601-37	SP2601-37	11258	2574	10773	10634	10634		
10770-57	UK	200	1/1/2 Flanged	Flange		SK230-01	816	836-0001	21849	SP1005-04	2551	SP1005-05	SP2701-54	SP2601-37	SP2601-37	11256	2574	9336	10634	10634		
10770-62	UK	200	1/1/2 Flanged	Flange	x	SK230-01	816	836-0001	21849	SP1005-04	2551	SP1005-05	SP2701-54	SP2601-37	SP2601-37	21679-0000	2574	9336	10634	10634		

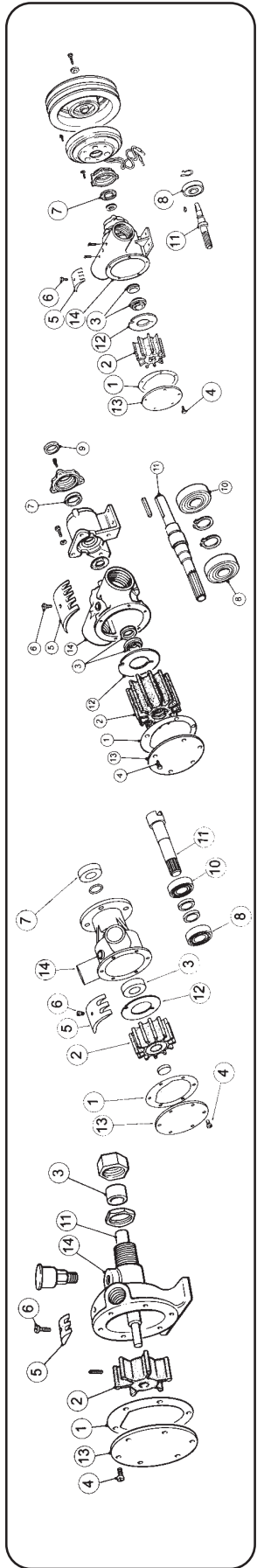

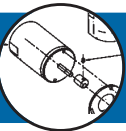

Service Parts - Flexible Impeller Pumps Spares by Pump Model 11150-0011 to 11860-0006

JABSCO PUMP DETAILS				SERVICE KIT DETAILS				GENERAL PARTS LISTING													
Pump Number	Origin	Pump Size	Port Type	Mount Type	Alternate Part No	Osloire	Kit Number	Gasket/O Ring	Impeller	Water Seal	End Cover Screws	Cam	Cam Screw	Pump End Oil Seal	Pump End Bearing	Drive End Oil Seal	Drive End Bearing	Shaft	Wearplate	Endcover	Body
							Key	1	2	3	4	5	6	7	8	9	10	11	12	13	14
11150-0011	UK	200	2" Flanged	Foot			SK254	816	21676-0001	21849	SP1005-04	6988	SP1005-04	SP2701-54	SP2601-37	SP2601-37	SP2601-37	11254-01	2574	9336	11104
11260-200	UK	010	1/4" BSP	Flange	29300-2101C	x	SK266	1126	4528-0001	SP2701-04	AL8	SP1002-01	SP1002-01	AL8	---	---	---	11227	---	AL6-200	11264-200
11260-205	UK	010	1/4" BSP	Flange	29300-2151C	x	SK266	1126	4528-0001	SP2701-04	AL8-01	SP1002-01	SP1002-01	AL8-01	---	---	---	11227	---	AL6-200	11264-200
11260-2101	UK	010	#/8" BSP	Flange	29300-2201C	x	SK266	1126	4528-0001	SP2701-04	AL8	SP1002-01	SP1002-01	AL8	---	---	---	11227	---	AL6-200	11264-2100
11260-211	UK	010	1/4" BSP	Flange			SK266	1126	4528-0001	SP2701-04	AL8	SP1002-01	SP1002-01	AL8	---	---	---	11237	---	AL6-200	11264-2100
11260-2151	UK	010	#/8" BSP	Flange	29300-2151C	x	SK266	1126	4528-0001	SP2701-04	AL8-01	SP1002-01	SP1002-01	AL8-01	---	---	---	11127	---	AL6-200	11264-2100
11260-2211	UK	010	#/8" BSP	Flange			SK266	1126	4528-0001	SP2701-04	AL8	SP1002-01	SP1002-01	AL8	---	---	---	21537	---	AL6-200	11264-200
11410-200	UK	040	1/4" BSP	Foot	Blige Cooling	x	SK328	11415	1210-0001	22617-0010	SP1003-08	7876	SP1003-08	---	---	---	---	---	---	---	11414-200
11410-200 Dual	UK	080	1" BSP	Foot	Blige Cooling	x	SK328	890	17937-0001	22617-0010	SP1003-11	934	SP1004-09	SP2700-47	SP2600-38	SP2700-47	9717-21	7883	11416 (Div Pi)	10339-221	
11430-01	UK	010	1/4" BSP	Flange			SK272	11438	4528-0001	SP2700-11	SP1002-04	11436	SP1002-01	SP2701-22	---	---	---	11437	2765	11435	11434-01
11470-200	UK	020	Ø 16 Hose	Flange	Blige	x	SK325	11475	673-0001	22626-0000	SP1002-03	2907-0001	SP1002-09	---	---	---	---	---	---	---	11474
11470-200 Dual	UK	040	3/4" BSP	Flange	Blige Cooling	x	SK325	11476	1210-0001	22626-0000	SP1002-06	490	SP1003-01	SP2701-21	SP2600-13	---	---	11447	7883	11478 (Div Pi)	10974-221
11570-200	UK	020	Ø 16 Hose	Flange	Blige	x	SK325	11475	673-0001	22626-0000	SP1002-03	2907-0001	SP1002-09	---	---	---	---	---	---	---	11474
11570-200 Dual	UK	040	1/2" BSP	Flange	Blige Cooling	x	SK325	11476	1210-0001	22626-0000	SP1002-06	490	SP1003-01	SP2701-15	SP2601-39	---	---	11577	7883	11478 (Div Pi)	10554-221
11590-204	UK	040	1/2" BSP	Foot	Blige	x	SK285	11415	1210-0001	22645-0000	SP1003-08	7876	SP1003-01	---	---	---	---	---	---	---	11414-200
11590-204 Dual	UK	080	1" BSP	Foot	Blige Cooling	x	SK285	11593	17937-0001	22645-0000	SP1003-11	3255	SP1004-11	SP2700-48	---	---	---	9707-21	4156	11416 (Div Pi)	9704-21
11600	USA	080	1" NPT	Foot			SK299	890	17937-0001	22617-0010	SP1003-09	934	SP1004-09	SP2701-0940	---	---	---	11608	4156	3993	11604
11620-200	UK	010	1/4" BSP	Flange	22830-2101	x	SK23	1189	4528-0001	SP2701-11	SP1002-01	2763	SP1002-03	SP2700-63	---	---	---	1053-11	2765	9566	11624-200
11620-211	UK	010	1/4" BSP	Flange			SK23	1189	4528-0001	SP2701-11	SP1002-01	2763	SP1002-03	SP2700-63	---	---	---	1053-11	2765	9566	11624-200
11650-200	UK	010	#/8" BSP	Flange			SK266	1126	4528-0001	SP2701-04	AL8	SP1002-01	SP1002-01	AL8	---	---	---	11653	---	AL6-200	11654-200
11740-200	UK	040	1/2" BSP	Foot	Blige	x	SK300	11746	17937-0001	21849	SP1005-03	934	SP1005-04	---	---	---	---	---	---	---	10634
11740-200 Dual	UK	080	1" Flanged	Foot	Blige Cooling	x	SK300	816	836-0001	21849	SP1005-03	834	SP1005-04	SP2701-54	SP2601-37	SP2700-49	---	11749-0000	2574	11745 (Div Pi)	11744-200
11740-205	UK	080	1" BSP	Foot	Blige	x	SK300	11746	17937-0001	21849	SP1005-03	934	SP1004-09	---	---	---	---	---	---	---	10634
11740-205 Dual	UK	200	1 1/2" Flanged	Foot	Blige Cooling	x	SK300	816	836-0001	21849	SP1005-03	2551	SP1005-05	SP2700-49	SP2601-37	SP2700-49	---	11749-0000	2574	11745 (Div Pi)	11744-200
11790-01	UK	200	1 1/2" Flanged	Flange			SK230	816	836-0001	21849	SP1005-04	834	SP1005-04	SP2701-54	SP2601-37	SP2701-54	---	11796-0010	2574	9336	10584
11850-0101	USA	040	1" Hose	Flange			SK117-02	8641	1210-0001	SP6080-08	SP1026-01	8528	SP1030-0100	SP3000-0990	SP2601-41	---	---	11258	2574	9336	10584
11850-0701	UK	040	1" Hose	Flange			SK117-02	8641	1210-0001	SP6080-08	SP1026-01	8528	SP1030-0100	SP3000-0990	SP2601-41	---	---	11977-0010	8493	9176	11854-0410
11850-0711	USA	040	1" Hose	Flange			90117-0001	8641-0000	1210-0001	96080-0080	91026-0010	8528-0000	91030-0110	93000-0090	SP2600-070	---	---	11977-0000	8493-0000	12346-0000	11854-0410
11850-0711 Dual	USA	040	1" Hose	Foot			90117-0001	8641-0000	1210-0001	96080-0080	91026-0010	8528-0000	91030-0110	93000-0090	SP2600-070	---	---	11977-0000	8493-0000	12346-0000	11854-0410
11860-0001	USA	080	1" NPT	Foot			90118-0001	890-0000	920-0003	96080-0080	91003-0010	934-0000	91004-0090	913-0000	92600-0540	---	---	11867-0000	4156-0000	11831-0000	11864-0000
11860-0003	USA	080	1" NPT	Foot			90118-0003	890-0000	920-0003	96080-0080	91003-0010	934-0000	91004-0090	913-0000	92600-0540	---	---	11867-0000	4156-0000	11831-0000	11864-0000
11860-0004	USA	080	1" NPT	Foot			90118-0003	890-0000	920-0003	96080-0080	91003-0010	934-0000	91004-0090	913-0000	92600-0540	---	---	11867-0000	4156-0000	11831-0000	11864-0000
11860-0005	USA	080	1" NPT	Foot			90118-0003	890-0000	920-0003	96080-0080	91003-0010	934-0000	91004-0090	913-0000	92600-0540	---	---	11867-0000	4156-0000	11831-0000	11864-0000
11860-0006	USA	080	1" NPT	Foot			90118-0003	890-0000	920-0003	96080-0080	91003-0010	934-0000	91004-0090	913-0000	92600-0540	---	---	11867-0000	4156-0000	11831-0000	11864-0000

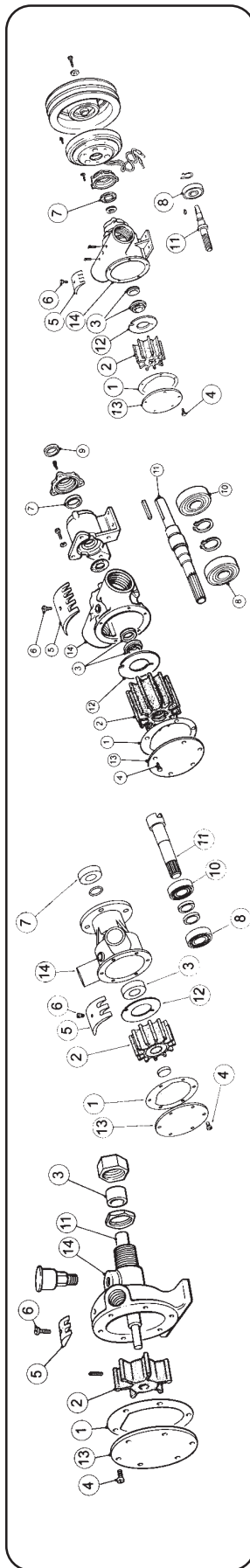

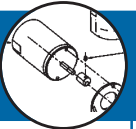

JABSCO PUMP DETAILS			SERVICE KIT DETAILS				GENERAL PARTS LISTING							Endcover					
Pump Number	Origin Pump Size	Port Type	Mount Type	Alternate Part No	Kit Number	Gasket/ O Ring	Impeller	Water Seal	End Cover Screws	Cam	Cam Screw	Pump End Oil Seal	Pump End Bearing	Drive End Oil Seal	Drive End Bearing	Shaft	Wearplate	Body	
					Key														* OEM supply only
11860-0007	USA	080	1"NPT	Foot	90118-0003	890-0000	920-0003	96080-0080	91003-0010	934-0000	91004-0090	913-0000	92600-0540	---	11867-0000	4156-0000	11831-0000	11864-0000	14
11870-0001	USA	200	1/2"NPT	Foot	90062-0003	816-0000	836-0003	6407-0010	91005-0040	834-0001	91004-0040	817-0000	92600-0040	---	11877-0000	2574-0000	12062-0000	18753-0585	
11870-0004	USA	200	1/2"NPT	Foot	90062-0003	816-0000	836-0003	6407-0010	91005-0040	834-0001	91004-0040	817-0000	92600-0040	---	11877-0000	2574-0000	12062-0000	18753-0585	
11870-0006	USA	200	1/2"NPT	Foot	90062-0003	816-0000	836-0003	6407-0010	91005-0040	834-0001	91004-0040	817-0000	92600-0040	---	11877-0000	2574-0000	12062-0000	18753-0585	
11870-0007	USA	200	1/2"NPT	Foot	90062-0003	816-0000	836-0003	6407-0010	91005-0040	834-0001	91004-0040	817-0000	92600-0040	---	11877-0000	2574-0000	12062-0000	18753-0585	
12050-0001	USA	080	1/2" Hose	Flange	90117-0121	8641-0080	3085-0001	92700-0180	91003-0090	8528-0000	91003-0110	92700-0060	92600-0070	---	12057-0000	8493-0000	12055-0000	12054-0000	
12280-0001	USA	080	Ø 32 Hose	Flange	90155-0001	12288-0000	17937-0001	96080-0080	91003-0010	---	913-0000	92600-0060	92600-0060	---	12294-0000	---	12294-0000	12284-0000	
12600-0001	USA	200	3" Hose	Flange	12608-0000	12608-0000	17935-0001	6408-0000	91005-0040	12176-0000	---	817-0000	92600-0040	---	12606-0000	12179-0000	12604-0000	12604-0000	
12600-0011	USA	200	3" Hose	Flange	12608-0000	12608-0000	17935-0001	6408-0000	91005-0040	12176-0000	---	817-0000	92600-0040	---	12606-0000	12179-0000	12604-0000	12604-0000	
12600-0021	USA	200	3" Hose	Flange	12608-0000	12608-0000	17935-0001	6408-0000	91005-0040	12176-0000	---	817-0000	92600-0040	---	12606-0000	12179-0000	12604-0000	12604-0000	
14210-0001	USA	040	1/2" Hose	Flange	90111-0001	3298-0000	1210-0001	96080-0080	91002-0020	6148-0040	91003-0070	913-0000	92600-0060	---	14217-0000	7038-0000	11830-0000	14214-0000	
14300-0001	USA	200	1/2" Flanged	Foot	---	816-0000	17935-0001	6408-0000	91005-0040	834-0001	91005-0040	92701-0180	92600-0260	92600-0260	92600-0460	14307-0000	12062-0000	10584-0000	
14320-0001	USA	040	---	---	90118-0001	10183-0000	1210-0001	96080-0080	91003-0010	490-0000	91003-0070	---	92600-0460	---	92600-0460	---	---	---	Obsolète
14420-0001	USA	080	1"NPT	Flange	---	890-0000	17937-0001	96080-0080	91003-0010	934-0000	91003-0010	913-0000	92600-0540	914-0000	6718-0000	4156-0000	11831-0000	798-0020	
14440-0001	USA	200	2" Flanged	Flange	---	816-0000	17935-0001	6408-0000	91005-0060	834-0001	91005-0040	92701-0060	92600-0260	---	92600-0260	2574-0000	12062-0000	12062-0000	
14620	USA	080	1" Hose	Flange	SK153	890	4598-0001	SP6080-08	SP1014-03	7867	SP1003-01	SP2700-48	SP2600-25	---	---	7868	14625	14622	
17030-0001	USA	080	1/2" Flanged	Flange	---	3101-0000	17937-0001	96080-0080	91003-0010	7867-0000	91003-0010	913-0000	92600-0060	818-0000	---	7868-0000	11831-0000	Obsolète	
17040-0001	USA	080	1/2" Flanged	Flange	---	3101-0000	17937-0001	96080-0080	91003-0010	3255-0000	91004-0090	913-0000	92600-0060	---	---	7868-0000	11831-0000	Proprietary	
17050-0001	USA	080	1/2" Flanged	Flange	---	3101-0000	17937-0001	96080-0080	91003-0010	7873-0000	91003-0020	913-0000	92600-0060	---	---	7267-0000	11831-0000	17054-0000	
17050-0002	USA	080	1/2" Flanged	Flange	---	3101-0000	17937-0001	96080-0080	91003-0010	7873-0000	91003-0020	913-0000	92600-0060	---	---	7267-0000	11831-0000	17054-0000	
17100-0001	USA	080	1/2" NPT	Flange	---	17106-0000	17937-0001	96080-0080	Obsolète	---	---	---	---	---	---	---	---	Obsolète	
17100-0005	USA	080	1/2" NPT	Flange	---	17106-0000	17937-0001	96080-0080	Obsolète	---	---	---	---	---	---	---	---	Obsolète	
17100-0011	USA	080	1/2" NPT	Flange	---	17106-0000	17937-0001	96080-0080	Obsolète	---	---	---	---	---	---	---	---	Obsolète	
17120-0001	USA	010	1/2" NPT	Flange	---	9156-0010	4528-0001	92700-0060	91002-0090	4538-0000	91002-0090	---	---	---	17127-0000	17108-0000	11835-0000	17124-0000	
17200-0001	USA	080	1/2" Hose	Flange	---	10184-0000	11979-0001	96080-0080	91003-0010	10182-0000	91004-0090	---	---	---	---	---	---	Obsolète	
17350-0011	USA	120	---	---	---	17106-0000	17018-0001	96080-0080	---	---	---	---	---	---	---	---	---	Obsolète	
17360-1001	USA	200	2 1/2" Flange	Flange	90190-0001	17365-1000	17370-0001	96080-0371	91005-0040	17374-1000	---	92701-0180	18752-0000	18752-0000	17366-1000	17372-1000	17378-1000	Obsolète	
17380-0001	USA	080	---	---	---	17106-0000	11979-0001	92700-0060	---	---	---	---	---	---	---	---	---	Obsolète	
17380-0011	USA	080	---	---	---	17106-0000	11979-0001	92700-0060	---	---	---	---	---	---	---	---	---	Obsolète	
17380-0021	USA	080	---	---	---	17106-0000	11979-0001	92700-0060	---	---	---	---	---	---	---	---	---	Obsolète	
17380-0031	USA	080	---	---	---	17106-0000	11979-0001	92700-0060	---	---	---	---	---	---	---	---	---	Obsolète	
17410-0001	USA	040	1" Hose	Flange	---	17408-0000	3085-0001	96080-0080	91095-0540	---	91004-0100	---	---	---	17847-0000	17388-0000	17404-0000	Obsolète	
17440-0001	USA	080	---	---	90181-0001	17445-0000	17937-0001	96080-0080	Obsolète	2431-0000	---	---	---	---	17108-0010	---	---	Obsolète	
17490-0001	USA	270	---	---	---	17365-1000	17936-0001	96080-0371	91005-0040	17374-1000	---	---	---	---	---	---	---	Obsolète	
17520-0001	USA	200	2 1/2" Flange	Flange	---	816-0000	17935-0001	6408-0000	18753-0332	834-0001	91005-0040	92700-0180	18753-0140	---	18753-0140	2574-0000	12062-0000	Proprietary	
17520-0002	USA	200	2 1/2" Flange	Flange	---	816-0000	17935-0001	6408-0000	18753-0332	834-0001	91005-0040	92700-0180	18753-0140	---	18753-0140	2574-0000	12062-0000	Proprietary	
17520-0051	USA	200	2 1/2" Flange	Flange	---	2553-1000	17935-0001	6408-0000	18753-0332	2551-0000	91005-0050	92700-0180	18753-0140	---	18753-0140	2574-0000	12062-0000	Proprietary	
17520-0052	USA	200	2 1/2" Flange	Flange	---	2553-1000	17935-0001	6408-0000	18753-0332	2551-0000	91005-0050	92700-0180	18753-0140	---	18753-0140	2574-0000	12062-0000	Proprietary	

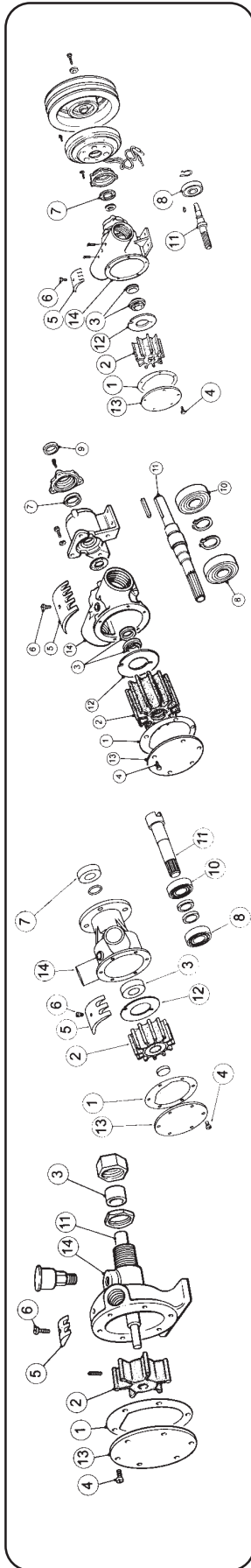

Service Parts - Flexible Impeller Pumps Spares by Pump Model 11860-0007 to 17520-0052

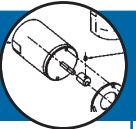

JABSCO PUMP DETAILS			SERVICE KIT DETAILS				GENERAL PARTS LISTING													
Pump Number	Origin	Pump Size	Port Type	Mount Type	Alternate Part No	Kit Number	Gasket/O Ring	Impeller	Water Seal	End Cover Screws	Cam	Cam Screw	Pump End Oil Seal	Pump End Bearing	Drive End Oil Seal	Drive End Bearing	Shaft	Wearplate	Endcover	Body
						Key	1	2	3	4	5	6	7	8	9	10	11	12	13	14
18930-0020	USA	080	1 1/2" Hose	Flange		90184-0001	18753-0005	11979-0001	96080-0080	18753-0001	10182-0000	91004-0090	92600-0120	92600-0120	18836-1000	18836-1000	10957-01	4156	3993	18944-1000
18944-1000	USA	080	1 1/2" Hose	Flange		90184-0001	18753-0005	11979-0001	96080-0080	18753-0001	10182-0000	91004-0090	92600-0120	92600-0120	18836-1000	18836-1000	10957-01	4156	3993	18944-1000
21080-200	UK	040	1/2" BSP	Foot	Blige	SK330	11415	1210-0001	SP2701-21	SP1003-11	Assy 7884	SP1003-01	SP2700-47	SP2700-47	21087	21087	21116 (Div Pi)	4156	3993	6424-221
21080-200	UK	080	1" Flanged	Foot	Cooling	SK330	890	17937-0001	SP2701-21	SP1003-08	934	SP1004-09	SP2700-48	SP2700-48	21087	21087	21116 (Div Pi)	4156	3993	6424-221
21080-204	UK	040	1/2" BSP	Foot	Blige	SK330	11415	1210-0001	SP2701-21	SP1003-11	Assy 7884	SP1003-01	SP2700-47	SP2700-47	21087	21087	21116 (Div Pi)	4156	3993	11414-200
21080-204	UK	080	1" BSP	Foot	Cooling	SK330	890	17937-0001	SP2701-21	SP1003-08	3225	SP1004-10	SP2700-48	SP2700-48	21087	21087	21116 (Div Pi)	4156	3993	6424-221
21090-200	UK	040	1/2" BSP	Flange	x 21090-204	SK239	3298	1210-0001	22626-0000	SP1002-02	480	SP1003-01	---	---	---	---	---	7883	3993	10974-200
21090-204	UK	040	1/2" BSP	Flange	x	SK239	816	836-0001	21849	SP1005-04	10336	SP1003-09	---	---	---	---	---	7883	3993	10974-200
21100	UK	080	1" BSP	Foot	x	SK288	890	17937-0001	22626-0000	SP1003-09	21167	SP1004-09	---	---	---	---	---	21168	3993	10329-200
21130-200	UK	010	1/8" BSP	Flange	x 21130-2101	SK304	21117	4528-0001	SP2701-04	SP1002-03	AL8	SP1002-02	---	---	---	---	---	---	---	21113-200
21130-200	UK	010	1/8" BSP	Flange	x 21130-2101	SK304	21117	4528-0001	SP2701-04	SP1002-17	AL8	SP1002-09	---	---	---	---	---	---	---	11264-201
21130-2101	UK	010	1/8" BSP	Flange	x	SK304	21117	4528-0001	SP2701-04	SP1002-03	AL8	SP1002-02	---	---	---	---	---	---	---	11264-210
21130-2101	UK	010	1/8" BSP	Flange	Cooling	SK304	21117	4528-0001	SP2701-04	SP1002-17	AL8	SP1002-01	---	---	---	---	---	---	---	11264-210
21140-200	UK	080	1" BSP	Flange	x 21140-2401	SK229	890	17937-0001	22617-0010	SP1003-09	934	SP1004-09	SP2701-21	SP2601-39	10957-01	10957-01	4156	3993	10329-200	
21140-201	UK	080	1" BSP	Flange	x 21140-2401	SK229	890	17937-0001	22617-0010	SP1003-09	934	SP1004-09	SP2701-21	SP2601-39	10957-01	10957-01	4156	3993	10329-200	
21140-2101	UK	080	1" BSP	Flange	x 21140-2601	SK229	890	17937-0001	22617-0010	SP1003-09	3255	SP1004-11	---	---	---	---	---	---	---	10329-200
21140-2141	UK	080	1" BSP	Flange	x 21140-2601	SK229	890	17937-0001	22617-0010	SP1003-09	3255	SP1004-11	---	---	---	---	---	---	---	10329-200
21140-2241	UK	080	1" BSP	Flange	x 21140-2601	SK229	890	17937-0001	22617-0010	SP1003-09	934	SP1004-09	SP2701-21	SP2601-39	10957-01	10957-01	4156	3993	10329-200	
21140-2308	UK	080	1" BSP	Flange	x 21140-2601	SK229-0008	890	920-0008	22617-0010	SP1003-09	934	SP1004-09	SP2701-21	SP2601-39	10957-01	10957-01	4156	3993	10329-200	
21140-2401	UK	080	1" BSP	Flange	x	SK423-0001	890	920-0001	22617-0010	SP1003-09	934	SP1004-09	SP2701-21	SP2601-39	10957-01	10957-01	4156	3993	10329-200	
21140-2441	UK	080	1" BSP	Flange	x	SK229	890	17937-0001	22617-0010	SP1003-09	3255	SP1004-11	---	---	---	---	---	---	---	10329-200
21140-2641	UK	080	1" BSP	Flange	x	SK423-0001	890	920-0001	22617-0010	SP1003-09	934	SP1004-09	SP2701-21	SP2601-39	10957-01	10957-01	4156	3993	10329-200	
21140-2701	UK	080	1" BSP	Flange	x	SK229	890	17937-0001	22617-0010	SP1003-09	3255	SP1004-11	---	---	---	---	---	---	---	10329-200
21180	UK	200	1 1/2" Flanged	Flange	x	SK295-01	816	836-0001	21849	SP1005-04	834	SP1005-04	SP2701-51	SP2601-30	21186	21186	23377-0010	2574	9336	21183
21180-05	UK	200	1 1/2" Flanged	Flange	x	SK295-01	816	836-0001	21849	SP1005-04	2551	SP1005-05	SP2701-51	SP2601-30	21186	21186	23377-0010	2574	9336	21183
21190-200	UK	020	1/2" BSP	Foot	Blige	SK327	11476	673-0001	SP2701-21	SP1002-06	2907	SP1002-09	---	---	---	---	---	---	---	11474
21190-200	UK	040	1/2" BSP	Foot	Cooling	SK327	11475	1210-0001	SP2701-21	SP1002-03	Assy 7884	SP1003-01	SP2701-21	SP2701-21	21197	21197	23377-0010	Assy 7884	3274-221	
21580-200	UK	080	1" BSP	Flange	x	SK229	890	17937-0001	22626-0000	SP1003-09	934	SP1004-09	SP2701-39	SP2601-39	10957-01	10957-01	4156	3993	10329-200	
21680-05	UK	080	1" NPT	Foot	x	SK315-0101	816	17935-0001	21849	SP1005-04	2551	SP1005-05	SP2700-49	SP2700-49	9336	9336	23377-0010	2574	9336	21684
21690	UK	040	20 Hose	Flange	x	SK239	3298	1210-0001	22626-0000	SP1002-02	490	SP1003-01	SP2701-21	SP2601-44	21698	21698	23377-0010	7883	3992	21699
21690-05	UK	040	20 Hose	Flange	x	SK239	3298	1210-0001	22626-0000	SP1002-02	10336	SP1003-09	SP2701-21	SP2601-44	21698	21698	23377-0010	7883	3992	21699
21690-200	UK	040	1/2" BSP	Flange	x	SK239	3298	1210-0001	22626-0000	SP1002-02	490	SP1003-01	SP2701-21	SP2601-44	21698	21698	23377-0010	7883	3992	21699
21770	UK	040	3/2 Hose	Flange	x	SK309	4908	4568-0001	SP2701-01	SP1003-09	490	SP1003-07	---	---	---	---	---	---	---	16554-200
																				21775

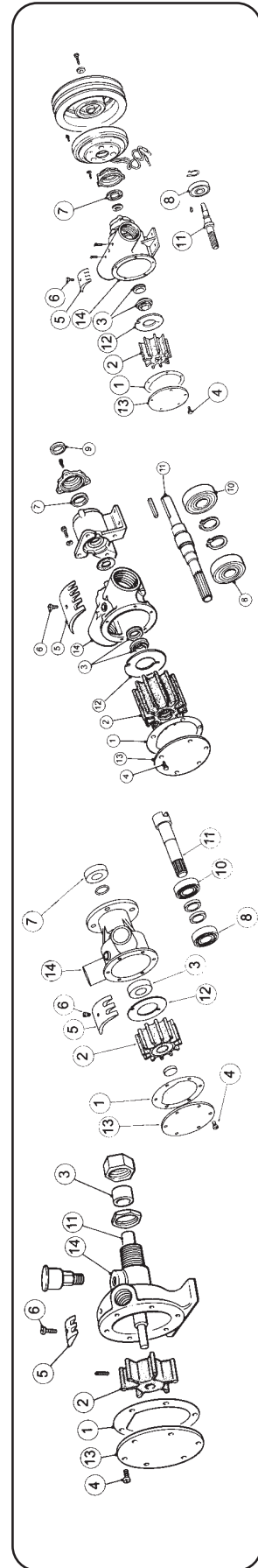

Service Parts - Flexible Impeller Pumps Spares by Pump Model 18930-0020 to 21770

Service Parts -

Flexible Impeller Pumps Spares by Pump Model 21780 to 22350-200

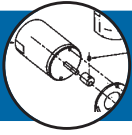

JABSCO PUMP DETAILS				SERVICE KIT DETAILS				GENERAL PARTS LISTING												
Pump Number	Origin	Pump Size	Port Type	Mount Type	Alternate Part No	Kit Number	Gasket/O-ring	Impeller	Water Seal	End Cover Screws	Cam	Cam Screw	Pump End Oil Seal	Pump End Bearing	Drive End Oil Seal	Drive End Bearing	Shaft	Wearplate	Endcover	Body
						Key	1	2	3	4	5	6	7	8	9	10	11	12	13	14
21780	UK	200	1/4" BSP	Foot	x	SK230	816	836-0001	21849	SP1005-04	21789	SP1004-09	SP2700-50	SP2600-49	SP2600-04	21788	4156	3993	21784	
21810	UK	200	1/4" BSP	Foot	x	SK310	890	17018-0001	22617-0000	SP1003-09	834	SP1005-04	SP2700-50	SP2600-18	SP2600-11	21238	2574	9336	10584-11	
21810-01	UK	200	1/4" BSP	Foot	x	SK230	816	836-0001	21849	SP1005-04	834	SP1005-04	SP2700-50	SP2600-18	SP2600-11	21238	2574	9336	10584-11	
21820-200	UK	040	1/2" BSP	Foot	x	SK33	3298	1210-0001	SP2701-21	SP1002-02	490	SP1003-01	SP2701-21	SP2600-07	SP2600-07	21826	7883	3992	21824-200	
21820-2001	UK	040	1/2" BSP	Foot	x	SK33	3298	1210-0001	SP2701-21	SP1002-02	490	SP1003-01	SP2701-21	SP2600-07	SP2600-07	21826	7883	3992	21824-200	
21820-2003	UK	040	1/2" BSP	Foot	x	SK384-0003	3298	1210-0003	SP2700-1027	SP1002-02	490	SP1003-01	SP2701-15	SP2600-07	SP2600-07	21826	7883	3992	21824-200	
21820-2021	UK	040	1/2" BSP	Foot	x	SK384-2021	3298	3085-0001	SP2700-1027	SP1002-02	490	SP1003-01	SP2701-15	SP2600-07	SP2600-07	21826	7883	3992	21824-200	
21820-205	UK	040	1/2" BSP	Foot	x	SK33	3298	1210-0001	SP2701-21	SP1002-02	10336	SP1003-09	SP2701-21	SP2600-07	SP2600-07	21826	7883	3992	21824-200	
21880-200	UK	080	1" BSP	Foot	x	SK300	11746	17937-0001	21849	SP1005-03	934	SP1004-09	SP2700-50	SP2600-49	SP2600-04	21887	4156	11745 (Div PI)	6404-200	
21880-200	UK	200	1/4" BSP	Foot	x	SK300	816	836-0001	21849	SP1005-03	834	SP1005-04	SP2700-50	SP2600-49	SP2600-04	21887	4156	11745 (Div PI)	6404-200	
21880-205	UK	080	1" BSP	Foot	x	SK300	11746	17937-0001	21849	SP1005-03	2551	SP1005-05	SP2700-50	SP2600-49	SP2600-04	21887	2574	11745 (Div PI)	11744-200	
21880-205	UK	200	1/4" BSP	Foot	x	SK300	816	836-0001	21849	SP1005-03	934	SP1004-09	SP2700-50	SP2600-49	SP2600-04	21887	4156	11745 (Div PI)	6404-200	
21890	UK	120	1/2" BSP	Flange	x	SK310	890	17018-0001	22617-0000	SP1003-09	2551	SP1005-05	SP2700-48	SP2601-42	SP2601-37	21966	2574	3993	10329-200	
21960-200	UK	080	1" BSP	Foot	x	SK229	890	17937-0001	22617-0010	SP1003-09	934	SP1004-09	SP2700-48	SP2601-42	SP2601-37	21966	4156	3993	10329-200	
21960-210	UK	080	1" BSP	Foot	x	SK229	890	17937-0001	22617-0010	SP1003-09	934	SP1004-09	SP2700-48	SP2601-42	SP2601-37	21966	4156	3993	10329-200	
21960-211	UK	080	1" BSP	Foot	x	SK229	890	17937-0001	22617-0010	SP1003-09	934	SP1004-09	SP2700-48	SP2601-42	SP2601-37	21966	4156	3993	10329-200	
21960-221	UK	080	1" BSP	Foot	x	SK229	890	17937-0001	22617-0010	SP1003-09	934	SP1004-09	SP2700-48	SP2601-42	SP2601-37	21966	4156	3993	10329-200	
21980	UK	200	1/4" BSP	Foot	x	SK317	816	836-0001	21849	SP1005-04	834	SP1005-04	SP2701-86	SP2601-37	SP2601-37	21997	2574	9336	10634	
21990	UK	270	2" Flanged	Foot	x	SK254	4009	17936-0001	21849	SP1005-04	6988	SP1005-04	SP2700-50	SP2601-37	SP2601-37	21997-01	2574	9336	10494	
22040-01	UK	270	2" Flanged	Flange	x	SK318	816	17936-0001	21849	SP1005-04	6988	SP1005-04	SP2700-50	SP2601-37	SP2601-37	21997-01	2574	9336	11104-02	
22040-0131	UK	270	2" Flanged	Flange	x	SK318	816	17936-0001	21849	SP1005-04	22039	SP1005-04	SP2700-50	SP2601-37	SP2601-37	21997-01	2574	9336	11104-03	
22040-0501	UK	270	2" Flanged	Flange	x	SK318	816	17936-0001	21849	SP1005-04	6988	SP1005-04	SP2700-50	SP2601-37	SP2601-37	21997-01	2574	9336	11104-03	
22040-0531	UK	270	2" Flanged	Flange	x	SK318	816	17936-0001	21849	SP1005-04	22039	SP1005-05	SP2700-50	SP2601-37	SP2601-37	21997-01	2574	9336	11104-03	
22110-0201	USA	060	1/4" Hose	Crank	x	SK318	816	17936-0001	21849	SP1005-04	22039	SP1005-05	SP2700-50	SP2601-37	SP2601-37	21997-01	2574	9336	11104-03	
22110-0251	USA	060	1/4" Hose	Crank	x	SK318	816	17936-0001	21849	SP1005-04	22039	SP1005-05	SP2700-50	SP2601-37	SP2601-37	21997-01	2574	9336	11104-03	
22110-0301	USA	060	1/4" Hose	Crank	x	SK318	816	17936-0001	21849	SP1005-04	22039	SP1005-05	SP2700-50	SP2601-37	SP2601-37	21997-01	2574	9336	11104-03	
22110-0351	USA	060	1/4" Hose	Crank	x	SK318	816	17936-0001	21849	SP1005-04	22039	SP1005-05	SP2700-50	SP2601-37	SP2601-37	21997-01	2574	9336	11104-03	
22220-2001	UK	060	1" BSP	Flange	x	SK334	3298	22120-0001	22626-0000	SP8019-01	22318	SP1004-11	SP2701-21	SP2600-13	SP2600-13	22227-0100	7883	3992	22224	
22220-241	UK	060	1" BSP	Flange	x	SK334	3298	22120-0001	22626-0000	SP1002-01	22318	SP1004-11	SP2701-21	SP2600-13	SP2600-13	22227	7883	3992	22224	
22230-200	UK	010	1/4" BSP	Flange	x	SK332	21117	4528-0001	SP2701-09	SP1107-05	22216	SP1002-02	SP2701-21	SP2600-13	SP2600-13	22227	7883	3992	22234-200	
22230-200	UK	010	1/4" BSP	Flange	x	SK332	21117	4528-0001	SP2701-09	SP1107-05	AL8	SP1002-09	SP2701-21	SP2600-13	SP2600-13	22227	7883	3992	22234-200	
Duplex																				21913-202
22240	UK	020	Ø 16 Hose	Flange	x	SK333	9408	673-0001	SP2701-09	SP1107-05	22217	SP1002-01	SP2701-21	SP2600-13	SP2600-13	22227	7883	3992	22244	
22240	UK	020	Ø 16 Hose	Flange	x	SK333	9408	673-0001	SP2701-09	SP1107-05	10818	SP1002-02	SP2701-21	SP2600-13	SP2600-13	22227	7883	3992	22244	
Duplex																				11474-01
22300-05	UK	060	Ø 32 Hose	Crank	x	SK331-05	3298	4528-0001	SP2701-09	SP8019-01	22308	SP1004-10	SP2701-21	SP2600-09	SP2600-09	22307	22247	3992	22304	
22350-200	UK	010	1/4" BSP	Flange	x	SK336	1126	4528-0001	SP2701-09	X3075-062G	22216	SP1002-02	SP2701-21	SP2600-09	SP2600-09	22307	22247	3992	22304	

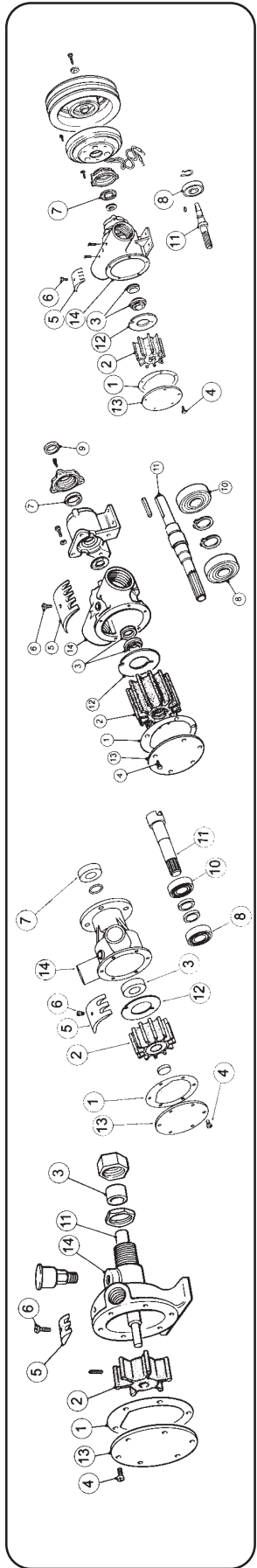

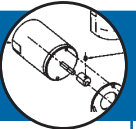

JABSCO PUMP DETAILS				SERVICE KIT DETAILS				GENERAL PARTS LISTING													
Pump Number	Origin Pump Size	Port Type	Mount Type	Alternate Part No	Obsolite	Kit Number	Gasket/O Ring	Impeller	Water Seal	End Cover Screws	Cam	Cam Screw	Pump End Oil Seal	Pump End Bearing	Drive End Oil Seal	Drive End Bearing	Shaft	Wearplate	Endcover	Body	
						Key	1	2	3	4	5	6	7	8	9	10	11	12	13	14	
22350-200 Duplex	UK 010	1/4" BSP	Flange	Fresh Water		SK336	1126	4528-0001	SP2701-09	X3075-062G	AL8	SP1002-09	SP2701-04	---	SP2701-04	---	22237	---	21116 (Div Pi)	22354-200	
22360	UK 020	Ø 16 Hose	N/A	Salt Water	x	SK337	10817	673-0001	SP2701-04	X3075-062G	10818	SP1002-01	---	---	---	---	---	---	22366	22364	
22360 Duplex	UK 020	Ø 16 Hose	Flange	Fresh Water		SK337	10817	673-0001	SP2701-04	X3075-062G	22217	SP1002-02	SP2701-04	---	SP2701-04	---	22247	---	11478 (Div Pi)	22374	
22400-0201	USA 060	1" BSP	Flange	Fresh Water		---	18753-0656	22120-0001	---	18753-0657	---	---	---	---	---	---	---	---	---	---	---
22400-0251	USA 060	1" BSP	Flange	Fresh Water		---	18753-0656	22120-0001	---	18753-0657	---	---	---	---	---	---	---	---	---	---	---
22400-0301	USA 060	1" BSP	Flange	Fresh Water		---	18753-0656	22120-0001	---	18753-0657	---	---	---	---	---	---	---	---	---	---	---
22410-204	UK 080	1" BSP	Flange	Fresh Water	x	SK236	890	17937-0001	SP2701-21	SP1003-09	3255	SP1004-10	SP2700-48	---	SP2700-47	---	6718-202	---	3993	22414	
22620	UK 020	Ø 25 Hose	Crank	Salt Water	x	SK346	1985-01	673-0001	SP6800-08	SP1004-09	2907-0001	SP1002-01	---	---	---	---	---	---	9328	22624	
22620 Duplex	UK 080	1" BSP	Foot	Salt Water	x	SK344	11746	17937-0001	21849	SP1005-03	934	SP1004-09	---	---	---	---	---	4156	11745 (Div Pi)	10494	
22690-200	UK 270	2" BSP	Foot	Fresh Water		SK344	816	21676-0001	21849	SP1005-03	6988	SP1005-04	SP2700-49	---	SP2700-49	---	11749-01	2574	---	11744-200	
22740-0151	UK 060	Ø 32 Hose	Crank	Fresh Water		SK331-05	3298	22120-0001	SP6800-08	SP8019-01	22308	SP1004-10	---	---	---	---	22307	---	3992	22304-01	
22740-0201	UK 060	Ø 32 Hose	Crank	Fresh Water		SK331-0251	3298	22120-0001	SP2701-21	SP8019-01	22318	SP1004-11	---	---	---	---	22307	---	3992	22304-01	
22740-0251	UK 060	Ø 32 Hose	Crank	Fresh Water	x	SK331-0251	3298	22120-0001	SP2701-21	SP8019-01	22308	SP1004-11	---	---	---	---	22307	---	3992	22304-01	
22740-0301	UK 060	1" Flanged	Crank	Fresh Water	x	SK331-05	3298	22120-0001	SP2701-21	SP8019-01	22318	SP1004-11	---	---	---	---	22307	---	3992	22304-01	
22740-0351	UK 060	Ø 32 Hose	Crank	Fresh Water		SK331-05	3298	22120-0001	SP2701-21	SP8019-01	22308	SP1004-10	---	---	---	---	22307	---	3992	22304-01	
22740-0451	UK 060	Ø 32 Hose	Crank	Fresh Water		SK331-05	3298	22120-0001	SP2701-21	SP1002-01	22308	SP1004-10	---	---	---	---	22307-0100	---	3992	22304-01	
22750-05	UK 060	Ø 32 Hose	Crank	Fresh Water	x	SK331-05	3298	22120-0001	SP2701-21	SP8019-01	22308	SP1004-10	---	---	---	---	22627	---	3992	22304-02	
22750-1101	UK 060	Ø 32 Hose	Crank	Fresh Water		SK331-05	3298	22120-0001	SP2701-21	SP8019-01	22318	SP1004-11	---	---	---	---	22627	---	3992	22304-02	
22750-1151	UK 060	Ø 32 Hose	Crank	Fresh Water	x	SK331-05	3298	22120-0001	SP2701-21	SP8019-01	22308	SP1004-10	---	---	---	---	22627	---	3992	22304-02	
22770	UK 020	1" BSP	Crank	Fresh Water	x	SK346	1985-01	673-0001	SP2701-21	SP1004-09	2907-0001	SP1002-01	---	---	---	---	22627	---	9328	22624	
22770-1051	UK 060	Ø 25 Hose	Crank	Fresh Water	x	SK346	1985-01	673-0001	SP2701-21	SP1004-09	2441	SP1004-09	---	---	---	---	22627	---	9328	22624	
22770-1101	UK 020	Ø 25 Hose	Crank	Fresh Water	x	SK346	1985-01	673-0001	SP2701-21	SP1004-09	2907-0001	SP1002-01	---	---	---	---	22627	---	9328	22624	
22790-1001	UK 040	1/2" BSP	Flange	Salt Water	x	SK350	X4020-254A	22799-0001	SP2701-04	X3075-061G	2907-0001	SP1002-09	---	---	---	---	---	---	---	23393	
22790-1001 Duplex	UK 040	1/2" BSP	Flange	Fresh Water		SK350	22798	22799-0001	SP2701-04	X3075-061G	22789-0000	SP1002-09	---	---	---	---	22797-01	---	22366	23393	
22820-2051	UK 010	1/2" BSP	Flange	Fresh Water	x	SK23	1189	4528-0001	SP2701-14	SP1002-01	21233	SP1002-03	SP2701-14	Y5052-43	---	Y5052-43	22827	2765	9566	22824-200	
22820-2101	UK 010	1/2" BSP	Flange	Fresh Water	x	SK23	1189	4528-0001	SP2701-14	SP1002-01	21233	SP1002-03	SP2701-14	Y5052-43	---	Y5052-43	22827	2765	9566	22824-200	
22830-2001	UK 010	1/2" BSP	Flange	Fresh Water		SK23	1189	4528-0001	SP2701-14	SP1002-01	21233	SP1002-03	SP2701-14	Y5052-43	---	Y5052-43	22827	2765	9566	22834-200	
22830-2051	UK 010	1/2" BSP	Flange	Fresh Water	x	SK23	1189	4528-0001	SP2701-14	SP1002-01	21233	SP1002-03	SP2701-14	Y5052-43	---	Y5052-43	22827	2765	9566	22834-200	
22830-2101	UK 010	1/2" BSP	Flange	Fresh Water		SK23	1189	4528-0001	SP2701-14	SP1002-01	21233	SP1002-03	SP2701-14	Y5052-43	---	Y5052-43	22827	2765	9566	22834-200	
22830-2151	UK 010	1/2" BSP	Flange	Fresh Water		SK23	1189	4528-0001	SP2701-14	SP1002-01	21233	SP1002-03	SP2701-14	Y5052-43	---	Y5052-43	22827	2765	9566	22834-200	
22830-2201	UK 010	1/2" BSP	Flange	Fresh Water		SK23	1189	4528-0001	SP2701-14	SP1002-01	21233	SP1002-03	SP2701-14	Y5052-43	---	Y5052-43	22827	2765	9566	22834-200	
22830-2301	UK 010	1/2" BSP	Flange	Fresh Water		SK23	1189	4528-0001	SP2701-14	SP1002-01	21233	SP1002-03	SP2701-14	Y5052-43	---	Y5052-43	22827	2765	9566	22834-200	
22830-2001	UK 010	1/2" BSP	Foot	Fresh Water	x	SK23	1189	4528-0001	SP2701-14	SP1002-01	21233	SP1002-03	SP2701-14	Y5052-43	Y5016-09	Y5052-43	22947-0000	2765	9566	22944-2000	
22940-2051	UK 010	1/2" BSP	Foot	Fresh Water	x	SK23	1189	4528-0001	SP2701-14	SP1002-01	21233	SP1002-03	SP2701-14	Y5052-43	Y5016-09	Y5052-43	22947-0000	2765	9566	22944-2000	
22940-2053	UK 010	1/2" BSP	Foot	Fresh Water	x	SK23-37	1189	4528-0003	SP2701-14	SP1002-01	21233	SP1002-03	SP2701-14	Y5052-43	Y5016-09	Y5052-43	22947-0000	2765	9566	22944-2000	

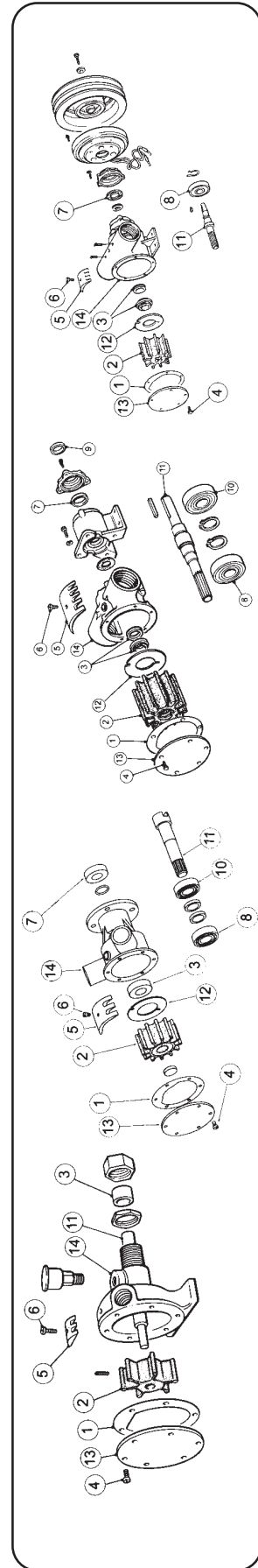

Service Parts - Flexible Impeller Pumps Spares by Pump Model 22350-200 to 22940-2053

Service Parts - Flexible Impeller Pumps Spares by Pump Model 22950-2031 to 23580-100

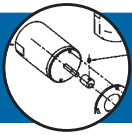

JABSCO PUMP DETAILS				SERVICE KIT DETAILS				GENERAL PARTS LISTING														
Pump Number	Origin	Pump Size	Port Type	Mount Type	Alternate Part No	Osloire	Kit Number	Key	Gasket/O-ring	Impeller	Water Seal	End Cover Screws	Cam	Cam Screw	Pump End Oil Seal	Pump End Bearing	Drive End Oil Seal	Drive End Bearing	Shaft	Wearplate	Endcover	Body
										<small>*Data supply only</small>												<small>*Data supply only</small>
22950-2031	UK	020	1/8" BSP	Foot	x	52020-2001	SK20-0031	2995-0030	2995-0030	675-0001	SP2700-05	SP1002-02	10818	SP1002-09	SP2700-05	SP2601-39	SP2701-15	SP2601-39	22957	22806	3992	22954-2000
22950-2037	UK	020	1/8" BSP	Foot	x	52020-2001	SK20-0037	2995-0030	2995-0030	675-0003	SP2700-05	SP1002-02	10818	SP1002-09	SP2700-05	SP2601-39	SP2701-15	SP2601-39	22957	22806	3992	22954-2000
22960-1001	UK	010	1/8" BSP	Foot	x	52020-2001	SK355	21646	4528-0001	SP2701-14	SP2701-14	SP1002-09	AL8	SP1002-02	SP2701-14	SP2600-025	SP2967-0000	SP2600-025	22967	---	21645	22964-1000
22960-2001	UK	010	1/8" BSP	Foot	x	52020-2001	SK355	21646	4528-0001	SP2701-14	SP2701-14	SP1002-09	AL8	SP1002-02	SP2701-14	SP2600-025	SP2967-0000	SP2600-025	22967	---	21645	22964-1000
23010-0131	UK	080	1" BSP	Flange	x	Blige	SK357-0001	11746	920-0001	21849	SP1005-03	22039	SP1005-05	SP2700-51	---	---	---	---	---	2574	---	11104-03
23010-0131	UK	080	1" BSP	Flange	x	Blige	SK357-0001	816	17936-0001	21849	SP1005-03	22039	SP1005-05	SP2700-51	---	---	---	---	---	2574	---	11104-03
23010-0501	UK	080	1" BSP	Flange	x	Blige	SK357-0001	11746	17937-0001	21849	SP1005-03	22039	SP1005-05	SP2700-51	---	---	---	---	---	2574	---	11104-03
23010-0531	UK	080	1" BSP	Flange	x	Blige	SK357-0001	11746	17937-0001	21849	SP1005-03	22039	SP1005-05	SP2700-51	---	---	---	---	---	2574	---	11104-03
23010-1101	UK	060	3/4" Flange	Flange	x	Cooling	SK331-05	816	17936-0001	21849	SP1005-03	22039	SP1005-05	SP2700-51	---	---	---	---	---	4156	11745 (Div PI)	11744-200
23010-1101	UK	060	3/4" Flange	Flange	x	Cooling	SK331-05	3298	22120-0001	22617-0010	SP1002-01	22308	SP1004-10	SP2701-03	SP2600-12	SP2600-12	SP2600-12	23087	---	3992	23082-8000	
23010-1101	UK	060	3/4" Flange	Flange	x	Cooling	SK331-05	890	17937-0001	22617-0010	SP1003-09	934	SP1004-09	SP2701-21	SP2601-0448	SP2601-0448	SP2601-0448	23327	---	3993	11604-2000	
23050-1031	UK	020	1/8" BSP	Flange	x	Blige	SK211	10817	675-0001	SP2701-04	SP1002-09	10818	SP1002-02	SP2701-04	SP2601-0448	SP2601-0448	SP2601-0448	23328	---	3993	11604-2000	
23060-1101	UK	020	1/8" BSP	Flange	x	Blige	SK360	3298	675-0001	SP6800-08	SP1002-02	2907-0001	SP1002-09	SP1002-02	SP1002-09	SP1002-09	SP1002-09	SP1002-09	23057	---	9905	11004
23060-1101	UK	060	3/4" Flange	Flange	x	Cooling	SK360	9408	22120-0001	SP6800-08	SP1002-06	22318	SP1004-11	SP1004-11	SP2600-09	SP2600-09	SP2600-09	23067	---	---	11474	
23070-1151	UK	060	3/4" Flange	Flange	x	Cooling	SK331-05	3298	22120-0001	SP6800-08	SP1002-06	22318	SP1004-11	SP1004-11	SP2600-09	SP2600-09	SP2600-09	23067	---	---	11474	
23080-1151	UK	060	3/4" Flange	Flange	x	Cooling	SK363-0051	3298	22120-0001	22617-0010	SP1002-01	22308	SP1004-10	SP2701-03	SP2600-12	SP2600-12	SP2600-12	23087	---	3992	23082-8000	
23320-2001	UK	080	1 1/2" Flange	Flange	x	New Pipework	SK229	890	17937-0001	22617-0010	SP1003-09	934	SP1004-09	SP2701-21	SP2601-0448	SP2601-0448	SP2601-0448	23327	---	3993	11604-2000	
23320-2101	UK	080	1 1/2" Flange	Flange	x	New Pipework	SK229	890	17937-0001	22617-0010	SP1003-09	934	SP1004-09	SP2701-21	SP2601-0448	SP2601-0448	SP2601-0448	23327	---	3993	11604-2000	
23340-1101	UK	120	4/5" Flange	Flange	x	Respecified	SK310	890	17018-0001	22617-0010	SP1003-09	23341-0000	SP1004-09	SP2701-54	SP2601-41	SP2601-41	SP2601-41	23347	---	3993	23344-8000	
23430-1001	UK	080	3/4" Flange	Flange	x	Respecified	SK385-0001	890	17937-0001	SP2700-1027	SP1003-0111	934	SP1004-09	SP2700-1027	SP2600-01	SP2600-01	SP2600-01	23437	---	3993	23434-1000	
23430-1031	UK	080	3/4" Flange	Flange	x	Respecified	SK385-0001	890	17937-0001	SP2700-1027	SP1003-0111	23436-0000	SP1004-09	SP2700-1027	SP2600-01	SP2600-01	SP2600-01	23437	---	3993	23434-1000	
23430-1041	UK	080	3/4" Flange	Flange	x	Respecified	SK385-0001	890	17937-0001	SP2700-1027	SP1003-0111	23436-0000	SP1004-09	SP2700-1027	SP2600-01	SP2600-01	SP2600-01	23437	---	3993	23434-1000	
23430-1051	UK	080	3/4" Flange	Flange	x	Respecified	SK385-0001	890	17937-0001	SP2700-1027	SP1003-0111	23436-0000	SP1004-09	SP2700-1027	SP2600-01	SP2600-01	SP2600-01	23437	---	3993	23434-1000	
23430-1201	UK	080	3/4" Flange	Flange	x	Respecified	SK385-0001	890	17937-0001	SP2700-1027	SP1003-0111	23436-0000	SP1004-09	SP2700-1027	SP2600-01	SP2600-01	SP2600-01	23437	---	3993	23434-1000	
23430-1241	UK	080	3/4" Flange	Flange	x	Respecified	SK385-0001	890	17937-0001	SP2700-1027	SP1003-0111	23436-0000	SP1004-09	SP2700-1027	SP2600-01	SP2600-01	SP2600-01	23437	---	3993	23434-1000	
23430-1251	UK	080	3/4" Flange	Flange	x	Respecified	SK385-0001	890	17937-0001	SP2700-1027	SP1003-0111	23436-0000	SP1004-09	SP2700-1027	SP2600-01	SP2600-01	SP2600-01	23437	---	3993	23434-1000	
23430-1301	UK	080	3/4" Flange	Flange	x	Respecified	SK385-0001	890	17937-0001	SP2700-1027	SP1003-0111	23436-0000	SP1004-09	SP2700-1027	SP2600-01	SP2600-01	SP2600-01	23437	---	3993	23434-1000	
23430-1401	UK	080	3/4" Flange	Flange	x	Respecified	SK385-0001	890	17937-0001	SP2700-1027	SP1003-0111	23436-0000	SP1004-09	SP2700-1027	SP2600-01	SP2600-01	SP2600-01	23437	---	3993	23434-1000	
23430-1441	UK	080	3/4" Flange	Flange	x	Respecified	SK385-0001	890	17937-0001	SP2700-1027	SP1003-0111	23436-0000	SP1004-09	SP2700-1027	SP2600-01	SP2600-01	SP2600-01	23437	---	3993	23434-1000	
23430-1501	UK	080	3/4" Flange	Flange	x	Respecified	SK385-0001	890	17937-0001	SP2700-1027	SP1003-0111	23436-0000	SP1004-09	SP2700-1027	SP2600-01	SP2600-01	SP2600-01	23437	---	3993	23434-1000	
23430-1601	UK	080	3/4" Flange	Flange	x	Respecified	SK385-0001	890	17937-0001	SP2700-1027	SP1003-0111	23436-0000	SP1004-09	SP2700-1027	SP2600-01	SP2600-01	SP2600-01	23437	---	3993	23434-1000	
23430-1641	UK	080	3/4" Flange	Flange	x	Respecified	SK385-0001	890	17937-0001	SP2700-1027	SP1003-0111	23436-0000	SP1004-09	SP2700-1027	SP2600-01	SP2600-01	SP2600-01	23437	---	3993	23434-1000	
23480-2001	UK	080	1" BSP	Foot	x	Blige	SK229	890	17937-0001	SP2700-1027	SP1003-0111	934	SP1004-09	SP2701-87	SP2700-48	SP2700-48	SP2700-48	---	21966	---	3993	10329-200

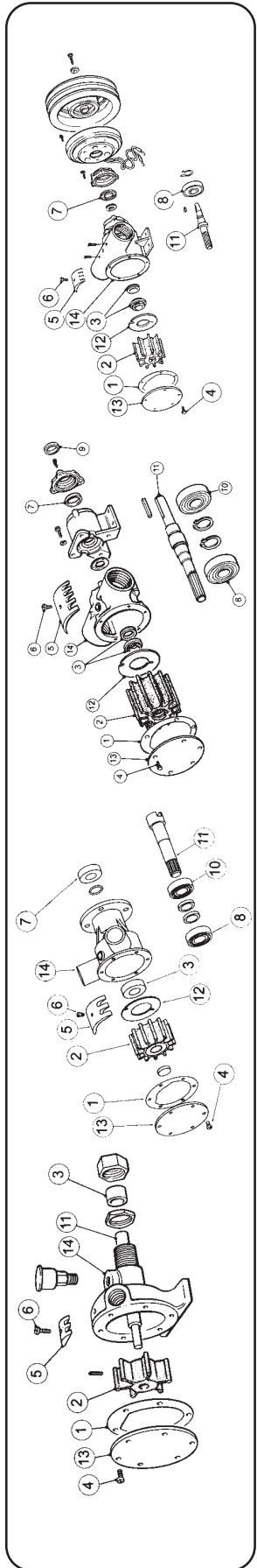

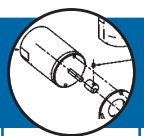

JABSCO PUMP DETAILS				SERVICE KIT DETAILS				GENERAL PARTS LISTING													
Pump Number	Origin	Pump Size	Port Type	Mount Type	Alternate Part No	Obsolète	Kit Number	Gasket/O Ring	Impeller	Water Seal	End Cover Screws	Cam	Cam Screw	Pump End Oil Seal	Pump End Bearing	Drive End Oil Seal	Drive End Bearing	Shaft	Wearplate	Endcover	Body
							Key	1	2	3	4	5	6	7	8	9	10	11	12	13	14
23800-0201	UK	060	Ø 32 Hose	Crank			SK331-0251	3298	22120-0001	SP2701-21	SP8019-01	22318	SP1004-11	---	SP2601-0461	22307	---	---	---	3992	22304-01
23800-0201	USA	060	Ø 32 Hose	Crank			---	3298-0000	22120-0001	92700-0060	18753-0090	91004-0110	---	---	---	---	---	---	---	11830-0000	---
23800-0251	UK	060	Ø 32 Hose	Crank	23800-0201	x	SK331-0251	3298	22120-0001	SP2701-21	SP8019-01	22308	SP1004-10	---	SP2601-0461	22307	---	---	---	3992	22304-01
23800-0251	USA	060	Ø 32 Hose	Crank			---	3298-0000	22120-0001	96080-0080	22308-0000	91004-0100	---	---	---	---	---	---	---	11830-0000	---
23800-0351	USA	060	Ø 32 Hose	Crank			SK331-0251	3298	22120-0001	92700-0060	18753-0090	91004-0110	---	---	---	---	---	---	---	---	---
23800-0351	UK	060	Ø 32 Hose	Crank	23800-0401	x	---	3298-0000	22120-0001	SP2701-21	SP8019-01	22308	SP1004-10	---	SP2601-0461	22307	---	---	---	3992	22304-01
23800-0401	UK	060	Ø 32 Hose	Crank			SK331-0251	3298	22120-0001	96080-0080	22308-0000	91004-0100	---	---	---	---	---	---	---	---	---
23900-2001	UK	010	H/8 BSP	Flange			SK404-0001	29308-0000	22405-0001	SP2701-1006	X3004-095G	29303-0000	SP1002-09	SP2701-1006	SP2601-0463	29307-0000	---	---	---	29306-0000	29304-2000
23900-2001	USA	010	H/8 BSP	Flange			---	29308-0000	22405-0001	X3004-095G	29303-0000	29303-0000	SP1002-09	SP2701-1006	SP2601-0463	29307-0020	---	---	---	29306-0000	29304-2000
23900-2101C	UK	010	H/8 BSP	Flange			SK404-0001	29308-0000	22405-0001	SP2701-1006	X3004-095G	29303-0000	SP1002-09	SP2701-1006	SP2601-0463	29307-0020	---	---	---	29306-0000	29304-2000
23900-2101C	USA	010	H/8 BSP	Flange			---	29308-0000	22405-0001	SP2701-1006	X3004-095G	29303-0000	SP1002-09	SP2701-1006	SP2601-0463	29307-0020	---	---	---	29306-0000	29304-2000
23900-2201C	UK	010	H/8 BSP	Flange			SK404-0001	29308-0000	22405-0001	SP2701-1006	X3004-095G	29303-0000	SP1002-09	SP2701-1006	SP2601-0463	29307-0020	---	---	---	29306-0000	29304-2000
23900-2201C	USA	010	H/8 BSP	Flange			---	29308-0000	22405-0001	SP2701-1006	X3004-095G	29303-0000	SP1002-09	SP2701-1006	SP2601-0463	29307-0020	---	---	---	29306-0000	29304-2000
23900-2301	UK	010	H/8 BSP	Flange			SK404-0001	29308-0000	22405-0001	SP2701-1006	X3004-095G	29303-0000	SP1002-09	SP2701-1006	SP2601-0463	29307-0040	---	---	---	29306-0000	29304-2000
23900-2401	UK	010	H/8 BSP	Flange			SK404-0001	29308-0000	22405-0001	SP2701-1006	X3004-095G	29303-0000	SP1002-09	SP2701-1006	SP2601-0463	29307-0030	---	---	---	29306-0000	29304-2000
23900-2401	USA	010	H/8 BSP	Flange			---	29308-0000	22405-0001	SP2701-1006	X3004-095G	29303-0000	SP1002-09	SP2701-1006	SP2601-0463	29307-0030	---	---	---	29306-0000	29304-2000
23900-2501	UK	010	H/8 BSP	Flange			SK404-0001	29308-0000	22405-0001	SP2701-1006	X3004-095G	29303-0000	SP1002-09	SP2701-1006	SP2601-0463	29307-0040	---	---	---	29306-0000	29304-2000
23900-2501	USA	010	H/8 BSP	Flange			---	29308-0000	22405-0001	SP2701-1006	X3004-095G	29303-0000	SP1002-09	SP2701-1006	SP2601-0463	29307-0040	---	---	---	29306-0000	29304-2000
23900-2601C	UK	010	H/8 BSP	Flange			SK404-0001	29308-0000	22405-0001	SP2701-1006	X3004-095G	29303-0000	SP1002-09	SP2701-1006	SP2601-0463	29307-0050	---	---	---	29306-0000	29304-2000
23900-2601C	USA	010	H/8 BSP	Flange			---	29308-0000	22405-0001	SP2701-1006	X3004-095G	29303-0000	SP1002-09	SP2701-1006	SP2601-0463	29307-0050	---	---	---	29306-0000	29304-2000
23900-2731C	UK	010	H/8 BSP	Flange			SK404-0001	29308-0000	22405-0001	SP2701-1006	X3004-095G	29303-0000	Not fitted	SP2701-1006	SP2601-0463	29307-0030	---	---	---	29306-0000	29304-2100
23900-2731C	USA	010	H/8 BSP	Flange			---	29308-0000	22405-0001	SP2701-1006	X3004-095G	29303-0000	Not fitted	SP2701-1006	SP2601-0463	29307-0030	---	---	---	29306-0000	29304-2100
23940-2101C	UK	010	Ø 18 Hose	Flange			SK23-0101	1126	4528-0001	SP2701-14	SP1002-01	2763	SP1002-02	SP2701-14	SP2601-0459	2765	---	---	---	AL6-200	29354-1000
23940-2101C	USA	010	Ø 20 Hose	Flange			---	1126	4528-0001	SP2701-14	SP1002-01	2763	SP1002-02	SP2701-14	SP2601-0459	2765	---	---	---	AL6-200	29354-1100
29400-1101	UK	020	Ø 20 Hose	Flange			SK404-0001	29308-0000	22405-0001	SP2701-1006	X3004-095G	2907-0001	SP1002-02	SP2701-1006	SP2601-0457	29457-0010	---	---	---	---	29404-1100
29400-1101	USA	020	Ø 20 Hose	Flange			---	29308-0000	22405-0001	SP2701-1006	X3004-095G	2907-0001	SP1002-02	SP2701-1006	SP2601-0457	29457-0010	---	---	---	---	29404-1100
29400-1101	UK	020	Ø 20 Hose	Flange			SK404-0001	29308-0000	22405-0001	SP2701-1006	X3004-095G	2907-0001	SP1002-02	SP2701-1006	SP2601-0457	29467-0000	---	---	---	---	29404-1100
29400-1101	USA	020	Ø 20 Hose	Flange			---	29308-0000	22405-0001	SP2701-1006	X3004-095G	2907-0001	SP1002-02	SP2701-1006	SP2601-0457	29467-0000	---	---	---	---	29404-1100
29410-1101	UK	020	Ø 20 Hose	Flange			SK404-0001	29308-0000	18653-0001	SP2701-1006	X3004-095G	2907-0001	SP1002-02	SP2701-1006	SP2601-0463	29417-0100	---	---	---	---	29414-1100
29410-1101	USA	020	Ø 20 Hose	Flange			---	18653-0000	18653-0001	29441-0000	SP1004-09	2441	SP1002-02	---	---	---	---	---	---	---	---
29440-1051	UK	020	Ø 25 Hose	Crank			SK402-0001	1985-0000	18653-0001	29441-0000	SP1004-09	2441	SP1002-02	---	---	---	---	---	---	---	---
29440-1051	USA	020	Ø 25 Hose	Crank			---	1985-0000	18653-0001	29441-0000	SP1004-09	2441	SP1002-02	---	---	---	---	---	---	---	---
29440-1101	UK	020	Ø 25 Hose	Crank			SK402-0001	1985-0000	18653-0001	29441-0000	SP1004-09	2907-0001	SP1002-02	---	---	---	---	---	---	---	---
29440-1101	USA	020	Ø 25 Hose	Crank			---	1985-0000	18653-0001	29441-0000	SP1004-09	2907-0001	SP1002-02	---	---	---	---	---	---	---	---
29450-1201	UK	020	Ø 20 Hose	Flange			SK387-0001	2995-0030	673-0001	SP2700-05	SP1002-01	2907-0001	SP1002-02	SP2700-05	SP2601-0457	29457-0010	---	---	---	---	---
29450-1201	USA	020	Ø 20 Hose	Flange			---	2995-0030	673-0001	SP2700-05	SP1002-01	2907-0001	SP1002-02	SP2700-05	SP2601-0457	29457-0010	---	---	---	---	---
29450-1231	UK	020	Ø 20 Hose	Flange			SK387-0001	2995-0030	673-0001	SP2700-05	SP1002-01	10818	SP1002-02	SP2700-05	SP2601-0457	29457-0020	---	---	---	---	---
29450-1231	USA	020	Ø 20 Hose	Flange			---	2995-0030	673-0001	SP2700-05	SP1002-01	10818	SP1002-02	SP2700-05	SP2601-0457	29457-0020	---	---	---	---	---
29450-1301	UK	020	Ø 20 Hose	Flange			SK387-0001	2995-0030	673-0001	SP2700-05	SP1002-01	2907-0001	SP1002-02	SP2700-05	SP2601-0457	29457-0010	---	---	---	---	---
29450-1301	USA	020	Ø 20 Hose	Flange			---	2995-0030	673-0001	SP2700-05	SP1002-01	2907-0001	SP1002-02	SP2700-05	SP2601-0457	29457-0010	---	---	---	---	---
29450-1400	UK	020	Ø 20 Hose	Flange			SK387-0001	2995-0030	673-0001	SP2700-05	SP1002-01	10818	SP1002-02	SP2700-05	SP2601-0457	29457-0020	---	---	---	---	---
29450-1400	USA	020	Ø 20 Hose	Flange			---	2995-0030	673-0001	SP2700-05	SP1002-01	10818	SP1002-02	SP2700-05	SP2601-0457	29457-0020	---	---	---	---	---

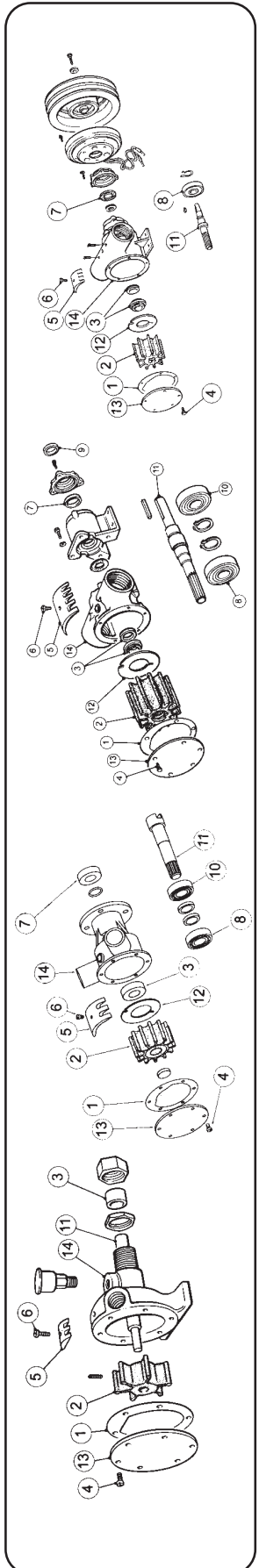

Service Parts - Flexible Impeller Pumps Spares by Pump Model 2380-0201 to 29450-1431

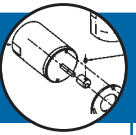

JABSCO PUMP DETAILS				SERVICE KIT DETAILS				GENERAL PARTS LISTING												
Pump Number	Origin Pump Size	Port Type	Mount Type	Alternate Part No	Kit Number	Gasket/O Ring	Impeller	Water Seal	End Cover Screws	Cam	Cam Screw	Oil Seal	Pump End Bearing	Drive End Oil Seal	Drive End Bearing	Shaft	Wearplate	Endcover	Body	
					Key															* OEM supply only
29480-2031	UK	Ø 20	1/8" BSP		SK405-0001	29476-0000	18653-0001	SP2701-1006	X3004-095G	10818	SP1002-02	SP2701-1006	SP2601-0463	SP2601-0463	29487-0000	29487-0000	29475-0000	29475-0000	29484-2000	
29480-2031C	UK	Ø 20	1/8" BSP		SK405-0001	29476-0000	18653-0001	SP2701-1006	X3004-095G	10818	SP1002-02	SP2701-1006	SP2601-0463	SP2601-0463	29487-0000	29487-0000	29475-0000	29475-0000	29484-2000	
29480-2151	UK	Ø 20	1/8" BSP		SK405-0001	29476-0000	18653-0001	SP2701-1006	X3004-095G	2441	SP1002-01	SP2701-1006	SP2601-0463	SP2601-0463	29486-0000	29486-0000	29475-0000	29475-0000	29484-2000	
29480-2231	UK	Ø 20	1/8" BSP		SK405-0001	29476-0000	18653-0001	SP2701-1006	X3004-095G	10818	SP1002-02	SP2701-1006	SP2601-0463	SP2601-0463	29486-0000	29486-0000	29475-0000	29475-0000	29484-2000	
29480-2431	UK	Ø 20	1/8" BSP		SK405-0001	29476-0000	18653-0001	SP2701-1006	X3004-095G	10818	SP1002-02	SP2701-1006	SP2601-0463	SP2601-0463	29487-0100	29487-0100	29475-0000	29475-0000	29484-2000	
29480-2001C	UK	Ø 20	1/8" BSP		SK405-0001	29476-0000	18653-0001	SP2701-1006	X3004-095G	10818	SP1002-02	SP2701-1006	SP2601-0463	SP2601-0463	29497-0000	29497-0000	29475-0000	29475-0000	29494-2000	
29500	UK	Ø 40	Ø 28 Hose		SK384-0001	3298	1210-0001	SP2700-1027	SP1002-02	490	SP1003-01	SP2700-1027	SP2601-0451	SP2601-0451	29508-0000	29508-0000	3992	3992	29504-1000	
29500-1101	UK	Ø 40	Ø 28 Hose		SK384-0001	3298	1210-0001	SP2700-1027	SP1002-02	490	SP1003-01	SP2700-1027	SP2601-0451	SP2601-0451	29516-0000	29516-0000	3992	3992	29504-1000	
29500-1201	UK	Ø 40	Ø 28 Hose		SK384-0001	3298	1210-0001	SP2700-1027	SP1002-02	490	SP1003-01	SP2700-1027	SP2601-0451	SP2601-0451	29518-0000	29518-0000	3992	3992	29504-1000	
29500-1251	UK	Ø 40	Ø 28 Hose		SK384-0001	3298	1210-0001	SP2700-1027	SP1002-02	10336	SP1003-09	SP2700-1027	SP2601-0451	SP2601-0451	29518-0000	29518-0000	3992	3992	29504-1000	
29500-1501	UK	Ø 40	Ø 28 Hose		SK384-0001	3298	1210-0001	SP2700-1027	SP1002-02	10336	SP1003-09	SP2700-1027	SP2601-0451	SP2601-0451	29518-0000	29518-0000	3992	3992	29504-1000	
29500-1901	UK	Ø 40	Ø 28 Hose		SK384-0001	3298	1210-0001	SP2700-1027	SP1002-02	10336	SP1003-09	SP2700-1027	SP2601-0451	SP2601-0451	29518-0000	29518-0000	3992	3992	29504-1000	
29500-1401	UK	Ø 40	Ø 28 Hose		SK384-0001	3298	1210-0001	SP2700-1027	SP1002-02	490	SP1003-01	SP2700-1027	SP2601-0451	SP2601-0451	29503-0000	29503-0000	3992	3992	29504-1000	
29500-1451	UK	Ø 40	Ø 28 Hose		SK384-0001	3298	1210-0001	SP2700-1027	SP1002-02	10336	SP1003-09	SP2700-1027	SP2601-0451	SP2601-0451	29503-0000	29503-0000	3992	3992	29504-1000	
29500-1501	UK	Ø 40	Ø 28 Hose		SK384-0001	3298	1210-0001	SP2700-1027	SP1002-02	490	SP1003-01	SP2700-1027	SP2601-0451	SP2601-0451	29516-0000	29516-0000	3992	3992	29504-1000	
29500-1901	UK	Ø 40	Ø 28 Hose		SK384-0001	3298	1210-0001	SP2700-1027	SP1002-02	490	SP1003-01	SP2700-1027	SP2601-0451	SP2601-0451	29507-0020	29507-0020	3992	3992	29504-1000	
29500-3001	UK	Ø 40	Ø 28 Hose		SK384-0001	3298	1210-0001	SP2700-1027	SP1002-02	490	SP1003-01	SP2700-1027	SP2601-0452	SP2601-0452	29507-0000	29507-0000	3992	3992	29504-1000	
29520-2001	UK	Ø 40	1/8" BSP		SK239	3298	1210-0001	SP2700-1027	SP1002-02	490	SP1003-01	SP2701-21	SP2600-01	SP2600-01	29537-0000	29537-0000	29535-0000	29535-0000	29534-2000	
29530-2001	UK	Ø 40	1/8" BSP		SK239	3298	1210-0001	SP2700-1027	SP1002-02	490	SP1003-01	SP2700-1027	SP2600-025	SP2600-025	29537-0000	29537-0000	29545-1101	29545-1101	29544-1000	
29540-1101	UK	Ø 40	Ø 32 Hose		SK385-0101	3298	1210-0001	SP2700-1027	SP1003-0111	490	SP1003-01	SP2700-1027	SP2601-0451	SP2601-0451	29547-0100	29547-0100	29545-1201	29545-1201	29544-1000	
29540-1201	UK	Ø 40	Ø 32 Hose		SK385-0101	3298	1210-0001	SP2700-1027	SP1003-0111	490	SP1003-01	SP2700-1027	SP2601-0451	SP2601-0451	29547-0100	29547-0100	29545-1201	29545-1201	29544-1000	
29540-1301	UK	Ø 40	Ø 32 Hose		SK385-0101	3298	1210-0001	SP2700-1027	SP1003-0111	490	SP1003-01	SP2700-1027	SP2601-0451	SP2601-0451	29547-0100	29547-0100	29545-1201	29545-1201	29544-1000	
29600-1001	UK	Ø 80	Ø 32 Hose		SK385-0101	890	17937-0001	SP6080-0469	SP1003-0111	934	SP1004-09	SP2700-1027	SP2600-0500	SP2600-0500	29607-0000	29607-0000	3993	3993	29604-1000	
29600-1101	UK	Ø 80	Ø 32 Hose		SK385-0101	890	17937-0001	SP6080-0469	SP1003-0111	934	SP1004-09	SP2700-1027	SP2600-0500	SP2600-0500	29606-0000	29606-0000	3993	3993	29604-1000	
29600-1201	UK	Ø 80	Ø 32 Hose		SK385-0101	890	17937-0001	SP6080-0469	SP1003-0111	934	SP1004-09	SP2700-1027	SP2600-0500	SP2600-0500	29608-0000	29608-0000	3993	3993	29604-1200	
29600-1641	UK	Ø 80	Ø 32 Hose		SK385-0601	890	920-0001	SP6080-0469	SP1003-0111	3255	SP1004-11	SP2700-1027	SP2600-0500	SP2600-0500	29609-0000	29609-0000	3993	3993	29604-1300	
29600-1741	UK	Ø 80	Ø 32 Hose		SK385-0601	890	920-0001	SP6080-0469	SP1003-0111	3255	SP1004-11	SP2700-1027	SP2600-0500	SP2600-0500	29606-0200	29606-0200	3993	3993	29604-1300	
29620-2001	UK	Ø 80	1" BSP		SK229	890	17937-0001	22617-0010	SP1003-0111	934	SP1004-09	SP6080-0469	SP2600-0500	SP2600-0500	29606-0100	29606-0100	3993	3993	29604-1300	
29630-1001	UK	Ø 80	Ø 32 Hose		SK385-0601	890	920-0001	SP6080-0469	SP1003-0111	934	SP1004-09	SP2700-1027	SP2601-0468	SP2601-0468	29637-0000	29637-0000	3993	3993	10329-200	
29630-1101	UK	Ø 80	Ø 32 Hose		SK385-0601	890	920-0001	SP6080-0469	X5258-013	934	SP1004-11	SP2700-1027	SP2601-0468	SP2601-0468	29637-0000	29637-0000	3993	3993	29634-1000	
29630-1141	UK	Ø 80	Ø 32 Hose		SK385-0601	890	920-0001	SP6080-0469	X5258-013	3255	SP1004-09	SP2700-1027	SP2601-0468	SP2601-0468	29637-0000	29637-0000	3993	3993	29634-1101	
29640-1001	UK	Ø 80	Ø 32 Hose		SK385-0101	890	17937-0001	SP6080-0469	SP1003-0111	934	SP1004-09	SP2700-1027	SP2600-0500	SP2600-0500	29647-0000	29647-0000	3993	3993	29604-1000	
29640-1101	UK	Ø 80	Ø 32 Hose		SK385-0101	890	17937-0001	SP6080-0469	SP1003-0111	934	SP1004-09	SP2700-1027	SP2600-0500	SP2600-0500	29647-0000	29647-0000	3993	3993	29604-1300	
29700-1101	UK	120	Ø 45 Hose		SK386-0001	890	17018-0001	SP6080-0469	SP1003-0111	23341-0000	SP1004-09	SP2701-0903	SP2600-11	SP2600-11	29707-0000	29707-0000	3993	3993	29704-1200	
29700-1201	UK	120	Ø 45 Hose		SK386-0001	890	17018-0001	SP6080-0469	SP1003-0111	23341-0000	SP1004-09	SP2701-0903	SP2600-11	SP2600-11	29708-0000	29708-0000	3993	3993	29704-1200	
29700-1301	UK	120	Ø 45 Hose		SK386-0001	890	17018-0001	SP6080-0469	SP1003-0111	23341-8000	SP1004-09	SP2701-0903	SP2600-11	SP2600-11	29707-0000	29707-0000	3993	3993	29704-1300	

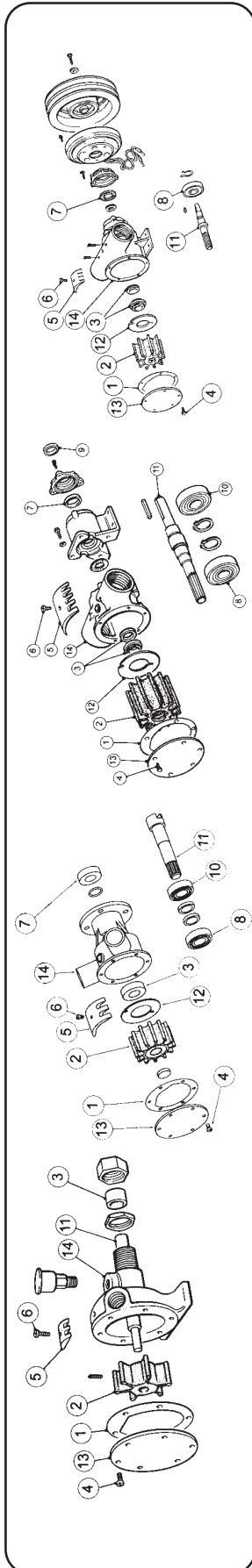

Service Parts - Flexible Impeller Pumps Spares by Pump Model 29480-2031 to 29700-1301

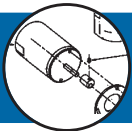

10

www.jabasco.com

JABSCO

Service Parts - Flexible Impeller Pumps Spares by Pump Model 29700-1331 to 50880-2201

JABSCO PUMP DETAILS				SERVICE KIT DETAILS				GENERAL PARTS LISTING													
Pump Number	Origin	Pump Size	Port Type	Mount Type	Obsolete	Alternate Part No	Kit Number	Gasket/O Ring	Impeller	Water Seal	End Cover Screws	Cam	Cam Screw	Pump End Oil Seal	Pump End Bearing	Drive End Oil Seal	Drive End Bearing	Shaft	Wearplate	Endcover	Body
							Key	1	2	3	4	5	6	7	8	9	10	11	12	13	14
29700-1331	UK	120	Ø 45 Hose	Flange			SK386-0001	890	17018-0001	SP6080-0469	SP1003-0111	23342-0000	SP1004-09	SP2701-0903	SP2600-11	---	SP2600-11	29707-0000	4156	3993	29704-1300
29700-1401	UK	120	Ø 45 Hose	Flange			SK386-0001	890	17018-0001	SP6080-0469	SP1003-0111	23341-0000	SP1004-09	SP2701-0903	SP2600-11	---	SP2600-11	29708-0100	4156	3993	29704-1400
29750-1001	UK	200	Ø 38 Hose	Foot			SK386-0001	836-0001	X4020-399A	29752-0000	X5255-002	29752-0000	SP1005-04	SP2701-1014	SP2600-11	---	SP2600-11	29757-0000	2574	29805-0000	29734-1000
29770-0001	UK	200	1/2" Flanged	Flange			SK424-0001	816	17935-0001	21849	SP1095-0640	834	SP1005-04	SP2700-0050	SP2600-32	---	---	21239-0020	2574	9336	10634
29800-1001	UK	270	Ø 51 Hose	Foot			SK424-0001	890	6760-0001	21849	X5255-002	29802-0000	SP1005-04	SP2701-1014	SP2600-11	---	---	29807-0000	2574	29805-0000	29804-1000
29830-0001	UK	300	57mm Flanged	Flange			SK424-0001	890	X4020-399A	17938-0111*	X3001-176F	29838-0000	X3001-205F	SP2701-54	SP2601-37	---	---	29827-0100	2574	29825-0000	29834-0000*
29830-0101	UK	300	57mm Flanged	Flange			SK424-0001	890	X4020-399A	17938-0111*	X3001-176F	29838-0000	X3001-205F	SP2701-54	SP2601-37	---	---	29827-0100	2574	29825-0000	29834-0000*
29850-0031	UK	370	2 1/2" Flanged	Flange	x	29880-0001	SK410	X4020-424A	17240-0001	21849	SP1094-0060	23342-0000	SP1004-09	SP2701-54	SP2601-0469	---	---	29857-0000	18787-6000	18784-1000	18783-0000
29860-2001	UK	470	2 1/2" Flanged	Foot			SK410	X4020-424A	17240-0001	21849	X5255-002	29862-0200	X3001-207F	SP2701-54	SP2601-0458	---	---	29867-0000	29866-0000	29865-0000	29864-2000
29860-2101	UK	470	2 1/2" Flanged	Foot			SK410	X4020-424A	17240-0001	21849	X5255-002	29862-0200	X3001-207F	SP2701-54	SP2601-0458	---	---	29867-0000	29866-0000	29865-0000	29864-2000
29870-2001	UK	470	2 1/2" Flanged	Foot			SK410	X4020-424A	17240-0001	21849	X5255-002	29862-0200	X3001-207F	SP2701-54	SP2601-0458	---	---	29867-0000	29866-0000	29865-0000	29864-2000
29880-0001	UK	470	2 1/2" Flanged	Flange			SK410	X4020-424A	17240-0001	21849	X3001-180F	29862-0100	X3001-207F	SP2701-54	SP2601-0469	---	---	29887-0100	29886-0000	29885-0000	29884-0000
29880-0101	UK	470	2 1/2" Flanged	Flange			SK410	X4020-424A	17240-0001	21849	X3001-180F	29862-0100	X3001-207F	SP2701-54	SP2601-0469	---	---	29887-0100	29886-0000	29885-0000	29884-0000
29880-0201	UK	470	2 1/2" Flanged	Flange			SK410	X4020-424A	17240-0001	21849	X3001-180F	29862-0100	X3001-207F	SP2701-54	SP2601-0469	---	---	29887-0100	29886-0000	29885-0000	29884-0000
29890-0001	UK	470	2 1/2" Flanged	Flange			SK410	X4020-424A	17240-0001	21849	X3001-180F	29862-0100	X3001-207F	SP2701-54	SP2601-0469	---	---	29887-0100	29886-0000	29885-0000	29884-0000
30190-0000	USA	130	1 1/2" Flanged	Flange			SK410	92000-0560	30919-0001	18753-0342	18753-0495	30192-0000	---	---	18753-0521	18753-0522	18753-0521	Proprietary	30193	30914-1000	Proprietary
30190-0001	USA	130	1 1/2" Flanged	Flange			SK410	92000-0560	30919-0001	18753-0342	18753-0495	30192-0000	---	---	18753-0521	18753-0522	18753-0521	Proprietary	30193	30914-1000	Proprietary
30410-9001	USA	040	1 1/2" NPT	Flange			SK410	18753-0133	1210-0001	96080-0080	18753-0495	30929-1000	18753-0495	---	---	18753-0469	18753-0521	30903-1000	30915-1000	30914-1000	30901-1000
30890-0001	USA	130	2" Hose	Flange			SK410	18753-0343	30919-0001	18753-0342	18753-0495	30929-1000	18753-0495	---	---	18753-0521	18753-0521	30903-1000	30915-1000	30914-1000	30901-1000
30890-0051	USA	130	2" Hose	Flange			SK410	18753-0343	30919-0001	18753-0342	18753-0495	30929-1000	18753-0495	---	---	18753-0521	18753-0521	30903-1000	30915-1000	30914-1000	30901-1000
30891-0001	USA	130	2" Hose	Flange			SK410	18753-0343	30919-0001	18753-0342	18753-0495	30929-1000	18753-0495	---	---	18753-0521	18753-0521	30903-1000	30915-1000	30914-1000	30901-1000
30891-0002	USA	130	2" Hose	Flange			SK410	18753-0343	30919-0001	18753-0342	18753-0495	30929-1000	18753-0495	---	---	18753-0521	18753-0521	30903-1000	30915-1000	30914-1000	30901-1000
30892-0001	USA	130	2" Hose	Flange			SK410	18753-0343	30919-0001	18753-0342	18753-0495	30929-1000	18753-0495	---	---	18753-0521	18753-0521	30903-1000	30915-1000	30914-1000	30901-1000
30910-0000	USA	130	2" Hose	Foot			SK410	18753-0343	30919-0001	18753-0342	18753-0495	30929-1000	18753-0495	---	---	18753-0521	18753-0521	30903-1000	30915-1000	30914-1000	30901-1000
30940-0001	USA	130	2" Hose	Foot			SK410	18753-0343	30919-0001	18753-0342	18753-0495	30929-1000	18753-0495	---	---	18753-0521	18753-0521	30903-1000	30915-1000	30914-1000	30901-1000
30940-0011	USA	130	2" Hose	Foot			SK410	18753-0343	30919-0001	18753-0342	18753-0495	30929-1000	18753-0495	---	---	18753-0521	18753-0521	30903-1000	30915-1000	30914-1000	30901-1000
42730-0000	USA	120	1" NPT	Foot			SK410	18753-0330	18948-0001	96080-0080	18753-0332	42737-1000	18753-0332	---	---	---	---	42739-1000	4156-0000	42738-1000	42734-1000
43210-0001	USA	080	1 1/4" Hose	Flange			SK410	90196-0001	17954-0001	18753-0328	18753-0314	43176-1000	---	---	---	---	---	18753-0318	43207-1000	43176-1000	43209-1000
43210-0001	USA	040	1" Hose	Flange			SK410	90196-0001	17954-0001	18753-0328	18753-0314	43176-1000	---	---	---	---	---	18753-0318	43207-1000	43176-1000	43209-1000
Dual							SK410	90196-0001	17954-0001	18753-0328	18753-0314	43176-1000	---	---	---	---	---	18753-0318	43207-1000	43176-1000	43209-1000
47070-2001	UK	070	1/2" BSP	Foot	x		SK410	X4020-369F	31070-0051	SP6080-0469	X3001-178F	47072-0000	X3004-074F	SP2700-1027	SP2600-12	---	---	47077-0000	4156	47075-0000	47074-2000
47100-2001	UK	100	1" BSP	Foot	x		SK410	X4020-389A	31100-0061	X5280-008	X3001-178F	47102-0000	X3001-178F	X5280-009	SP2601-0468	---	---	47107-0000	47106-0000	47105-0000	47104-2000
47300-2001	UK	300	2" BSP	Foot	x		SK410	X4020-399A	31300-0051	21849	X3001-178F	47302-0000	X3001-205F	SP2701-54	SP2601-0458	---	---	47307-0000	47306-0000	47305-0000	47304-2000
50080-2001	UK	080	1" BSP	Foot			SK406-0001	890	17937-0001	SP2700-1027	X3001-147F	934	SP1004-09	SP2700-48	SP2600-06	---	---	50087-0000	4156	3993	50084-2000
50080-2003	UK	080	1" BSP	Foot			SK406-0003	890	17937-0003	SP2700-1027	X3001-147F	934	SP1004-09	SP2700-48	SP2600-06	---	---	50087-0000	4156	3993	50084-2000
50080-2101	UK	080	1" BSP	Foot			SK406-0001	890	17937-0001	SP2700-1027	X3001-147F	934	SP1004-09	SP2700-48	SP2600-06	---	---	50087-0000	4156	3993	50084-2000
50080-2103	UK	080	1" BSP	Foot			SK406-0003	890	17937-0003	SP2700-1027	X3001-147F	934	SP1004-09	SP2700-48	SP2600-06	---	---	50087-0000	4156	3993	50084-2000
50880-2201	UK	080	1" BSP	Foot			SK406-0001	890	17937-0001	SP2700-1027	X3001-147F	934	SP1004-09	SP2700-48	SP2600-06	---	---	50087-0000	4156	3993	50884-2000

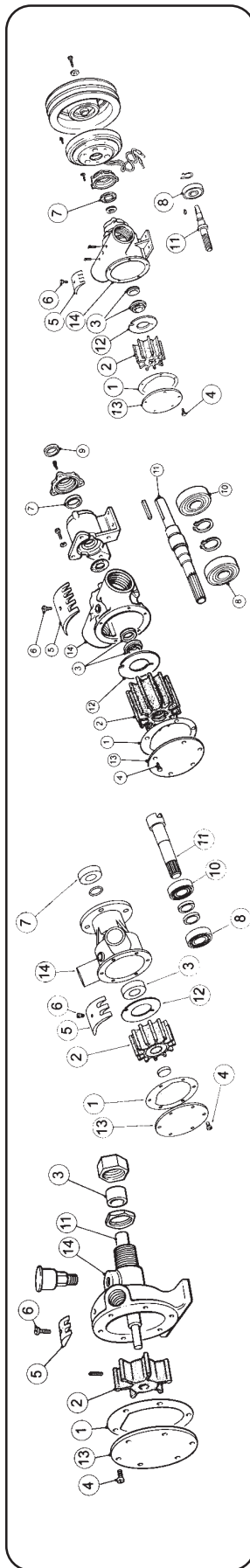

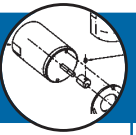

JABSCO PUMP DETAILS				SERVICE KIT DETAILS				GENERAL PARTS LISTING												
Pump Number	Origin Pump Size	Port Type	Mount Type	Alternate Part No	Kit Number	Gasket/O Ring	Impeller	Water Seal	End Cover Screws	Cam	Cam Screw	Pump End Oil Seal	Pump End Bearing	Drive End Oil Seal	Drive End Bearing	Shaft	Wearplate	Endcover	Body	
					Key															* OEM supply only
50080-2203	UK	080	1" BSP		SK406-0003	890	17937-0001	SP2700-1027	X3001-147F	934	SP1004-09	SP2700-48	SP2600-06	---	50087-0000	4156	3993	50084-2000		
50080-2301	UK	080	1" BSP		SK406-0001	890	17937-0001	SP2700-1027	X3001-147F	934	SP1004-09	SP2700-48	SP2600-06	---	50087-0000	4156	3993	50084-2000		
50080-2303	UK	080	1" BSP		SK406-0003	890	17937-0001	SP2700-1027	X3001-147F	934	SP1004-09	SP2700-48	SP2600-06	---	50087-0000	4156	3993	50084-2000		
50080-2321	UK	080	1" BSP		SK406-0001	890	17937-0001	SP2700-1027	X3001-147F	934	SP1004-09	SP2700-48	SP2600-06	---	50087-0000	4156	3993	50084-2000		
50080-2903	UK	080	1" BSP		SK406-0003	890	17937-0001	SP2700-1027	X3001-147F	934	SP1004-09	SP2700-48	SP2600-06	---	50087-0000	4156	3993	50084-2000		
50190-1001	UK	040	Ø 32 Hose		SK407-0003	3298	1210-0001	SP2700-1027	X3001-095F	490	SP1003-01	SP2700-50	SP2600-04	---	50197-0000	2574	3992	50194-1000		
50200-2003	UK	200	1 1/2" BSP		SK407-0001	816	17935-0001	21849	X3001-176F	834	SP1005-04	SP2700-50	SP2600-04	---	50207-0000	2574	9336	50204-2000		
50200-2011	UK	200	1 1/2" BSP		SK407-0011	816	17935-0001	21849	X3001-176F	834	SP1005-04	SP2700-50	SP2600-04	---	50207-0000	2574	9336	50204-2000		
50200-2103	UK	200	1 1/2" BSP		SK407-0003	816	836-0003	21849	X3001-176F	834	SP1005-04	SP2700-50	SP2600-04	---	50207-0000	2574	9336	50204-2000		
50200-2111	UK	200	1 1/2" BSP		SK407-0001	816	17935-0001	21849	X3001-176F	834	SP1005-04	SP2700-50	SP2600-04	---	50207-0000	2574	9336	50204-2000		
50200-2203	UK	200	1 1/2" BSP		SK407-0003	816	836-0003	21849	X3001-176F	834	SP1005-04	SP2700-50	SP2600-04	---	50207-0000	2574	9336	50204-2000		
50200-2211	UK	200	1 1/2" BSP		SK407-0011	816	17935-0001	21849	X3001-176F	834	SP1005-04	SP2700-50	SP2600-04	---	50207-0000	2574	9336	50204-2000		
50200-2303	UK	200	1 1/2" BSP		SK407-0003	816	836-0003	21849	X3001-176F	834	SP1005-04	SP2700-50	SP2600-04	---	50207-0000	2574	9336	50204-2000		
50200-2311	UK	200	1 1/2" BSP		SK407-0001	816	17935-0001	21849	X3001-176F	834	SP1005-04	SP2700-50	SP2600-04	---	50207-0000	2574	9336	50204-2000		
50200-2903	UK	200	1 1/2" BSP		SK407-0003	816	836-0003	21849	X3001-176F	834	SP1005-04	SP2700-50	SP2600-04	---	50207-0000	2574	9336	50204-2000		
50200-9203	UK	200	1 1/2" BSP		SK407-0003	816	836-0003	21849	X3001-176F	834	SP1005-04	SP2700-50	SP2600-04	---	50207-0000	2574	9336	50204-2000		
50200-9303	UK	200	1 1/2" BSP		SK407-0001	816	17935-0001	21849	X3001-176F	834	SP1005-04	SP2700-50	SP2600-04	---	50207-0000	2574	9336	50204-2000		
50200-9403	UK	200	1 1/2" BSP		SK407-0003	816	836-0003	21849	X3001-176F	834	SP1005-04	SP2700-50	SP2600-04	---	50207-0000	2574	9336	50204-2000		
50210-1001	UK	080	Clamp			890	17937-0001	SP2700-1027	X3001-147F	934	SP1004-09	---	SP2600-0500	---	50217-0000	4156	3993	50214-2000		
50210-1101	UK	080	Clamp			X4020-269A	17937-0001	SP2700-1027	X3001-147F	53082-0000	X3004-174F	---	SP2600-0500	---	50217-0200	4156	50215-0000	50214-1100		
50220-0111	UK	200	1 1/2" Flanged		SK407-0011	816	17935-0001	21849	SP1095-0640	834	SP1005-04	SP2701-54	SP2601-0458	---	50227-0000	2574	9336	10634-02		
50220-0211	UK	200	1 1/2" Flanged		SK407-0011	816	17935-0001	21849	SP1095-0640	834	SP1005-04	SP2701-54	SP2601-0458	---	50227-0000	2574	9336	10634-02		
50220-0311	UK	200	1 1/2" Flanged		SK407-0003	816	836-0003	21849	SP1095-0640	834	SP1005-04	SP2701-54	SP2601-0458	---	50227-0000	2574	9336	10634-02		
50220-0903	UK	200	1 1/2" Flanged		SK407-0003	816	836-0003	21849	SP1095-0640	834	SP1005-04	SP2701-54	SP2601-0458	---	50227-0000	2574	9336	10634-02		
50230-0311	UK	200	1 1/2" Flanged		SK407-0011	816	17935-0001	21849	SP1095-0640	834	SP1005-04	SP2701-54	SP2601-0458	---	50227-0000	2574	9336	10584		
50260-2041	UK	080	1" BSP		SK385-0001	890	17937-0001	SP2700-1027	SP1003-0111	3255	SP1004-11	SP2700-1027	SP2600-01	---	50260-0000	4156	3993	50264-2000		
50270-0011	UK	270	2" Flanged		SK408-0011	816	17936-0001	21849	SP1095-0640	6988	SP1005-04	SP2701-54	SP2601-0458	---	50227-0000	2574	9336	10634-02		
50270-0111	UK	270	2" Flanged		SK408-0011	816	17936-0001	21849	SP1095-0640	6988	SP1005-04	SP2701-54	SP2601-0458	---	50227-0000	2574	9336	10634-02		
50270-0211	UK	270	2" Flanged		SK408-0011	816	17936-0001	21849	SP1095-0640	6988	SP1005-04	SP2701-54	SP2601-0458	---	50227-0000	2574	9336	10634-02		
50270-0311	UK	270	2" Flanged		SK408-0011	816	17936-0001	21849	SP1095-0640	6988	SP1005-04	SP2701-54	SP2601-0458	---	50227-0000	2574	9336	10634-02		
50270-0911	UK	270	2" Flanged		SK408-0011	816	17936-0001	21849	SP1095-0640	6988	SP1005-04	SP2701-54	SP2601-0458	---	50227-0000	2574	9336	10634-02		
50270-0913	UK	270	2" Flanged		SK408-0013	816	6760-0003	21849	SP1095-0640	6988	SP1005-04	SP2701-54	SP2601-0458	---	50227-0000	2574	9336	10634-02		
50270-2011	UK	270	2" BSP		SK408-0011	816	17936-0001	21849	SP1095-0640	6988	SP1005-04	SP2701-54	SP2601-0458	---	50227-0000	2574	9336	10634-02		
50270-2111	UK	270	2" BSP		SK408-0011	816	17936-0001	21849	SP1095-0640	6988	SP1005-04	SP2701-54	SP2601-0458	---	50227-0000	2574	9336	10634-02		
50270-2211	UK	270	2" BSP		SK408-0011	816	17936-0001	21849	SP1095-0640	6988	SP1005-04	SP2701-54	SP2601-0458	---	50227-0000	2574	9336	10634-02		
50270-2311	UK	270	2" BSP		SK408-0011	816	17936-0001	21849	SP1095-0640	6988	SP1005-04	SP2701-54	SP2601-0458	---	50227-0000	2574	9336	10634-02		
50270-2313	UK	270	2" BSP		SK408-0013	816	6760-0003	21849	SP1095-0640	6988	SP1005-04	SP2701-54	SP2601-0458	---	50227-0000	2574	9336	10634-02		
50270-2911	UK	270	2" BSP		SK408-0011	816	17936-0001	21849	SP1095-0640	6988	SP1005-04	SP2701-54	SP2601-0458	---	50227-0000	2574	9336	10634-02		
50270-2913	UK	270	2" BSP		SK408-0013	816	6760-0003	21849	SP1095-0640	6988	SP1005-04	SP2701-54	SP2601-0458	---	50227-0000	2574	9336	10634-02		

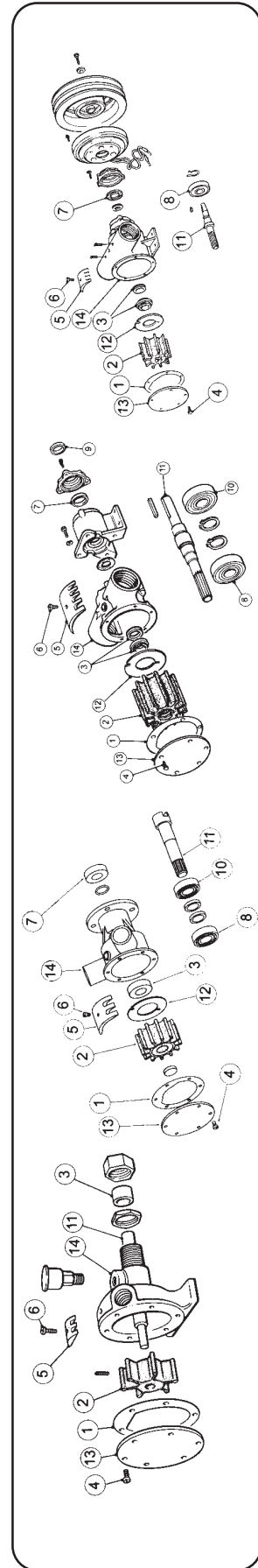

Service Parts - Flexible Impeller Pumps Spares by Pump Model 50080-2203 to 50270-2913

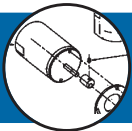

10

www.jabsco.com

JABSCO

Service Parts - Flexible Impeller Pumps Spares by Pump Model 50280-2001 to J52080-2021

JABSCO PUMP DETAILS				SERVICE KIT DETAILS				GENERAL PARTS LISTING														
Pump Number	Origin	Pump Size	Port Type	Mount Type	Alternate Part No	Kit Number	Key	Gasket/O Ring	Impeller	Water Seal	End Cover Screws	Cam	Cam Screw	Pump End Oil Seal	Pump End Bearing	Drive End Oil Seal	Drive End Bearing	Shaft	Wearplate	Endcover	Body	
									*Data supply only													*Data supply only
50280-2001	UK	040	1/4" BSP	Flange		SK271		3298	1210-0001	SP2701-21	SP1002-02	7876	SP1003-01	SP2701-21	SP2601-07	---	---	3277	7883	3992	3274-200	
50280-2101	UK	040	1/4" BSP	Flange		SK271		3298	1210-0001	SP2701-21	SP1002-02	7876	SP1003-01	SP2601-07	---	---	---	3277	7883	3992	3274-200	
50310-1001	UK	080	3/32 Hose	Flange		SK271		X4020-354A	SP6080-0469	X3001-209F	X3001-209F	934	SP1004-09	SP2600-0500	SP2600-0500	---	---	5037-0000	4156	3993	29604-1700	
50310-1101	UK	080	3/32 Hose	Flange		SK271		X4020-354A	SP6080-0469	SP1003-0111	SP1003-0111	934	SP1004-09	SP2600-0500	SP2600-0500	---	---	29609-0100	4156	3993	29604-1300	
50320-1251	UK	080	3/32 Hose	Flange		SK271		X4020-354A	SP6080-0469	SP1003-0111	SP1003-0111	2431	SP1004-09	SP2600-0500	SP2600-0500	---	---	29609-0200	4156	3993	29604-1300	
50320-2001	UK	080	1" BSP	Flange		SK271		890	17937-0001	SP2700-1027	X3001-147F	934	SP1004-09	SP2600-12	SP2600-12	---	---	5032-0000	Not Fitted	3993	50324-2000	
50340-1001	UK	040	1/2" BSP	Flange		SK384-0001		3298	1210-0001	SP2700-1027	X3004-0956	490	SP1003-01	SP2601-0451	SP2601-0451	---	---	5034-0000	7883	3992	50344-1000	
50350-1001	UK	120	4/5 Hose	Flange		SK384-0001		X4020-269A	SP6080-0469	X3001-176F	X3001-176F	23341-0001	SP1004-09	SP2700-1027	SP2600-11	---	---	5035-0000	4156	50355-0000	50354-1000	
50360-1001	UK	040	2/8 Hose	Flange		SK384-0001		X4020-259A	SP6080-0469	X3001-147F	X3001-147F	490-0100	SP1003-01	SP2601-0451	SP2601-0451	---	---	5036-0000	7883	23825-0000	50364-1000	
50370-1001	UK	040	2/8 Hose	Flange		SK384-0001		X4020-259A	SP6080-0469	X3001-147F	X3001-147F	23826-0000	SP1003-01	SP2601-0451	SP2601-0451	---	---	5037-0000	7883	23825-0000	50374-1000	
50400-1001	UK	040	2/8 Hose	Flange		SK384-0001		3298	1210-0001	SP2700-1027	SP1002-02	490	SP1003-01	SP2601-0451	SP2601-0451	---	---	5040-0000	7883	3992	29504-1200	
51080-2001	UK	080	1" BSP	Foot		SK406-0001		890	17937-0001	SP2700-1027	X3001-147F	934	SP1004-09	SP2600-06	SP2600-06	---	---	5108-0000	4156	3993	50084-2100	
51080-2003	UK	080	1" BSP	Foot		SK406-0003		890	17937-0003	SP2700-1027	X3001-147F	934	SP1004-09	SP2600-06	SP2600-06	---	---	5108-0000	4156	3993	50084-2100	
51080-2041	UK	080	1" BSP	Foot		SK406-0001		890	17937-0001	SP2700-1027	X3001-147F	934	SP1004-09	SP2600-06	SP2600-06	---	---	5108-0000	4156	3993	50084-2100	
51080-9013	UK	080	1" NPT	Foot		SK406-0013		890	920-0003	SP2700-1027	X3001-147F	834	SP1004-09	SP2600-06	SP2600-06	---	---	5108-0000	4156	3993	50084-9100	
51200-2003	UK	200	1 1/2" BSP	Foot	Blige Option	SK407-0003		816	836-0003	21849	X3001-176F	834	SP1005-04	SP2600-04	SP2600-04	---	---	5120-0000	2574	9336	50204-2100	
51200-2011	UK	200	1 1/2" BSP	Foot	Blige Option	SK407-0011		816	17935-0001	21849	X3001-176F	834	SP1005-04	SP2600-04	SP2600-04	---	---	5120-0000	2574	9336	50204-2100	
51200-9013	UK	200	1 1/2" NPT	Foot		SK407-0011		816	836-0003	21849	X3001-176F	834	SP1005-04	SP2600-04	SP2600-04	---	---	5120-0000	2574	9336	50204-9100	
51220-0011	UK	200	1 1/2" Flanged	Foot		SK407-0011		816	17935-0001	21849	X3001-176F	834	SP1005-04	SP2600-04	SP2600-04	---	---	5122-0000	2574	9336	10634	
51270-0011	UK	270	2" Flanged	Foot		SK408-0011		816	21676-0001	21849	X3001-176F	6988	SP1005-04	SP2701-54	SP2601-0458	---	---	5127-0000	2574	9336	50204-2100	
51270-2011	UK	270	2" BSP	Foot		SK408-0011		816	21676-0001	21849	X3001-176F	6988	SP1005-04	SP2701-54	SP2601-0458	---	---	5127-0000	2574	9336	50204-2100	
51270-2013	UK	270	2" BSP	Foot		SK408-0013		816	21676-0003	21849	X3001-176F	6988	SP1005-04	SP2701-54	SP2601-0458	---	---	5127-0000	2574	9336	50204-2100	
51270-9013	UK	270	2" NPT	Foot		SK408-0013		816	6760-0003	21849	X3001-176F	6988	SP1005-04	SP2701-54	SP2601-0458	---	---	5127-0000	2574	9336	50204-2100	
51520-2001	UK	010	1/8" BSP	Foot		SK408-0001		X4020-244A	22405-0001	96080-6024	X3001-095F	Not Fitted	Not Fitted	SP2601-0457	SP2601-0457	---	---	5152-0000	Not Fitted	29905-0100	51514-2000	
51520-2001	UK	020	1/8" BSP	Foot		SK408-0001		X5251-050	653-0001	96080-6024	X3001-147F	Not Fitted	Not Fitted	SP2601-0457	SP2601-0457	---	---	5152-0000	Not Fitted	29905-0100	51514-2000	
52010-0051	UK	010	1/8" NPT	Foot		SK404-0101		29306-0000	22405-0001	SP2701-0501	X3001-095F	29303-0000	SP1009-05	SP2701-1006	SP2601-0457	SP2701-1006	---	---	29306-0000	29306-0000	29305-0000	52014-2000
52010-2001	UK	010	1/8" BSP	Foot		SK404-0101		29306-0000	22405-0001	SP2701-0501	X3001-095F	29303-0000	SP1009-05	SP2701-1006	SP2601-0457	SP2701-1006	---	---	29306-0000	29306-0000	29305-0000	52014-2000
52010-2051	UK	010	1/8" BSP	Foot		SK404-0101		29306-0000	22405-0001	SP2701-0501	X3001-095F	29303-0000	SP1009-05	SP2701-1006	SP2601-0457	SP2701-1006	---	---	29306-0000	29306-0000	29305-0000	52014-2000
52020-2001	UK	020	1/2" BSP	Foot		SK405-0101		2995-0030	18653-0001	SP2701-0501	X3001-095F	2907-0001	SP1002-09	SP2701-1006	SP2601-0457	SP2701-1006	---	---	---	---	3992	52024-2000
52020-2031	UK	020	1/2" NPT	Foot		SK405-0101		2995-0030	18653-0001	SP2701-0501	X3001-095F	2907-0001	SP1002-09	SP2701-1006	SP2601-0457	SP2701-1006	---	---	---	---	3992	52024-2000
52020-2031	UK	020	1/2" BSP	Foot		SK405-0101		2995-0030	18653-0001	SP2701-0501	X3001-095F	2907-0001	SP1002-09	SP2701-1006	SP2601-0457	SP2701-1006	---	---	---	---	3992	52024-2000
52020-2051	UK	020	1/2" BSP	Foot		SK405-0101		2995-0030	18653-0001	SP2701-0501	X3001-095F	2907-0001	SP1002-09	SP2701-1006	SP2601-0457	SP2701-1006	---	---	---	---	3992	52024-2000
52040-2001	UK	040	1/4" BSP	Foot		SK384-0101		3298	1210-0001	SP2701-1015	X3001-095F	490	SP1003-01	SP2601-0451	SP2601-0451	---	---	5204-0000	---	3992	52044-2000	
52040-2003	UK	040	1/4" BSP	Foot		SK384-0101		3298	1210-0003	SP2701-1015	X3001-095F	490	SP1003-01	SP2601-0451	SP2601-0451	---	---	5204-0000	---	3992	52044-2000	
52040-2021	UK	040	1/4" BSP	Foot		SK384-0101		3298	3085-0001	SP2701-1015	X3001-095F	490	SP1003-01	SP2601-0451	SP2601-0451	---	---	5204-0000	---	3992	52044-2000	
52040-2041	UK	040	1/4" BSP	Foot		SK384-0101		3298	1210-0001	SP2701-1015	X3001-095F	490	SP1003-01	SP2601-0451	SP2601-0451	---	---	5204-0000	---	3992	52044-2000	
52051-2051	UK	040	1/4" BSP	Foot		SK384-0101		3298	1210-0001	SP2701-1015	X3001-095F	490	SP1003-01	SP2601-0451	SP2601-0451	---	---	5205-0000	---	3992	52044-2000	
52080-2001	UK	080	1" BSP	Foot		SK406-0001		890	17937-0001	SP2700-1027	X3001-147F	934	SP1004-09	SP2600-06	SP2600-06	---	---	5208-0000	4156	3993	50084-2100	
52080-2003	UK	080	1" BSP	Foot		SK406-0003		890	17937-0003	SP2700-1027	X3001-147F	934	SP1004-09	SP2600-06	SP2600-06	---	---	5208-0000	4156	3993	50084-2100	
52080-2021	UK	080	1" BSP	Foot		SK406-0021		890	5915-0001	SP2700-1027	X3001-147F	934	SP1004-09	SP2600-06	SP2600-06	---	---	5208-0000	4156	3993	50084-2100	

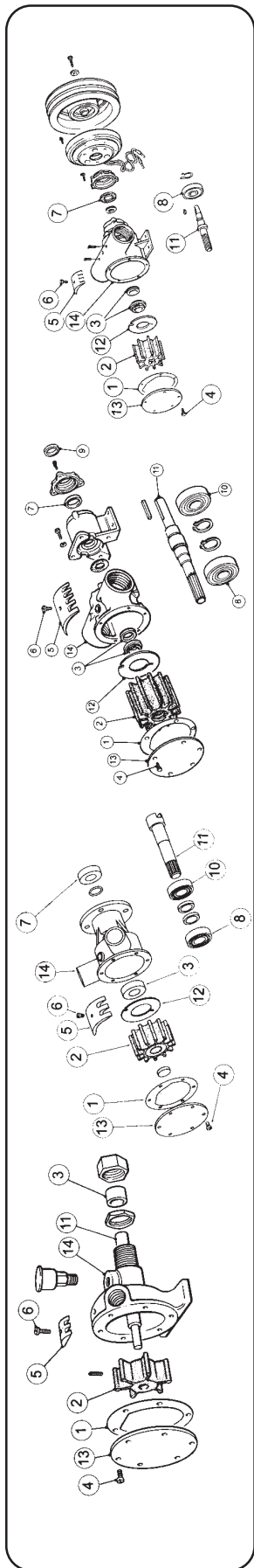

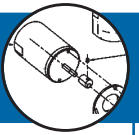

JABSCO PUMP DETAILS				SERVICE KIT DETAILS				GENERAL PARTS LISTING													
Pump Number	Origin	Pump Size	Port Type	Mount Type	Obsolete	Alternate Part No	Kit Number	Gasket/O Ring	Impeller	Water Seal	End Cover Screws	Cam	Cam Screw	Pump End Oil Seal	Pump End Bearing	Drive End Oil Seal	Drive End Bearing	Shaft	Wearplate	Endcover	Body
							Key	1	2	3	4	5	6	7	8	9	10	11	12	13	14
52080-2041	UK	080	1" BSP	Foot	x		SK406-0001	890	17937-0001	SP2700-1027	X3001-147F	2431	SPI004-10	SP2700-48	SP2600-06	SP2700-1027	52087-0000	4156	3993	50084-2100	
52080-2051	UK	080	1" BSP	Foot			SK406-0001	890	17937-0001	SP2700-1027	X3001-147F	934	SPI004-09	SP2700-48	SP2600-06	SP2700-1027	52087-0000	4156	3993	50084-2100	
52080-2101	UK	080	1" BSP	Foot			SK406-0001	890	17937-0001	SP2700-1027	X3003-178F	934	SPI004-09	SP2700-48	SP2600-06	SP2700-1027	52087-0100	4156	3993	50084-2200	
52200-2001	UK	200	1 1/2" BSP	Foot	x	52200-2011	SK407-0011	816	17935-0001	21849	X3001-176F	834	SPI005-04	SP2700-50	SP2600-04	SP2701-1013	52207-0000	2574	9336	50204-2100	
52200-2003	UK	200	1 1/2" BSP	Foot			SK407-0003	816	836-0003	21849	X3001-176F	834	SPI005-04	SP2700-50	SP2600-04	SP2701-1013	52207-0000	2574	9336	50204-2100	
52200-2011	UK	200	1 1/2" BSP	Foot			SK407-0011	816	17935-0001	21849	X3001-176F	834	SPI005-04	SP2700-50	SP2600-04	SP2701-1013	52207-0000	2574	9336	50204-2100	
52200-2041	UK	200	1 1/2" BSP	Foot			SK407-0011	816	17935-0001	21849	X3001-176F	834	SPI005-04	SP2700-50	SP2600-04	SP2701-1013	52207-0000	2574	9336	50204-2100	
52200-2051	UK	200	1 1/2" BSP	Foot			SK407-0011	816	17935-0001	21849	X3001-176F	2551	SPI005-05	SP2700-50	SP2600-04	SP2701-1013	52207-0000	2574	9336	50204-2100	
52220-0011	UK	200	1 1/2" Flanged	Foot			SK407-0011	816	17935-0001	21849	X3001-176F	834	SPI005-04	SP2701-54	SP2601-0458	SP2701-1013	52227-0000	2574	9336	10634	
52220-0041	UK	200	1 1/2" Flanged	Foot			SK407-0011	816	17935-0001	21849	X3001-176F	834	SPI005-04	SP2701-54	SP2601-0458	SP2701-1013	52227-0000	2574	9336	10634	
52220-0051	UK	200	1 1/2" Flanged	Flange			SK407-0011	816	17935-0001	21849	X3001-176F	2551	SPI005-05	SP2701-54	SP2601-0458	SP2701-1013	52227-0000	2574	9336	10634	
52230-0001	UK	200	1 1/2" Flanged	Flange			SK407-0011	816	17935-0001	21849	SPI095-0640	834	SPI005-04	SP2700-50	SP2600-32			21239-0030	2574	9336	10584-03
52270-0011	UK	270	2" Flanged	Foot			SK408-0011	816	17936-0001	21849	SPI095-0640	6988	SPI005-04	SP2701-54	SP2601-0458	SP2701-1013	52277-0000	2574	9336	10494	
52270-2011	UK	270	2" BSP	Foot			SK408-0011	816	17936-0001	21849	X3001-176F	6988	SPI005-04	SP2701-54	SP2601-0458	SP2701-1013	52277-0000	2574	9336	50274-2100	
52270-2013	UK	270	2" BSP	Foot			SK408-0013	816	6760-0003	21849	X3001-176F	6988	SPI005-04	SP2701-54	SP2601-0458	SP2701-1013	52277-0000	2574	9336	50274-2100	
52270-2041	UK	270	2" BSP	Foot			SK408-0011	816	21676-0001	21849	X3001-176F	6988	SPI005-04	SP2701-54	SP2601-0458	SP2701-1013	52277-0000	2574	9336	50274-2100	

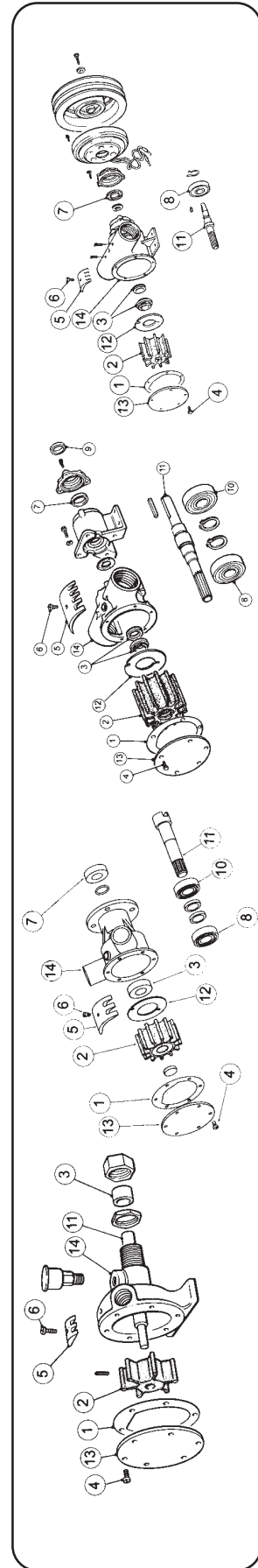

Service Parts - Flexible Impeller Pumps Spares by Pump Model 52080-2041 to 52270-2041